



**THE DATASHEET OF  
GT17HN-4DP-2H(A)**



RoHS, ELV適合品

RoHS, ELV COMPLIANT

△ Note1. The soldering process is allowed up to twice under the same condition. However, the interval between the first and second process must be maintained at the room temperature.

1. リフロー回数: 2回, 但し, 2回目のリフローにおいては, 一度, 室温に戻すこと.

Note2. The temperature indicates the board surface temperature on the connector lead area.

2. リフロー温度の測定は, コネクタリード部の基板表面温度を測定のこと.

Note3. Hand soldering: 280~300℃, 2s max.

3. 手半田温度: 280~300℃, 2S以内

Note4. Coplanarity: 0.1 max.

4. 端子平坦度: 0.1以下

Note5. Recommended thickness of PCB: 1.6mm

5. 推奨基板厚: 1.6mm

RECOMMENDED REFLOW PROFILE

IR reflow condition	IR リフロー条件
Preheating area 150℃ for 60 to 120 seconds	予備加熱: 60~120秒, 150℃
Peak temperature: 230℃	ピーク温度: 230℃
Soldering area 235±5℃ or 10 seconds max.	リフロー温度: 230~240℃, 10秒以内
△230℃ min. for 20-40 seconds	230℃以上: △20~40秒

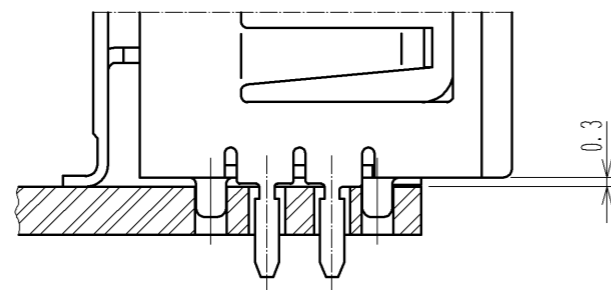
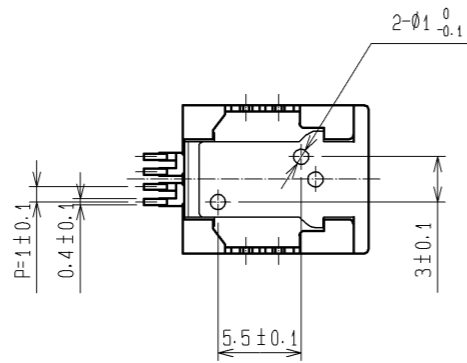
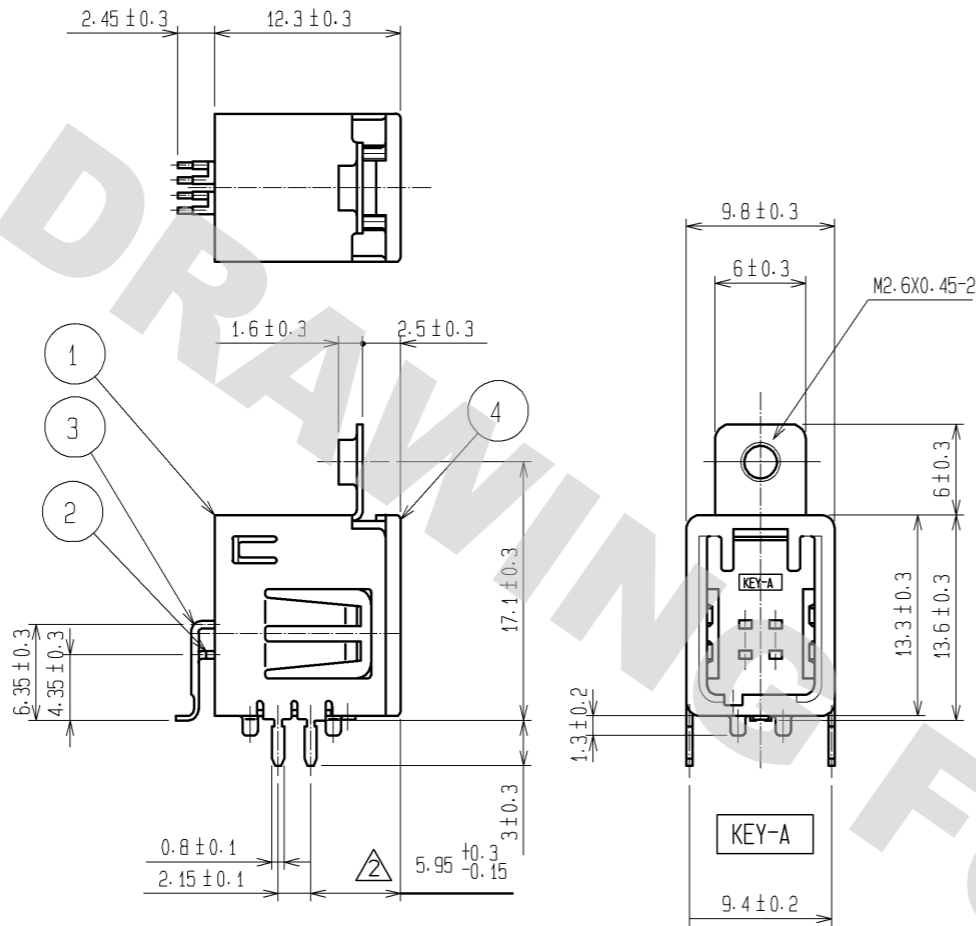
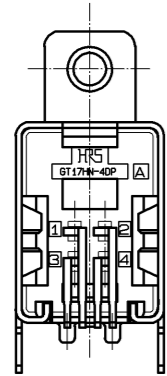
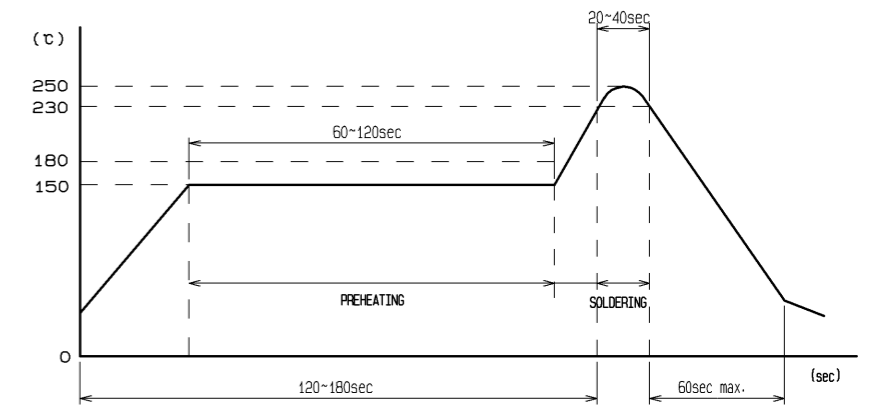

A(4:1)

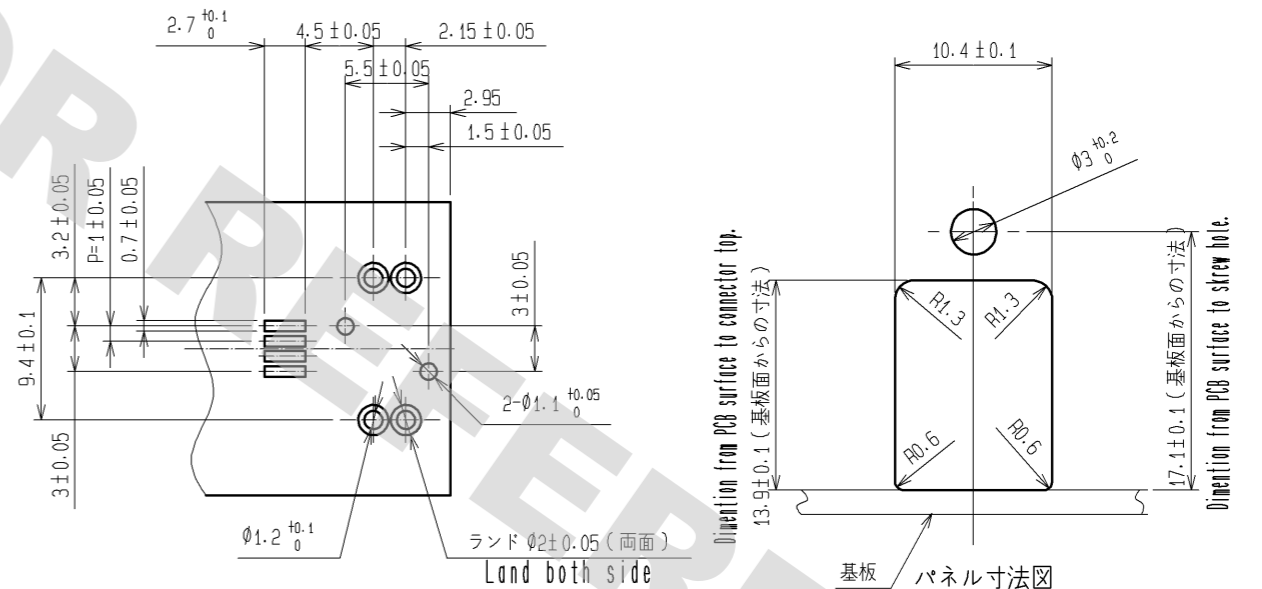

基板推奨寸法図  
Recommended PCB layout

基板 / パネル寸法図  
PCB / Panel layout

2	BRASS	TIN PLATING	5	PS	TRAY NATURAL
1	COPPER ALLOY	TIN PLATING	4	PPS	BROWN
部番	材質	処理, 備考	部番	材質	処理, 備考
UNITS	mm	SCALE	2:1	訂正記事	DIS-T-002095
 HIROSE ELECTRIC CO., LTD.	承認:	KS. SATOH	08.07.08	図番:	EDC3-166813-00
	検 査:	KS. SATOH	08.07.08	製品名:	GT17HN-4DP-2HCA)
	設 計:	NA. HARUBAYASHI	08.07.07	製品	コード
	製 図:	NA. HARUBAYASHI	08.07.07	コード	CL767-0144-6-00
				設計	MH. SHOUJI
				検 査	NH. NAKATA
				年月日	11.01.24

DRAWING FOR REFERENCE. This is subject to change without notice  
08/11/2012

DRAWING FOR REFERENCE: This is subject to change without notice  
08/11/2012

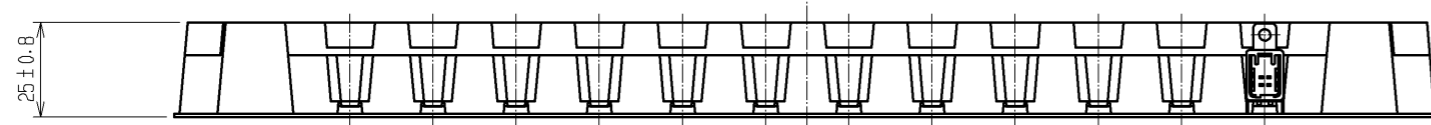
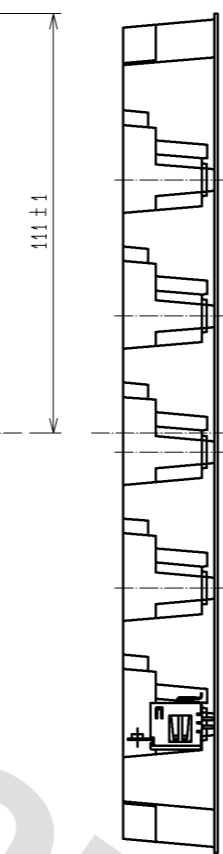
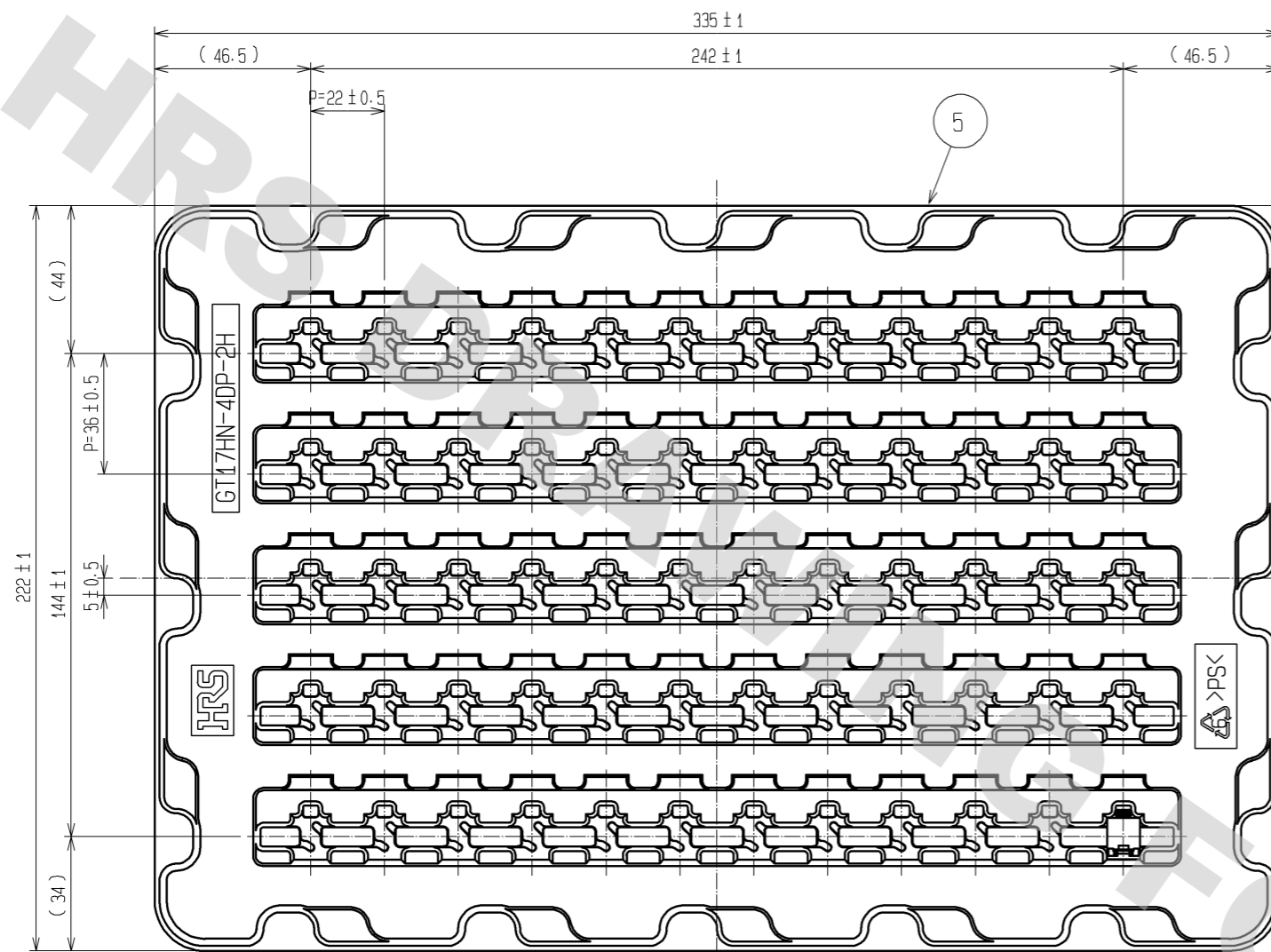

60 PCS / TRAY

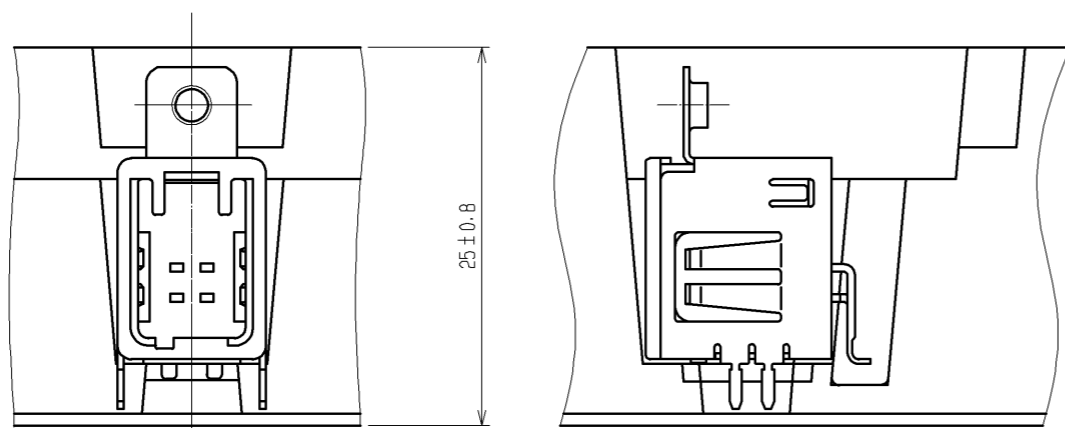

製品格納状態図 (2:1)  
PACKAGING CONDITION

梱包仕様  
W=270・D=360・H=150のサイズのダンボール箱に下図のように製品を入れる。  
PACKAGING STYLE  
BOX SIZE : W=270・D=360・H=150

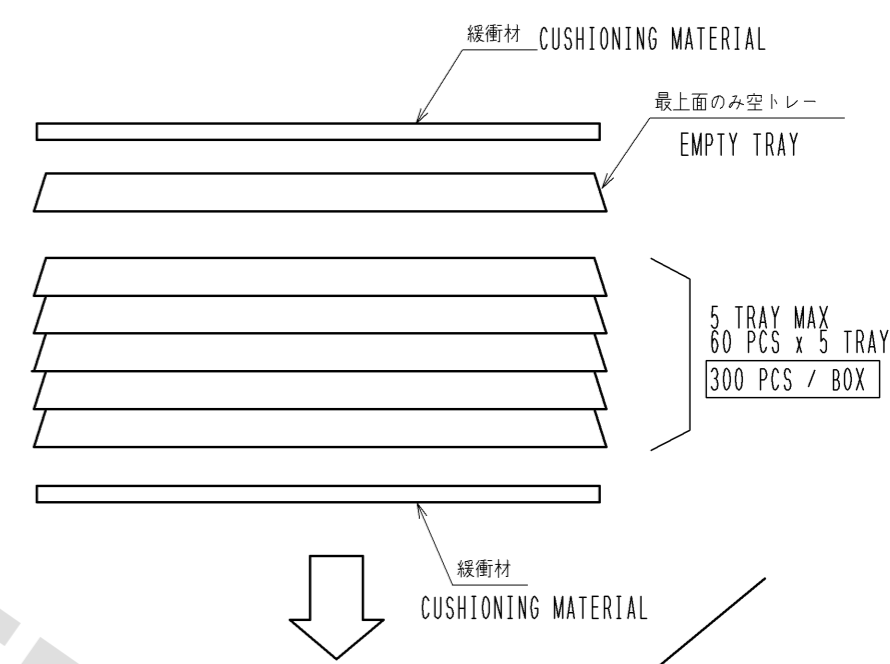

納入先	
品名	
数量	個

<b>HRS</b>	図番:	EDC3-166813-00	3/2
	製品名:	GT17HN-4DP-2H(A)	
	製品コード:	CL767-0144-6-00	

# Mouser Electronics

Authorized Distributor

Click to View Pricing, Inventory, Delivery & Lifecycle Information:

[Hirose Electric:](#)

[GT17HN-4DP-2H\(A\)](#)

## Looking for pricing, stock, or lifecycle information?

Click below to explore more details on WIN SOURCE:

- ⊖ [View GT17HN-4DP-2H\(A\) on WIN SOURCE](#)
- ⊖ [Hirose Electric Co Ltd Information](#)

## Optimize Your Supply Chain with WIN SOURCE Solutions

- ✓ Global Sourcing Solution
- ✓ Obsolete Management
- ✓ Cost Control Management
- ✓ Shortage Management
- ✓ Alternative Solution
- ✓ Excess Inventory Management