



**THE DATASHEET OF
1429040000**



**ModuPlug
HDC MDU**

Weidmüller Interface GmbH & Co. KG
Klingenbergstraße 16
D-32758 Detmold
Germany
Fon: +49 5231 14-0
Fax: +49 5231 14-292083
www.weidmueller.com

**Flexible**

The four module sizes make for individual plug solutions that save a huge amount of space. The smaller pitch translates into an optimised design too.

General ordering data

Type	HDC MDU
Order No.	1429040000
Version	Dummy module
GTIN (EAN)	4050118233421
Qty.	1 pc(s).

**ModuPlug
HDC MDU**

Weidmüller Interface GmbH & Co. KG
 Klingenbergstraße 16
 D-32758 Detmold
 Germany
 Fon: +49 5231 14-0
 Fax: +49 5231 14-292083
 www.weidmueller.com

Technical data**Dimensions and weights**

Width	7.15 mm	Width (inches)	0.281 inch
Height	20.6 mm	Height (inches)	0.811 inch
Depth	34 mm	Depth (inches)	1.339 inch
Net weight	2.62 g		

Temperatures

Limit temperature	-40 °C ... 125 °C
-------------------	-------------------

General data

Insulation strength	$10^{12} \Omega$	Material	Polycarbonate, glass fibre reinforced
Plugging cycles	≥ 500	Pollution severity	3
Required plug-in slots	0.5	Series	ModuPlug
UL 94 flammability rating	V-0		

Classifications

ETIM 6.0	EC002312	eClass 6.2	27-14-34-19
eClass 9.0	27-44-02-92	eClass 9.1	27-44-02-18

Approvals

ROHS	Conform
------	---------

Downloads

Brochure/Catalogue	CAT 3 HDC 17/18 EN FL FIELDWIRING EN
Engineering Data	EPLAN
Engineering Data	STEP

Data sheet

**ModuPlug
HDC MDU**

Weidmüller Interface GmbH & Co. KG
Klingenbergstraße 16
D-32758 Detmold
Germany
Fon: +49 5231 14-0
Fax: +49 5231 14-292083
www.weidmueller.com

Drawings

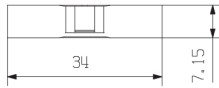
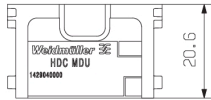

Looking for pricing, stock, or lifecycle information?

Click below to explore more details on WIN SOURCE:

 [View 1429040000 on WIN SOURCE](#)

 [Weidmuller Information](#)

Optimize Your Supply Chain with WIN SOURCE Solutions

-  Global Sourcing Solution
-  Obsolete Management
-  Cost Control Management
-  Shortage Management
-  Alternative Solution
-  Excess Inventory Management