

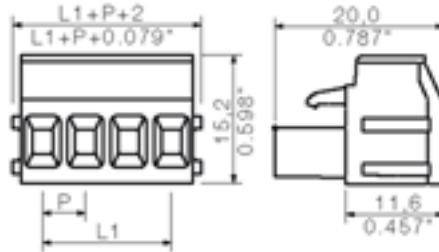

**THE DATASHEET OF  
1356260000**

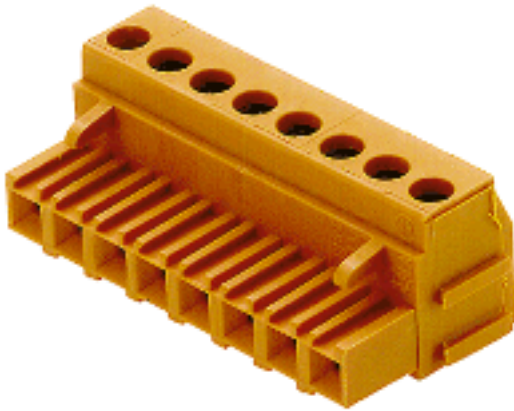



#### General ordering data

Order No.	1356260000
Part designation	BLA 4B SN OR
Version	PCB plug-in connector, Female connectors, Clamping yoke connection, Clamping range, max.: 3.32 mm <sup>2</sup> , Pitch: 5.08 mm, No. of poles: 4, 180°, Box
EAN	4008190171537
Qty.	100 pc(s).

#### System parameters

Conductor connection system	Clamping yoke connection
Outgoing direction of conductor	180°
Pitch	5.08 mm
Pitch in inch	0.2 inch
No. of poles	4
No. of rows	1
Screwdriver blade	0.6 x 3.5
Screwdriver blade standard	DIN 5264
Tightening torque, min.	0.4 Nm
Tightening torque, max.	0.5 Nm
Clamping screw	M 2.5
Stripping length	7 mm
L1 in mm	15.24 mm
L1 in inch	0.6 inch
Electric shock protection to DIN VDE 0470	Finger-safe unplugged/ back-of-hand-safe plugged

#### Material data

Insulating material	PBT GF
Colour	orange
colour chart	Similar to RAL 2000
Insulating material group	IIIa
Flammability class UL 94	V-0
CTI	$\geq 200$

#### Material data

Contact base material	CuSn
Contact surface	tinned

#### Connectable conductors

Clamping range, min.	0.13 mm <sup>2</sup>
Clamping range, max.	3.32 mm <sup>2</sup>
AWG, min.	28
AWG, max.	16
Solid, min. H05(07) V-U	0.2 mm <sup>2</sup>
Solid, max. H05(07) V-U	2.5 mm <sup>2</sup>
Flexible, min. H05(07) V-K	0.2 mm <sup>2</sup>
Flexible, max. H05(07) V-K	1.5 mm <sup>2</sup>
With wire end ferrule, acc. to DIN 46 228/1, min.	0.2 mm <sup>2</sup>
With wire end ferrule, acc. to DIN 46 228/1, max.	1.5 mm <sup>2</sup>
w. plastic collar ferrule, DIN 46228 pt 4, min.	0.2 mm <sup>2</sup>
w. plastic collar ferrule, DIN 46228 pt 4, max.	1.5 mm <sup>2</sup>
Gauge to EN 60999 a x b; ø	2.4 mm x 1.5 mm;

#### DIN IEC rating data

Rated current, min. No. pins (Tu=20°C)	17.5 A
Rated current, max. No. pins (Tu=20°C)	12.5 A
Rated current, min. No. pins (Tu=40°C)	16 A
Rated current, max. No. pins (Tu=40°C)	11 A
Rated voltage for overvoltage class/pollution severity II/2	400 V
Rated voltage for overvoltage class/pollution severity III/2	320 V
Rated voltage for overvoltage class/pollution severity III/3	250 V
Rated impulse withstand voltage for overvoltage class/pollution severity II/2	4 kV
Rated impulse withstand voltage for overvoltage class/pollution severity III/2	4 kV
Rated impulse withstand voltage for overvoltage class/pollution severity III/3	4 kV
Short-time withstand current resistance	3 x 1s with 100 A

#### CSA rating data

Rated voltage (Use group D)	300 V
Rated current (Use group D)	10 A
AWG conductor (field wiring), min.	26
AWG conductor (field wiring), max.	12

#### UL 1059 rating data

Rated voltage (Use group D)	300 V
Rated current (Use group D)	10 A
AWG conductor, min.	26
AWG conductor, max.	12

### Approvals

Approvals institutes



### Classifications

ETIM 2.0	NK
ETIM 3.0	EC001284
eClass 4.1	27-26-07-01
eClass 5.0	27-26-07-01
eClass 5.1	27-26-07-04

### Similar products

Order No.	Part designation	Version
1356060000	BLA 2B SN OR	PCB plug-in connector, Female connectors, Clamping yoke connection, Clamping range, max.: 3.32 mm <sup>2</sup> , Pitch: 5.08 mm, No. of poles: 2, 180°, Box
1356160000	BLA 3B SN OR	PCB plug-in connector, Female connectors, Clamping yoke connection, Clamping range, max.: 3.32 mm <sup>2</sup> , Pitch: 5.08 mm, No. of poles: 3, 180°, Box
1356360000	BLA 5B SN OR	PCB plug-in connector, Female connectors, Clamping yoke connection, Clamping range, max.: 3.32 mm <sup>2</sup> , Pitch: 5.08 mm, No. of poles: 5, 180°, Box
1356460000	BLA 6B SN OR	PCB plug-in connector, Female connectors, Clamping yoke connection, Clamping range, max.: 3.32 mm <sup>2</sup> , Pitch: 5.08 mm, No. of poles: 6, 180°, Box
1356560000	BLA 7B SN OR	PCB plug-in connector, Female connectors, Clamping yoke connection, Clamping range, max.: 3.32 mm <sup>2</sup> , Pitch: 5.08 mm, No. of poles: 7, 180°, Box
1356660000	BLA 8B SN OR	PCB plug-in connector, Female connectors, Clamping yoke connection, Clamping range, max.: 3.32 mm <sup>2</sup> , Pitch: 5.08 mm, No. of poles: 8, 180°, Box
1356760000	BLA 9B SN OR	PCB plug-in connector, Female connectors, Clamping yoke connection, Clamping range, max.: 3.32 mm <sup>2</sup> , Pitch: 5.08 mm, No. of poles: 9, 180°, Box

1356860000	BLA 10B SN OR	PCB plug-in connector, Female connectors, Clamping yoke connection, Clamping range, max.: 3.32 mm <sup>2</sup> , Pitch: 5.08 mm, No. of poles: 10, 180°, Box
1356960000	BLA 11B SN OR	PCB plug-in connector, Female connectors, Clamping yoke connection, Clamping range, max.: 3.32 mm <sup>2</sup> , Pitch: 5.08 mm, No. of poles: 11, 180°, Box
1357060000	BLA 12B SN OR	PCB plug-in connector, Female connectors, Clamping yoke connection, Clamping range, max.: 3.32 mm <sup>2</sup> , Pitch: 5.08 mm, No. of poles: 12, 180°, Box
1357160000	BLA 13B SN OR	PCB plug-in connector, Female connectors, Clamping yoke connection, Clamping range, max.: 3.32 mm <sup>2</sup> , Pitch: 5.08 mm, No. of poles: 13, 180°, Box
1357260000	BLA 14B SN OR	PCB plug-in connector, Female connectors, Clamping yoke connection, Clamping range, max.: 3.32 mm <sup>2</sup> , Pitch: 5.08 mm, No. of poles: 14, 180°, Box
1357360000	BLA 15B SN OR	PCB plug-in connector, Female connectors, Clamping yoke connection, Clamping range, max.: 3.32 mm <sup>2</sup> , Pitch: 5.08 mm, No. of poles: 15, 180°, Box
1357460000	BLA 16B SN OR	PCB plug-in connector, Female connectors, Clamping yoke connection, Clamping range, max.: 3.32 mm <sup>2</sup> , Pitch: 5.08 mm, No. of poles: 16, 180°, Box
1357560000	BLA 17B SN OR	PCB plug-in connector, Female connectors, Clamping yoke connection, Clamping range, max.: 3.32 mm <sup>2</sup> , Pitch: 5.08 mm, No. of poles: 17, 180°, Box
1357660000	BLA 18B SN OR	PCB plug-in connector, Female connectors, Clamping yoke connection, Clamping range, max.: 3.32 mm <sup>2</sup> , Pitch: 5.08 mm, No. of poles: 18, 180°, Box
1357760000	BLA 19B SN OR	PCB plug-in connector, Female connectors, Clamping yoke connection, Clamping range, max.: 3.32 mm <sup>2</sup> , Pitch: 5.08 mm, No. of poles: 19, 180°, Box
1357860000	BLA 20B SN OR	PCB plug-in connector, Female connectors, Clamping yoke connection, Clamping range, max.: 3.32 mm <sup>2</sup> , Pitch: 5.08 mm, No. of poles: 20, 180°, Box
1357960000	BLA 21B SN OR	PCB plug-in connector, Female connectors, Clamping yoke connection, Clamping range, max.: 3.32 mm <sup>2</sup> , Pitch: 5.08 mm, No. of poles: 21, 180°, Box
1358060000	BLA 22B SN OR	PCB plug-in connector, Female connectors, Clamping yoke connection, Clamping range, max.: 3.32 mm <sup>2</sup> , Pitch: 5.08 mm, No. of poles: 22, 180°, Box
1358160000	BLA 23B SN OR	PCB plug-in connector, Female connectors, Clamping yoke connection, Clamping range, max.: 3.32 mm <sup>2</sup> , Pitch: 5.08 mm, No. of poles: 23, 180°, Box
1358260000	BLA 24B SN OR	PCB plug-in connector, Female connectors, Clamping yoke connection, Clamping range, max.: 3.32 mm <sup>2</sup> , Pitch: 5.08 mm, No. of poles: 24, 180°, Box

## Looking for pricing, stock, or lifecycle information?

Click below to explore more details on WIN SOURCE:

 [View 1356260000 on WIN SOURCE](#)

 [Weidmuller Information](#)

## Optimize Your Supply Chain with WIN SOURCE Solutions

-  Global Sourcing Solution
-  Obsolete Management
-  Cost Control Management
-  Shortage Management
-  Alternative Solution
-  Excess Inventory Management