



**THE DATASHEET OF**  
**5433024**



## Printed-circuit board connector - BCH-500VS- 3 GY - 5433024

Please be informed that the data shown in this PDF Document is generated from our Online Catalog. Please find the complete data in the user's documentation. Our General Terms of Use for Downloads are valid (<http://phoenixcontact.com/download>)



Header, Nominal current: 12 A, Rated voltage (III/2): 320 V, Number of positions: 3, Pitch: 5 mm, Color: signal grey, Contact surface: Tin, Mounting: Soldering

The figure shows a 5-pos. version of the product



### Key Commercial Data

|                                      |          |
|--------------------------------------|----------|
| Packing unit                         | 1 pc     |
| Minimum order quantity               | 100 pc   |
| Weight per Piece (excluding packing) | 1.4 g    |
| Custom tariff number                 | 85366990 |
| Country of origin                    | China    |

### Technical data

#### Dimensions

|                          |          |
|--------------------------|----------|
| Length                   | 8.6 mm   |
| Pitch                    | 5.00 mm  |
| Dimension a              | 10 mm    |
| Length of the solder pin | 3.9 mm   |
| Pin dimensions           | 1 x 1 mm |
| Hole diameter            | 1.4 mm   |

#### General

|                             |        |
|-----------------------------|--------|
| Range of articles           | BCH-VS |
| Insulating material group   | I      |
| Rated surge voltage (III/3) | 4 kV   |
| Rated surge voltage (III/2) | 4 kV   |
| Rated surge voltage (II/2)  | 4 kV   |
| Rated voltage (III/3)       | 250 V  |

# Printed-circuit board connector - BCH-500VS- 3 GY - 5433024

## Technical data

### General

|                                        |             |
|----------------------------------------|-------------|
| Rated voltage (III/2)                  | 320 V       |
| Rated voltage (II/2)                   | 400 V       |
| Connection in acc. with standard       | EN-VDE      |
| Nominal current I <sub>N</sub>         | 12 A        |
| Maximum load current                   | 12 A        |
| Insulating material                    | PA          |
| Flammability rating according to UL 94 | V0          |
| Color                                  | signal grey |
| Number of positions                    | 3           |

### Standards and Regulations

|                                        |        |
|----------------------------------------|--------|
| Connection in acc. with standard       | EN-VDE |
|                                        | CUL    |
| Flammability rating according to UL 94 | V0     |

## Classifications

### eCl@ss

|            |          |
|------------|----------|
| eCl@ss 4.0 | 272607xx |
| eCl@ss 4.1 | 27260701 |
| eCl@ss 5.0 | 27260701 |
| eCl@ss 5.1 | 27260701 |
| eCl@ss 6.0 | 27261101 |
| eCl@ss 7.0 | 27440401 |
| eCl@ss 8.0 | 27440402 |

### ETIM

|          |          |
|----------|----------|
| ETIM 3.0 | EC001121 |
| ETIM 4.0 | EC002637 |
| ETIM 5.0 | EC002637 |

### UNSPSC

|               |          |
|---------------|----------|
| UNSPSC 6.01   | 30211801 |
| UNSPSC 7.0901 | 39121432 |
| UNSPSC 11     | 39121432 |
| UNSPSC 12.01  | 39121409 |
| UNSPSC 13.2   | 39121432 |

# Printed-circuit board connector - BCH-500VS- 3 GY - 5433024

## Approvals

### Approvals

#### Approvals

UL Recognized / cUL Recognized / VDE Gutachten mit Fertigungsüberwachung / IEC60364 CB Scheme / cULus Recognized

#### Ex Approvals

#### Approvals submitted

### Approval details

|                                |       |       |
|--------------------------------|-------|-------|
| UL Recognized                  |       |       |
|                                | B     | D     |
| Nominal current I <sub>N</sub> | 15 A  | 10 A  |
| Nominal voltage U <sub>N</sub> | 300 V | 300 V |

|                                |       |       |
|--------------------------------|-------|-------|
| cUL Recognized                 |       |       |
|                                | B     | D     |
| Nominal current I <sub>N</sub> | 15 A  | 10 A  |
| Nominal voltage U <sub>N</sub> | 300 V | 300 V |

|                                         |         |
|-----------------------------------------|---------|
| VDE Gutachten mit Fertigungsüberwachung |         |
| mm <sup>2</sup> /AWG/kcmil              | 0.2-2.5 |
| Nominal current I <sub>N</sub>          | 12 A    |
| Nominal voltage U <sub>N</sub>          | 320 V   |

|                 |  |
|-----------------|--|
| IECEE CB Scheme |  |
|-----------------|--|

# Printed-circuit board connector - BCH-500VS- 3 GY - 5433024

## Approvals



## Drawings

Drilling diagram

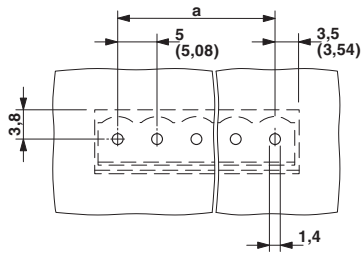

Dimensional drawing

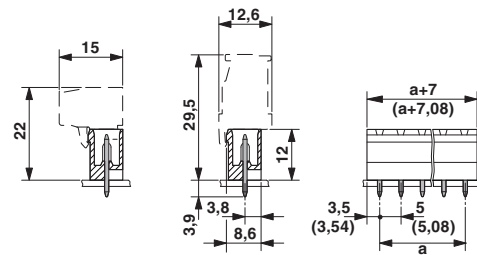

## Looking for pricing, stock, or lifecycle information?

Click below to explore more details on WIN SOURCE:

 [View 5433024 on WIN SOURCE](#)

 [Phoenix Contact Information](#)

## Optimize Your Supply Chain with WIN SOURCE Solutions

-  Global Sourcing Solution
-  Obsolete Management
-  Cost Control Management
-  Shortage Management
-  Alternative Solution
-  Excess Inventory Management