



THE DATASHEET OF T6003NL



NOTES:

1. ROHS COMPLIANT
2. STORAGE TEMPERATURE: -20°C TO +125°C
3. COMPLIANCE TO J-STD:
 - A. J-STD-002: SOLDERABILITY AT 245°C REFLOW PROFILE
 - B. J-STD-020: LEVEL 1, NO MOISTURE SENSITIVE
 - C. J-STD-075: R7, 245°C MAXIMUM THROUGH REFLOW SOLDER
4. TO ORDER TAPE & REEL PACKAGING ADD A "T" SUFFIX TO THE PART NUMBER(i.e T6003NLT BECOMES T6003NLT).

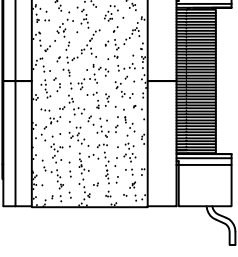
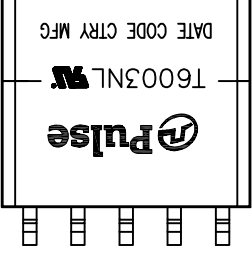

© Copyright, 2016. Pulse Electronics Corp. All rights reserved. Pulse confidential & proprietary. (02/18/16)

PRODUCT DESCRIPTION	TLA DRAWING	PS DRAWING	SHEET
XFMR,SGL,AUD,EP13S,235C	T6003NL-12	PS-2279.001-A	1 OF 3

E-MAIL: PRODINFONETWORK@PULSEELECTRONICS.COM(US). ASIA@PULSEELECTRONICS.COM(Asia)

PHONE: USA:858 674 8100, GERMANY:49 7032 78060, SINGAPORE:65

ELECTRICAL CHARACTERISTICS AT +25°C UN

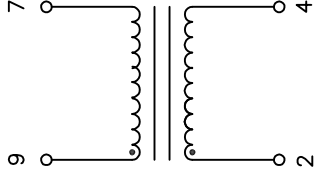

SCHEMATIC

PARAMETER	SP
OPERATING TEMPERATURE	0°C PER
POLARITY	
TURNS RATIO @ 1 KHz, 1 VRMS	$\frac{(2-4)}{(9-7)} = 1.0 \pm 2\%$
INDUCTANCE (OCL) @ 200 Hz, 1 VRMS, .1 mADC	(2-4) = 1.5 H MINI (9-7) = 70 OHMS F
DC RESISTANCE	(2-4) = 55 OHMS F (9-7) = 70 OHMS F
LEAKAGE INDUCTANCE @ 1 KHz, 1 VRMS	(2-4) WITH (9-7) S
CWW @ 1 KHz, 1 VRMS	(2-4) TO (9-7) =
HIPOT	(2,4) TO (7,9) = 15 16

© Copyright, 2016. Pulse Electronics Corp. All rights reserved. Pulse confidential & proprietary. (02/18/16)

PRODUCT DESCRIPTION	TLA DRAWING	PS DRAWING	SHEET
XFMR,SGL,AUD,EP13S,235C	T6003NL-12	PS-2279.001-A	2 OF 3

E-MAIL: PRODINFONETWORK@PULSEELECTRONICS.COM(US). ASIA@PUI SFFI FCTRONICS.COM(Asia)

PHONE: USA:858 674 8100, GERMANY:49 7032 78060, SINGAPORE:65

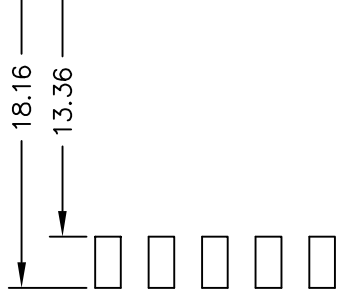
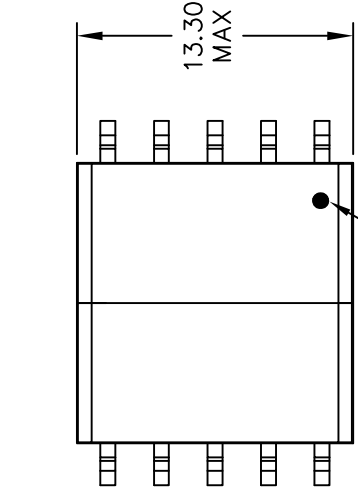

PIN 1 IDENTIFY

PAD LAYOUT

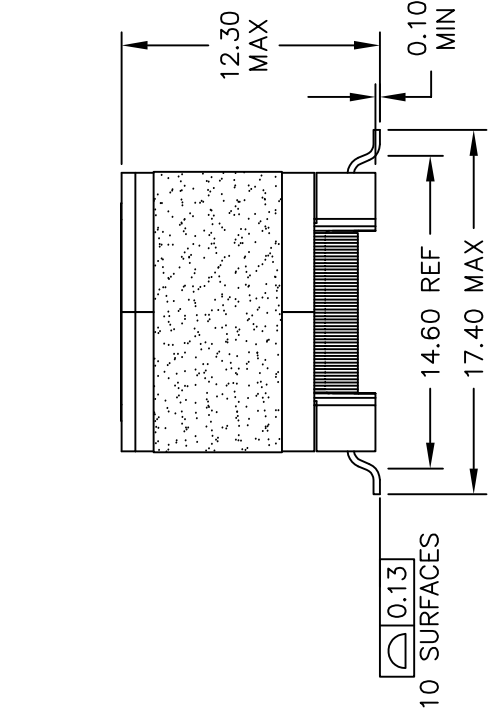

2 SURFACES

DIMENSIONS ARE IN MM WITH THE FOLLOWING TOLERANCES: ± 0.10

© Copyright, 2016. Pulse Electronics Corp. All rights reserved. Pulse confidential & proprietary. (02/18/16)



PRODUCT DESCRIPTION	TLA DRAWING	PS DRAWING	SHEET
XFMR,SGL,AUD,EP13S,235C	T6003NL-12	PS-2279.001-A	3 OF 3

E-MAIL: PRODINFONETWORK@PULSEELECTRONICS.COM(US), ASIA@PULSEELECTRONICS.COM(Asia)

PHONE: USA:858 674 8100, GERMANY:49 7032 78060, SINGAPORE:65

Looking for pricing, stock, or lifecycle information?

Click below to explore more details on WIN SOURCE:

-  [View T6003NL on WIN SOURCE](#)
-  [Pulse Information](#)

Optimize Your Supply Chain with WIN SOURCE Solutions

-  Global Sourcing Solution
-  Obsolete Management
-  Cost Control Management
-  Shortage Management
-  Alternative Solution
-  Excess Inventory Management