

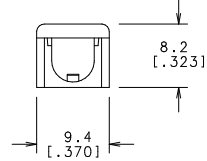

**THE DATASHEET OF
00BS0232P**

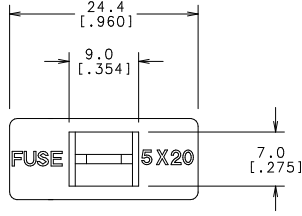

1.8
[.071]

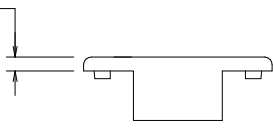

UNLESS OTHERWISE SPECIFIED, DIMENSIONS ARE IN MILLIMETERS.
DIMENSIONS IN BRACKETS [] ARE INCHES

CPK DENOTES CRITICAL CHARACTERISTICS.
CPV DENOTES CPK DIMENSIONS - MINIMUM CPK VALUE

CPV DENOTES A CHARACTERISTIC THAT PROVIDES AN INDICATION OF THE PART'S PERFORMANCE IN ACCORDANCE WITH THE INSPECTION PROCEDURE FOR MEASUREMENT OF THIS CHARACTERISTIC. TELETYPE INSPECTION INSTRUCTIONS.

CPV DENOTES CPK DIMENSIONS - MINIMUM CP VALUE
CPV MUST BE WITHIN THE DIMENSIONAL LIMITATIONS SPECIFIED IN THE DRAWING. DIMENSIONS ARE TO BE MEASURED TO THE CENTER OF THE HOLE UNLESS OTHERWISE SPECIFIED.
CPV ALLOW FOR MAXIMUM TOOL LIFE

NO	COMPONENT NO	DESCRIPTION	QTY/M	U/M

BILL OF MATERIAL		FINISH	
CDPIES TO	MATL SPEC	DATE	SCALE
1	9 18	06/09/04	2:1
2	10 19		
3	12 20		
4	15 21		
5	14 23		
6	15 33		
7	16 43		
8	17 53		

TOLERANCE UNLESS OTHERWISE SPECIFIED
TWO PLACE DEC ±.25(.01) FRACTION ±
THREE PLACE DEC ±.100(.004) ANGULAR ±1°

TITLE 5 X 20mm PC FUSEHOLDER COVER

LTR	REVISION	CHK	APD
A	61471 - RELEASED 6/9/04 BJJ		

UNCONTROLLED DOCUMENT

Looking for pricing, stock, or lifecycle information?

Click below to explore more details on WIN SOURCE:

 [View 00BS0232P on WIN SOURCE](#)

 [Littelfuse Inc. Information](#)

Optimize Your Supply Chain with WIN SOURCE Solutions

-  Global Sourcing Solution
-  Obsolete Management
-  Cost Control Management
-  Shortage Management
-  Alternative Solution
-  Excess Inventory Management