



**THE DATASHEET OF  
PTS641SP31SMTR2LFS**



# PTS641 Series SMT Top Actuated Switches



## Features/Benefits

- 6.3 x 6.3 mm footprint
- Multiple heights
- Ground pin option

## Typical Applications

- Metering
- White goods
- Home and garden equipment

## Specification

FUNCTION: Momentary action  
 CONTACT ARRANGEMENT: 1 make contact = SPST N.O.  
 TERMINALS: G type for SMT

## Mechanical

TRAVEL: 0.20 mm ±0.15 mm for 160 & 250 gf  
 0.30 mm ±0.15 mm for 320 gf  
 OPERATING LIFE: 200,000 cycles for 160 gf version  
 100,000 cycles for 250 gf & 320 gf versions  
 OPERATION FORCE: 160 gf ±50 gf blue actuator  
 250 gf ±50 gf red actuator  
 320 gf ±80 gf black actuator

## Packaging

Switches in reels of 1,500 pieces.  
 Dimensions of reels according to EIA 481B  
 External diameter 330 mm

## Electrical

MAXIMUM VOLTAGE: 12 VDC  
 MAXIMUM CURRENT DC: 50 mA  
 DIELECTRIC STRENGTH: 250 VA C (1mn)  
 CONTACT RESISTANCE: 100 m Ω  
 INSULATION RESISTANCE: ≥ 100 M Ω  
 BOUNCE TIME: < 5 ms

## Environmental

OPERATING TEMPERATURE: -20°C to 85°C

## Process

SOLDERING: This component is suited to the following methods:  
 Infrared Reflow Soldering in accordance with IEC61760-1

## NOTE:

- Specifications listed above are for switches with standard options. For information on specific and custom switches, consult Customer Service Center.
- The PTS series is not certified for using in Automotive application and no PPAP. However, in the case of some automotive accessories and specific applications for 2 and 3 wheeled vehicles the PTS is widely used and very suitable. Please contact your local C&K representative to discuss your application and the best switch solution.

## How To Order

Our easy build-a-switch concept allows you to mix and match options to create the switch you need. To order, select desired option from each category and place it in the appropriate box.

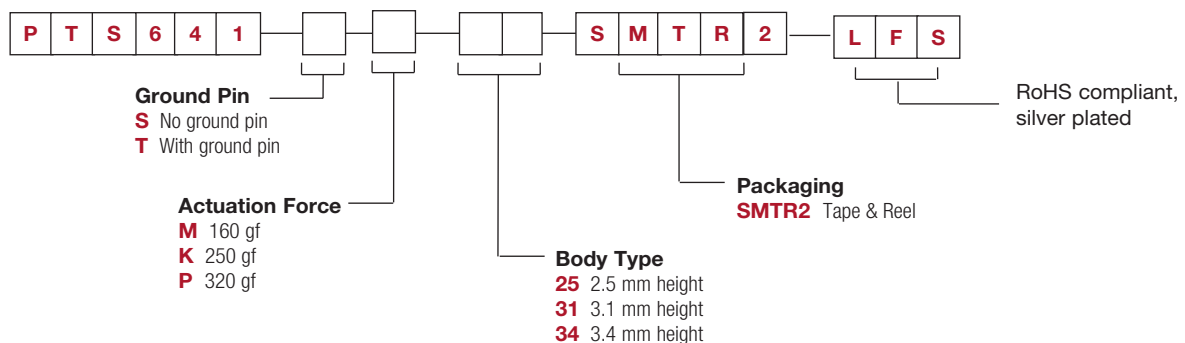

# PTS641 Series SMT Top Actuated Switches

**NO GROUND PIN** H = 2.5, 3.1, or 3.4 mm

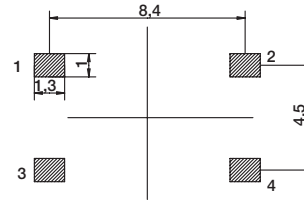
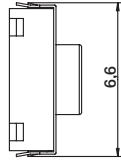
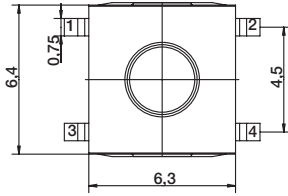
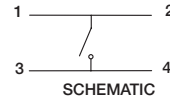
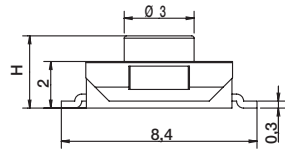

RECOMMENDED PCB LAYOUT

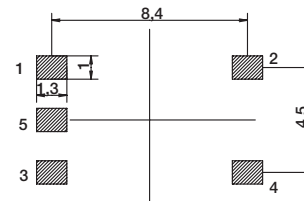
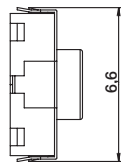
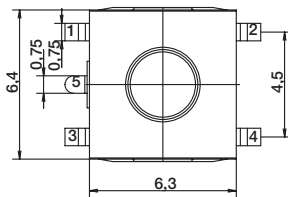
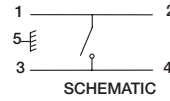
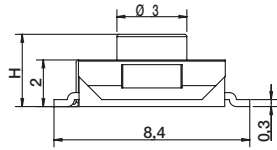

**GROUND PIN** H = 2.5, 3.1, or 3.4 mm



RECOMMENDED PCB LAYOUT

## Looking for pricing, stock, or lifecycle information?

Click below to explore more details on WIN SOURCE:

-  [View PTS641SP31SMTR2LFS on WIN SOURCE](#)
-  [C&K Components Information](#)

## Optimize Your Supply Chain with WIN SOURCE Solutions

-  Global Sourcing Solution
-  Obsolete Management
-  Cost Control Management
-  Shortage Management
-  Alternative Solution
-  Excess Inventory Management