



THE DATASHEET OF
S3



REVISION FOR DWG # 1PB-S1-4

REV	CH.NO.	DESCRIPTION	DATE	REVISED BY
-	-	ORIGINAL DESIGN	11/15/2007	PHILIPP E.

**S1**

Normally Open Silver

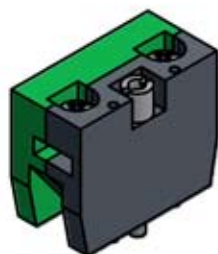
**S3**

Normally Open Gold Plated

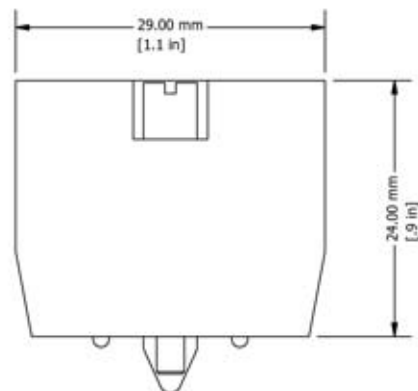
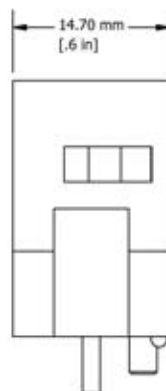
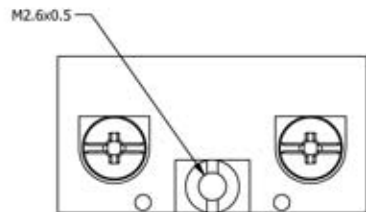
**S2**

Normally Closed Silver

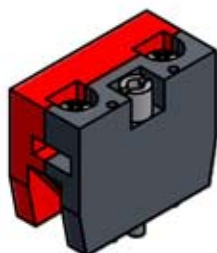
**S4**

Normally Closed Gold Plated

UNLESS OTHERWISE SPECIFIED:

- ALL DIMENSIONS ARE IN MILLIMETERS
- THIRD ANGLE PROJECTION



This Drawing is the property of

AND IS A CONFIDENTIAL DISCLOSURE WITHOUT CONSIDERATION OTHER THAN THE BORROWER'S AGREEMENT THAT IT SHALL NOT BE REPRODUCED, COPIED, LENT OR DISPOSED OF DIRECTLY OR INDIRECTLY NOR USED FOR ANY PURPOSE OTHER THAN THAT FOR WHICH IT IS SPECIFICALLY FURNISHED.

TITLE **22 mm Push Button Switch Contacts Panel Mount Types S1, S2, S3, S4**

DRAWN BY: Philipp Ernstberger

11/15/2007

DRAWING NO.:

REV.:

CHECKED BY: Laszlo Gyorgypal

11/15/2007

1PB-S1-4

-

RELEASED BY: Laszlo Gyorgypal

11/15/2007

SCALE: -

SHEET: 1

OF: 1

M
E
T
R
I
C

35 Royal Road
Flammington, NJ 08823-6000
(908) 806-9400
Fax (908) 806-9400

TOLERANCE		
XX	=	±1 mm
XX.X	=	±0.5 mm
XX.XX	=	±0.2 mm
ALL	=	- mm

Looking for pricing, stock, or lifecycle information?

Click below to explore more details on WIN SOURCE:

-  [View S3](#) on WIN SOURCE
-  [Altech corporation](#) Information

Optimize Your Supply Chain with WIN SOURCE Solutions

-  Global Sourcing Solution
-  Obsolete Management
-  Cost Control Management
-  Shortage Management
-  Alternative Solution
-  Excess Inventory Management