



**THE DATASHEET OF  
PVA1 OA H2 1.2N V2**



# PVA Series

## Short Stroke Key Switches

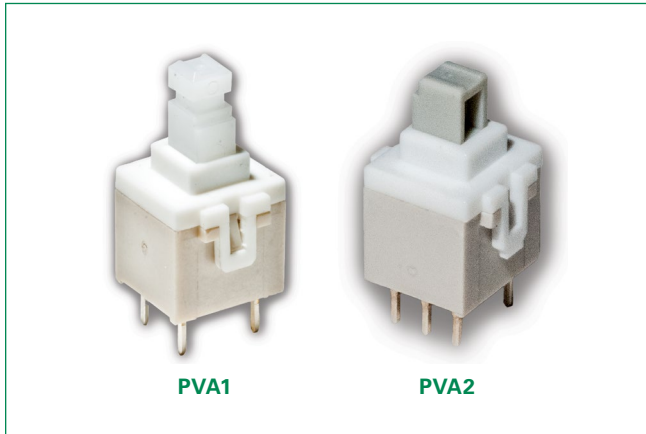

PVA1

PVA2

### Construction Specifications

<b>Function</b>	Momentary, Push-Push
<b>Contact Arrangement</b>	PVA1: 2 make contacts (DPST) PVA2: 2 change over contacts (DPDT)
<b>Switching Mode</b>	Non-shorting
<b>Terminals</b>	PC Pins <sup>1</sup>

### Mechanical Specifications

<b>Total Travel / Latching Travel</b>	OA: 2.4 mm EE: 2.4 / 1.5 mm
<b>Electrical Travel</b>	0.8 mm (1.1 for PVA2 OA H5)
<b>Operating Force</b>	1.2N; 1.7N; 3.5N

### Process

<b>Solderability</b>	Wave soldering, compatible with lead free soldering profile Hand soldering, 350°C for 3 seconds
----------------------	--

#### Notes:

Specifications listed above are for switches with standard options. For information on specific and custom switches, please contact technical support.

## Description

PVA Short Stroke keyswitches have a compact design, making them the perfect switch for control panels, industrial use and automotive applications such as air conditioning or lighting. Adapted for medium power applications, the PVA is designed with a short stroke to latch and comes in a wide variety of actuator heights to make sure it can fit the specific needs of your product.

## Features & Benefits

- Compact design
- Short stroke to latch
- Wide variety of actuator heights
- Adapted for medium power applications
- RoHS compliant and compatible

## Applications

- Automotive (air conditioning, lighting)
- Industrial
- Control panel

### Electrical Specifications

<b>Switching Power Max.</b>	3 W DC
<b>Switching Voltage Max.</b>	32 V DC
<b>Switching Current Max.</b>	100 mA DC
<b>Dielectric Strength (50 Hz / 1 min.)</b>	100 V between open contacts, PVA2: 750 V
<b>Operating Life</b>	OA (momentary): $\geq 1 \times 10^5$ operations EE (push-push): $\geq 1 \times 10^5$ operations
<b>Contact Resistance</b>	Initial $\leq 100 \text{ m}\Omega$
<b>Insulation Resistance</b>	$\geq 10^{10} \Omega$
<b>Bounce Time</b>	$\leq 3 \text{ ms}$

### Environmental Specifications

<b>Operating Temperature</b>	-40°C to 85°C <sup>2</sup>
------------------------------	----------------------------

#### Notes:

1. "Snap-in" contacts on request, Version SNA with pins bent inside (standard)
2. With button +70°C

# PVA Series

## Short Stroke Key Switches



### Ordering Number

Our easy build-a-switch concept allows you to mix and match options to create the switch you need. To order, select desired option from each category and place it in the appropriate box. **Some of the configurations may not be available or could require some development.**

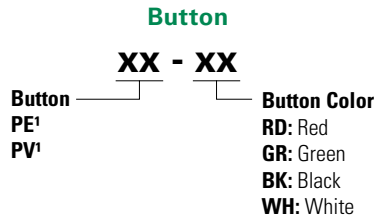
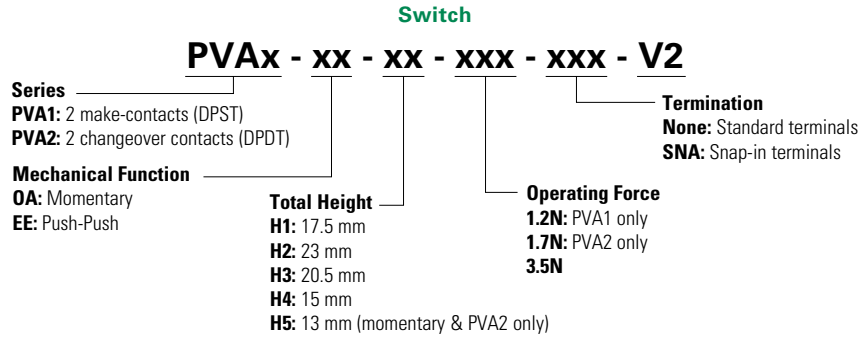

**Notes:**  
 Buttons must be ordered separately. Shipped in bulk.  
 1. Compatible with H1 and H3 actuator models only.

### Series

#### PVA1 (DPST)

#### Dimensions in Inches

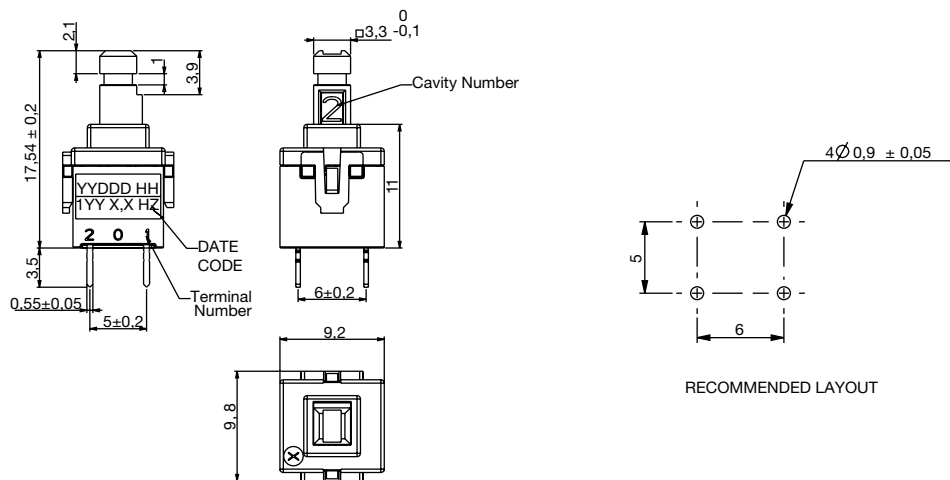

# PVA Series

## Short Stroke Key Switches



### PVA2 (DPDT) Dimensions in Inches

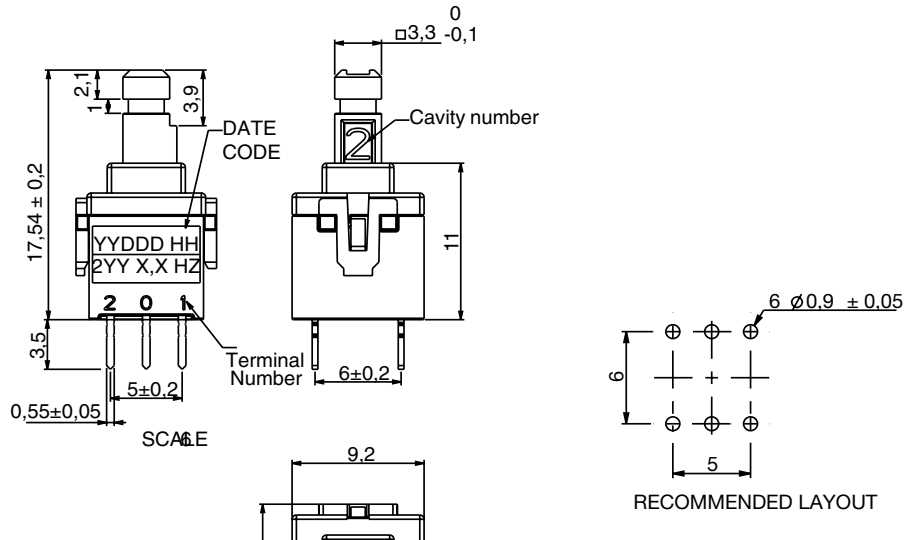

### Mechanical Function

Option Code	Function
OA	Momentary
EE	Push-push

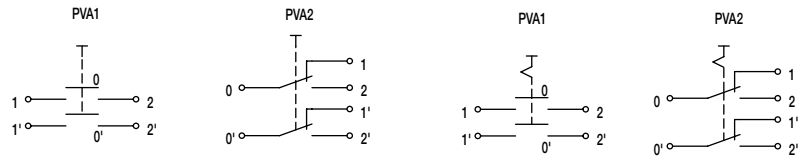

### Total Height

**H1 17.5 mm**

H1

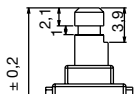

**H2 23 mm**

H2

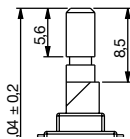

**H3 20.5 mm**

H3

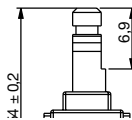

**H4 15 mm**

H4

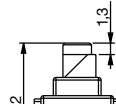

**H5 13 mm  
(momentary only)**

H5

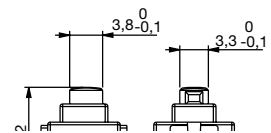

# PVA Series

## Short Stroke Key Switches



### Operating Force

- 1.2N PVA1 only
- 1.7N PVA2 only
- 3.5N PVA1 & PVA2

### Buttons

Option Code	Color
RD	Red
GY	Gray
BK	Black
WH	White

### Termination

#### SNA with PVA1

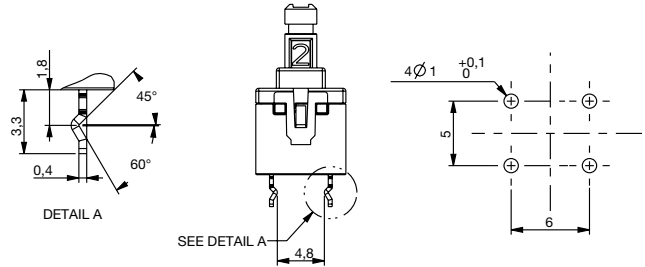

#### SNA with PVA2

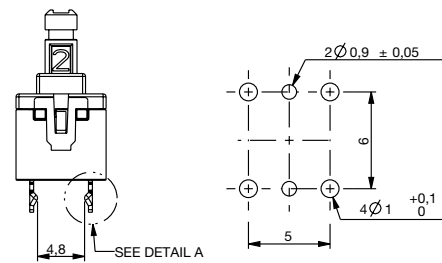

### PE

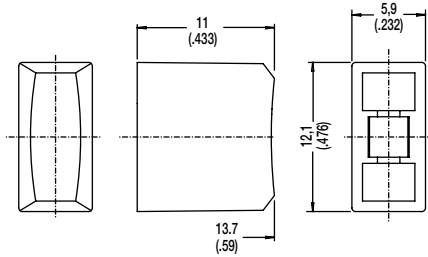

### PV

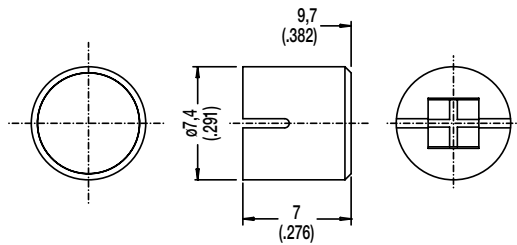

**Note:**  
Buttons must be ordered separately. Shipped in bulk.

**Disclaimer Notice** - Information furnished is believed to be accurate and reliable. However, users should independently evaluate the suitability of and test each product selected for their own applications. Littelfuse products are not designed for, and may not be used in, all applications. Read complete Disclaimer Notice at <http://www.littelfuse.com/disclaimer-electronics>.

## Looking for pricing, stock, or lifecycle information?

Click below to explore more details on WIN SOURCE:

- ⊖ [View PVA1 OA H2 1.2N V2 on WIN SOURCE](#)
- ⊖ [C&K Components Information](#)

## Optimize Your Supply Chain with WIN SOURCE Solutions

- ✓ Global Sourcing Solution
- ✓ Obsolete Management
- ✓ Cost Control Management
- ✓ Shortage Management
- ✓ Alternative Solution
- ✓ Excess Inventory Management