

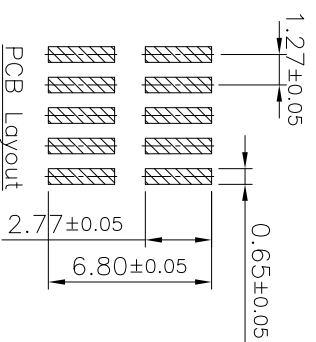

**THE DATASHEET OF  
3221-10-0300-00-TR**

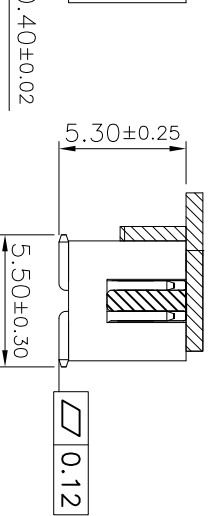

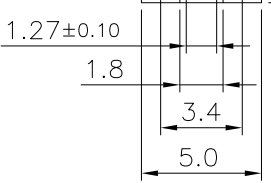

Specifications:  
 Current rating:1.0A AC,DC  
 Voltage rating:50V AC, DC  
 Contact resistance:20m ohm Max  
 Insulation resistance:1,000M ohm Min  
 Withstanding voltage:500V AC/minute  
 Operating Temperature:-40°C ~ +105°C

Materials:  
 Insulator:Nylon 9T(UL94V-0)  
 Standard Color:Black  
 Terminal:Brass  
 Finish:Gold Plated

Dimension Information:

Pin.No	Dim.A	Dim.B	Dim.C	Pin.No	Dim.A	Dim.B	Dim.C
8	3.81	9.83	11.43	30	17.78	23.80	25.40
10	5.08	11.10	12.70	34	20.32	26.34	27.94
12	6.35	12.37	13.97	40	24.13	30.15	31.75
14	7.62	13.64	15.24	44	26.67	32.69	34.29
16	8.89	14.91	16.51	50	30.48	36.50	38.10
20	11.43	17.45	19.05	60	36.83	42.85	44.45
24	13.97	19.99	21.59	68	41.91	47.93	49.53
26	15.24	21.26	22.86				

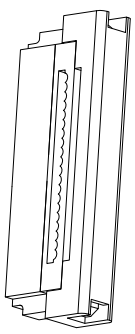

MATING PART  
 3230-XX-0104-00



DRAWN: Jamie	GENERAL TOLERANCE: .X = ±0.25 .XX = ±0.20	DESCRIPTION: 1.27mm Box Header SMD Type	SIZE A4
APPROVAL: Roy	SHEET: 1 / 1	PART NO: 3221-XX-0300-00-TR	RoHS Compliant

**CnC Tech**  
 Industrial Cable and Connector Technology





RoHS Compliant

## Looking for pricing, stock, or lifecycle information?

Click below to explore more details on WIN SOURCE:

-  [View 3221-10-0300-00-TR on WIN SOURCE](#)
-  [CNC Tech Information](#)

## Optimize Your Supply Chain with WIN SOURCE Solutions

-  Global Sourcing Solution
-  Obsolete Management
-  Cost Control Management
-  Shortage Management
-  Alternative Solution
-  Excess Inventory Management