



**THE DATASHEET OF
M40-4010446**



IF IN DOUBT - ASK



NOT TO SCALE

THIRD ANGLE PROJECTION

ALL DIMENSIONS IN mm

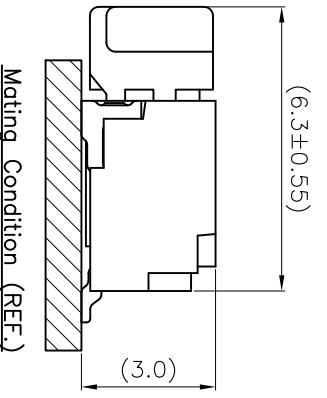
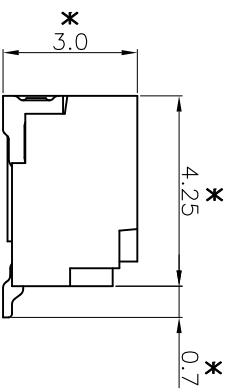
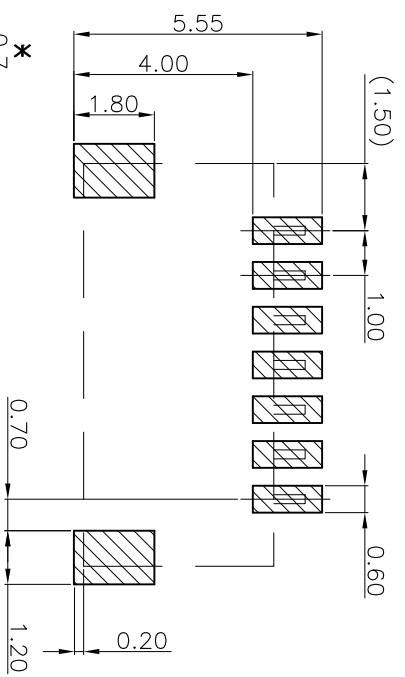

Mating Condition (REF.)

TOLERANCE: ±0.05
RECOMMENDED P.C.B. Layout
TOP VIEW

NO. OF WAYS	PART NO.	Dim.(mm)	
		A	B
2	M40-4010246R	1.00	4.00
3	M40-4010346R	2.00	5.00
4	M40-4010446R	3.00	6.00
5	M40-4010546R	4.00	7.00
6	M40-4010646R	5.00	8.00
7	M40-4010746R	6.00	9.00
8	M40-4010846R	7.00	10.00
9	M40-4010946R	8.00	11.00
10	M40-4011046R	9.00	12.00
11	M40-4011146R	10.00	13.00
12	M40-4011246R	11.00	14.00
13	M40-4011346R	12.00	15.00
14	M40-4011446R	13.00	16.00
15	M40-4011546R	14.00	17.00
16	M40-4011646R	15.00	18.00
17	M40-4011746R	16.00	19.00
18	M40-4011846R	17.00	20.00
19	M40-4011946R	18.00	21.00
20	M40-4012046R	19.00	22.00

SPECIFICATIONS:
MATERIAL: LCP, UL94V-0 (HALOGEN FREE); COLOR: CREAM.
INSULATION: COPPER ALLOY, t=0.20mm.
FINISH: MATTE-TIN PLATED OVER NICKEL
ELECTRICAL:
CURRENT RATING: 1A AC/DC
WORKING VOLTAGE: 50V AC/DC
WITHSTANDING VOLTAGE: 500V AC/MINUTE
CONTACT RESISTANCE: 30 mΩ MAX.
INSULATION RESISTANCE: 100 MΩ MIN.
ENVIRONMENTAL:
TEMPERATURE RANGE: -25°C TO +85°C

NOTE: ALL DIMENSIONS AND NOTES MARKED * ARE CRITICAL AND MUST BE CHECKED IN ACCORDANCE WITH QUALITY DOC. QI-02A

NAME	ISS.	DATE	C/NOTE
Leo	6	08.02.18	A533
Allan	5	25.09.08	A164
Allan	4	27.06.08	A136
Allan	3	19.06.08	A130
Allan	2	08.03.07	A022
Allan	1	01.08.06	--

APPROVED:	B.Lim
CHECKED:	D.P
DRAWN:	Leo
CUSTOMER REF.:	
ASSEMBLY DRG.:	

THIS DRAWING AND ANY INFORMATION OR DESCRIPTION MATTER SET OUT HEREON ARE CONFIDENTIAL AND COPYRIGHT PROPERTY OF THE HAWAII GROUP AND MUST NOT BE DISCLOSED, LOANED, COPIED, OR USED FOR MANUFACTURING, TENDERING OR FOR ANY OTHER PURPOSE WITHOUT THEIR WRITTEN PERMISSION.

TOLERANCES
X, X = ±1mm
X.X = ±0.25mm
X.XX = ±0.15mm
X.XXX = ±0.08mm
ANGLES = ±5°
UNLESS STATED

MATERIAL: SEE NOTES
FINISH: SEE NOTES
S/AREA: mm²

TITLE: WAFER 1.00mm SIDE ENTRY SMT TYPE
DRAWING NUMBER: M40-401 XX 46 X
SHT 1 OF 2

IN Asia
6 779 4909
6 779 3868
WIN.COM.SG

IF IN DOUBT - ASK



NOT TO SCALE

THIRD ANGLE PROJECTION

ALL DIMENSIONS IN mm

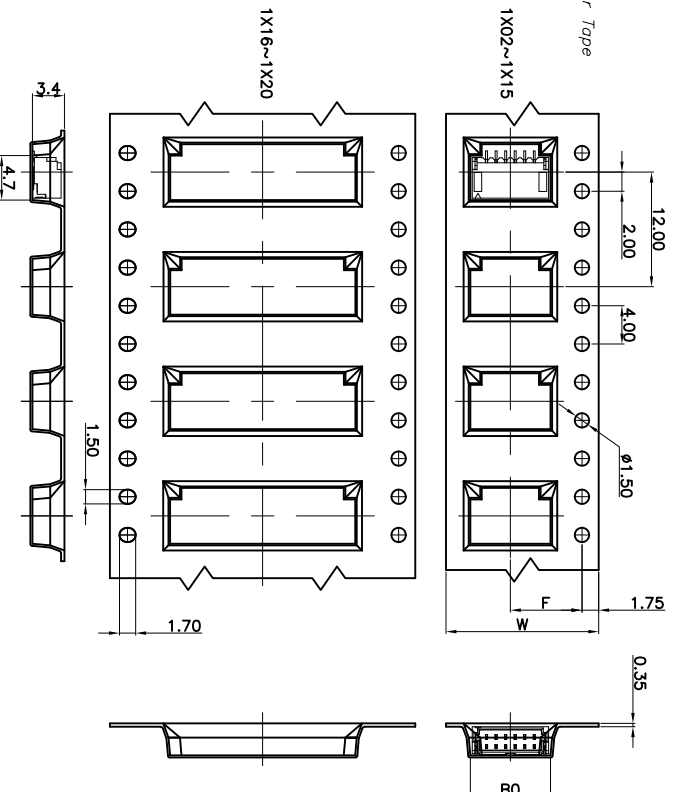
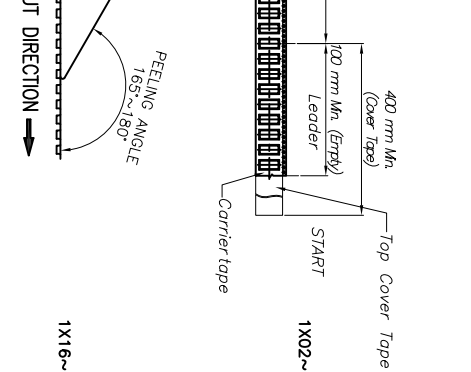

Pin	Dim. (mm)			
	BO	F	W	W1
1x02	4.40			
1x03	5.40			
1x04	6.40	7.50	16.00	17.50
1x05	7.40			
1x06	8.40			
1x07	9.40			
1x08	10.40			
1x09	11.40			
1x10	12.40	11.50	24.00	25.50
1x11	13.40			
1x12	14.40			
1x13	15.40			
1x14	16.40			
1x15	17.40			
1x16	18.40			
1x17	19.40	14.20	32.00	33.50
1x18	20.40			
1x19	21.40			
1x20	22.40	20.20	44.00	45.50

- 10 SPROCKET HOLE PITCH CUMULATIVE TOLERANCE ± 0.20
- CARRIER CAMBER IS WITHIN 1 mm IN 250 mm
- THE TOTAL TEARING CONTROL RANGE OF TOP COVER TAPE IS 10~130g, REFERENCE SPEC: EIA-481-D
- PEELING SPEED: 300mm/MINUTES, REFERENCE SPEC: EIA-481-D
- MATERIAL: TRANSPARENT CONDUCTIVE POLYSTYRENE ALLOY (UP-5000)
- ALL DIMENSIONS MEET EIA-481-D REQUIREMENTS
- THICKNESS: 0.35 \pm 0.05mm
- COMPONENT LOAD PER 13" REEL: 1500 PCS

NOTE: ALL DIMENSIONS AND NOTES MARKED * ARE CRITICAL AND MUST BE CHECKED IN ACCORDANCE WITH QUALITY DOC. QI-02A

NAME	ISS.	DATE	C/NOTE
Leo	6	08.02.18	A533
Allan	5	25.09.08	A164
Allan	4	27.06.08	A136
Allan	3	19.06.08	A130
Allan	2	08.03.07	A022
Allan	1	01.08.06	--
APPROVED:	B.Lim		
CHECKED:	D.P		
DRAWN:	Leo		
CUSTOMER REF.:			
ASSEMBLY DRG:			

TOLERANCES

X, X = $\pm 1mm$
 X.X = $\pm 0.25mm$
 X.XX = $\pm 0.15mm$
 X.XXX = $\pm 0.08mm$
 ANGLES = $\pm 5^\circ$
 UNLESS STATED

MATERIAL:

SEE NOTES

TITLE:

WAFER 1.00mm SIDE ENTRY SMT
 TYPE

DRAWING NUMBER:

M40-401 XX 46 X



SHT
2
OF
2

IN Asia
 6 779 4909
 6 779 3868
 WIN.COM.SG

THIS DRAWING AND ANY INFORMATION OR DESCRIPTION SET OUT HEREON ARE CONFIDENTIAL AND COPYRIGHT PROPERTY OF THE HAWAII GROUP AND MUST NOT BE DISCLOSED, LOANED, COPIED, REPRODUCED, TRANSMITTED, TENDERING OR FOR ANY OTHER PURPOSE WITHOUT THEIR WRITTEN PERMISSION.

Looking for pricing, stock, or lifecycle information?

Click below to explore more details on WIN SOURCE:

-  [View M40-4010446 on WIN SOURCE](#)
-  [Harwin Inc. Information](#)

Optimize Your Supply Chain with WIN SOURCE Solutions

-  Global Sourcing Solution
-  Obsolete Management
-  Cost Control Management
-  Shortage Management
-  Alternative Solution
-  Excess Inventory Management