

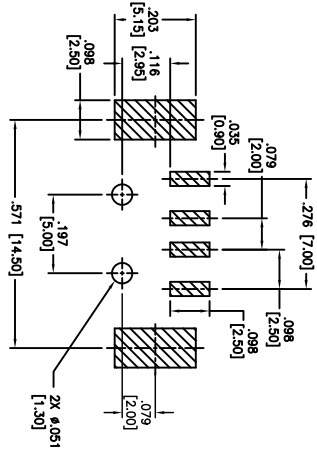

Rev	AWO #	Description	Date	Appr
-		RELEASED	11/03/04	
A		UPDATED	3/27/08	
B		REVISED SPEC.	5/30/11	
C		REVISED DIM.	6/23/11	
D		REVISED DIM.	7/24/14	AVY/C
E		REVISED DIM.	10/15/14	AV/GC
F		UPDATED SPEC.	8/19/15	HR/NC
G		UPDATED SPEC.	2/18/16	HR/AV/1

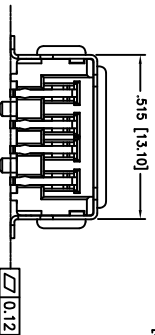

RECOMMENDED  
PCB LAYOUT

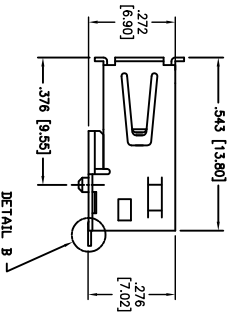
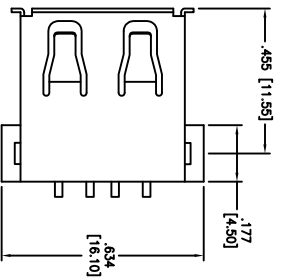
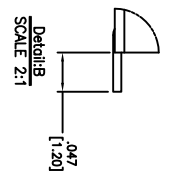
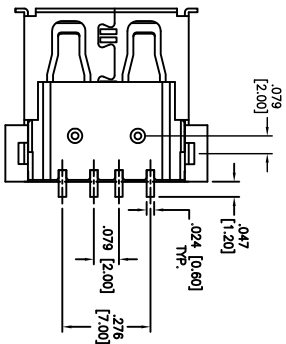
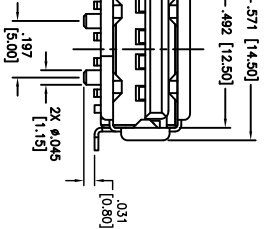

Detail B  
SCALE 2:1



0X.  
s min. @ 500 VDC  
0 VAC for 1 minute  
+85°C



UNLESS OTHERWISE SPECIFIED ALL DIMENSIONS ARE INCHES [MM] TOLERANCES: EXCEPT AS NOTED		TITLE	
INCHES	HOLES	ADAM TECH	
.X ± .10	ØX ± .10	909 Railway Avenue, Union, NJ 07083	
.XX ± .020	ØXXX ± .015	Phone: 908-687-5000 Fax: 908-687-5710	
.XXX ± .015	ØXXXX ± .010	USB TYPE A, RIGHT ANGLE, TRUE SURFACE MOUNT	
APPROVALS	DATE	PART NO. USB-A-S-RA-TSMT	
DRAWN SS	11/03/04	SIZE X	REV. G
CHECKED		REF: S00036C	SHEET 1 OF 1
APPROVED		SCALE: NTS	

## Looking for pricing, stock, or lifecycle information?

Click below to explore more details on WIN SOURCE:

-  [View USB-A-S-RA-TSMT on WIN SOURCE](#)
-  [Adam Technologies, Inc. Information](#)

## Optimize Your Supply Chain with WIN SOURCE Solutions

-  Global Sourcing Solution
-  Obsolete Management
-  Cost Control Management
-  Shortage Management
-  Alternative Solution
-  Excess Inventory Management