

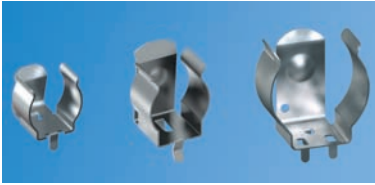

THE DATASHEET OF
596



PC BATTERY CLIPS



- Mounts securely to the PC board with advanced "Snap-In" design for thru hole mounting
- Reliable spring tension assures low contact resistance
- Low profile, economical design
- Retains battery securely to withstand shock and vibration
- AAAA, AAA, AA, N, 12V, 2/3A, 17-19mm



Refer to page 35 for Battery Contact Layout & Mounting Details

"AAAA" - "A27"

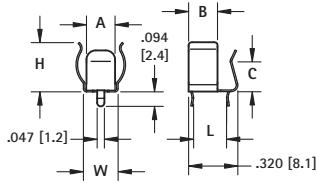

FIG. 1

"AAA" - "N" - "A23" - "AA" - "CR2"

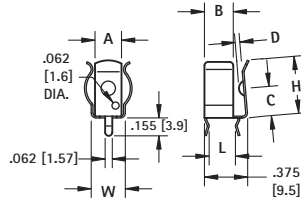

FIG. 2

"A" - 17-19mm*

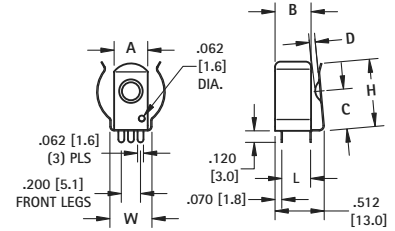

FIG. 3

*17335, 17450, 17500, 17650, 18600, 18650 cells

MATERIAL: Spring Steel, Tin-Nickel Plate

| CAT. NO. | FIG. | BATTERY SIZE | BATTERY DIAMETER | A | B | C | D | H | L | W | MATERIAL THICKNESS |
|----------|------|---------------------|-----------------------|------------|------------|------------|------------|-------------|------------|-------------|--------------------|
| 51 | 1 | "AAAA" - "A27" | .300-.350 (7.6-8.9) | .187 (4.8) | .187 (4.8) | .194 (4.9) | - | .320 (8.1) | .214 (5.4) | .226 (5.7) | .010 (.25) |
| 82 | 2 | "AAA" - "N" - "A23" | .375-.460 (9.5-11.7) | .250 (6.4) | .250 (6.4) | .280 (7.1) | .040 (1.0) | .498 (12.7) | .228 (5.8) | .296 (7.5) | .010 (.25) |
| 52 | 2 | "AA" - "CR2" - "A" | No Ears | .250 (6.4) | - | .280 (7.1) | .032 (0.8) | .498 (12.7) | .228 (5.8) | .250 (6.4) | .010 (.25) |
| 92 | 2 | "AA" - "CR2" | .531-.665 (13.5-16.9) | .312 (7.9) | .250 (6.4) | .359 (9.1) | .050 (1.3) | .593 (15.1) | .228 (5.8) | .369 (9.4) | .012 (.30) |
| 2915 | 2 | "AA" - "CR2" | .531-.665 (13.5-16.9) | .312 (7.9) | .250 (6.4) | .359 (9.1) | .050 (1.3) | .593 (15.1) | .228 (5.8) | .376 (9.5) | .015 (.38) |
| 54 | 3 | "A" - 17-19mm* | .669-.748 (17.0-19.0) | .350 (8.9) | .375 (9.5) | .385 (9.8) | .062 (1.6) | .653 (16.6) | .300 (7.6) | .438 (11.1) | .012 (.30) |

*Battery Reference: 2/3A, 17335, 17450, 17500, 17650, 18500, 18650 cells

P.C. BUTTON & SPRING CONTACTS



- Space saving design installs directly onto the PC board
- Suitable for .062 (1.57) to .093 (2.36) PC boards
- Reliable spring tension assures low contact resistance
- Ideal for self-contained battery compartments



COIL SPRING

"AA" - "CR2" - "A"

(+) POSITIVE BUTTON

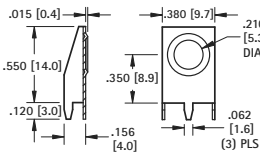

MATERIAL:
Frame: .015 (.38)
Steel, Tin-Nickel Plate

CAT. NO. 595

(-) NEGATIVE SPRING

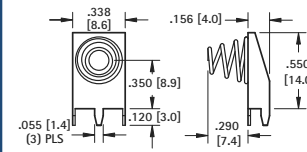

MATERIAL:
Frame: .015 (.38) Steel,
Matte Tin Plate

CAT. NO. 628

"AAA" - "N" - "A23"

(+) POSITIVE BUTTON

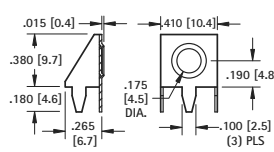

MATERIAL:
Frame: .015 (.38) Steel,
Tin-Nickel Plate

CAT. NO. 637

(-) NEGATIVE SPRING

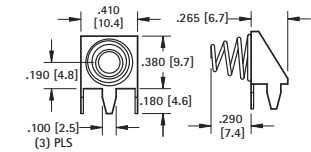

MATERIAL:
Frame: .015 (.38)
Steel, Matte Tin Plate

CAT. NO. 629

LEAF SPRING

MATERIAL: .012 (.30) Spring Steel, Tin-Nickel Plate

"AA" - "CR2" - "A"

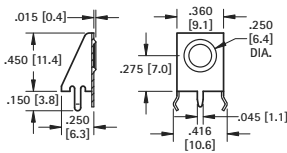

CAT. NO. 596

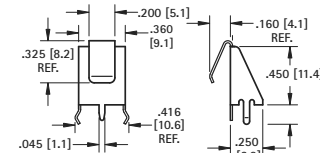

CAT. NO. 590

MATERIAL: .010 (.25) Spring Steel, Tin-Nickel Plate

"AAA" - "N" - "A23"

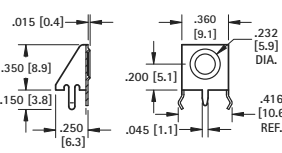

CAT. NO. 597

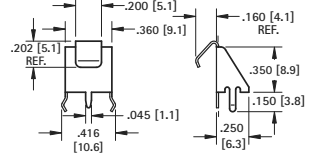

CAT. NO. 591

Looking for pricing, stock, or lifecycle information?

Click below to explore more details on WIN SOURCE:

-  [View 596](#) on WIN SOURCE
-  [Keystone Electronics](#) Information

Optimize Your Supply Chain with WIN SOURCE Solutions

-  Global Sourcing Solution
-  Obsolete Management
-  Cost Control Management
-  Shortage Management
-  Alternative Solution
-  Excess Inventory Management