



**THE DATASHEET OF  
DESD1P0RFWQ-7**



## Features

- Low Capacitance
- Small Surface Mount Package
- For ESD Protection of High Speed Data Lines
- **Lead Free/RoHS Compliant (Note 1)**
- **"Green" Device (Note 2)**
- **Qualified to AEC-Q101 Standards for High Reliability**

## Mechanical Data

- Case: SOT323
- Case Material: Molded Plastic, "Green" Molding Compound.  
UL Flammability Classification Rating 94V-0
- Moisture Sensitivity: Level 1 per J-STD-020
- Terminals: Matte Tin Finish Annealed Over Alloy 42 Leadframe  
(Lead Free Plating). Solderable per MIL-STD-202, Method 208
- Weight: 0.006 Grams (Approximate)

SOT323



Top View

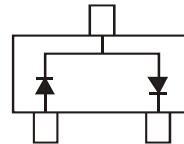

Top View  
Internal Schematic

## Ordering Information (Notes 3)

| Part Number   | Qualification | Case   | Packaging        |
|---------------|---------------|--------|------------------|
| DESD1P0RFW-7  | Commercial    | SOT323 | 3000/Tape & Reel |
| DESD1P0RFWQ-7 | Automotive    | SOT323 | 3000/Tape & Reel |

- Notes:
1. No purposefully added lead.
  2. Diodes Inc.'s "Green" Policy can be found on our website at <http://www.diodes.com>
  3. For Packaging Details, go to our website at <http://www.diodes.com>.

## Marking Information

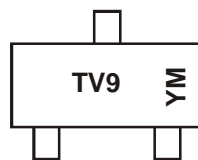

TV9 = Product Type Marking Code  
 YM = Date Code Marking  
 Y = Year (ex: Y = 2011)  
 M = Month (ex: 9 = September)

### Date Code Key

| Year | 2011 | 2012 | 2013 | 2014 | 2015 | 2016 | 2017 |
|------|------|------|------|------|------|------|------|
| Code | Y    | Z    | A    | B    | C    | D    | E    |

| Month | Jan | Feb | Mar | Apr | May | Jun | Jul | Aug | Sep | Oct | Nov | Dec |
|-------|-----|-----|-----|-----|-----|-----|-----|-----|-----|-----|-----|-----|
| Code  | 1   | 2   | 3   | 4   | 5   | 6   | 7   | 8   | 9   | O   | N   | D   |

**Maximum Ratings** @ $T_A = 25^\circ\text{C}$  unless otherwise specified

| Characteristic                     | Symbol             | Value    | Unit | Conditions                       |
|------------------------------------|--------------------|----------|------|----------------------------------|
| Peak Pulse Current                 | $I_{PP}$           | 15       | A    | 8/20 $\mu\text{s}$ (Notes 4 & 5) |
| ESD Protection – Contact Discharge | $V_{ESD\_Contact}$ | $\pm 30$ | kV   | Standard IEC 61000-4-2(Notes 5)  |
| ESD Protection – Air Discharge     | $V_{ESD\_Air}$     | $\pm 30$ | kV   | Standard IEC 61000-4-2(Notes 5)  |

**Thermal Characteristics**

| Characteristic                                      | Symbol          | Value       | Unit               |
|---|-----------------|-------------|--------------------|
| Power Dissipation (Note 6)                          | $P_D$           | 200         | mW                 |
| Thermal Resistance Junction to Ambient Air (Note 6) | $R_{\theta JA}$ | 625         | $^\circ\text{C/W}$ |
| Operating and Storage Temperature Range             | $T_J, T_{STG}$  | -65 to +150 | $^\circ\text{C}$   |

**Electrical Characteristics** @ $T_A = 25^\circ\text{C}$  unless otherwise specified

| Characteristic (Note 4)           | Symbol    | Min | Typ | Max | Unit | Test Conditions                                   |
|-----------------------------------|-----------|-----|-----|-----|------|---|
| Reverse Working Voltage           | $V_{RWM}$ | -   | -   | 70  | V    | -   |
| Reverse Current                   | $I_{RM}$  | -   | -   | 100 | nA   | $V_{RM} = 70\text{V}$                             |
| Forward Clamping Voltage (Note 5) | $V_{FC}$  | -   | 2   | 6   | V    | $I_{PP} = 3\text{A}$ ; per IEC 61000-4-5 (Note 7) |
|                                   |           | -   | 4   | 8   |      |   |
| Capacitance                       | $C_T$     | -   | 1   | 1.5 | pF   | $V_R = 0\text{V}, f = 1\text{MHz}$ (Note 8)       |

- Notes:
4. Diodes Short duration pulse test used to minimize self-heating effect.
  5. Anti-parallel or rail-to-rail connection
  6. Device mounted on FR-4 PCB with minimum recommended pad layout.
  7. Clamping voltage value is based on an 8x20  $\mu\text{s}$  peak pulse current ( $I_{pp}$ ) waveform.
  8. Total capacitance line to ground (2 diodes in parallel)

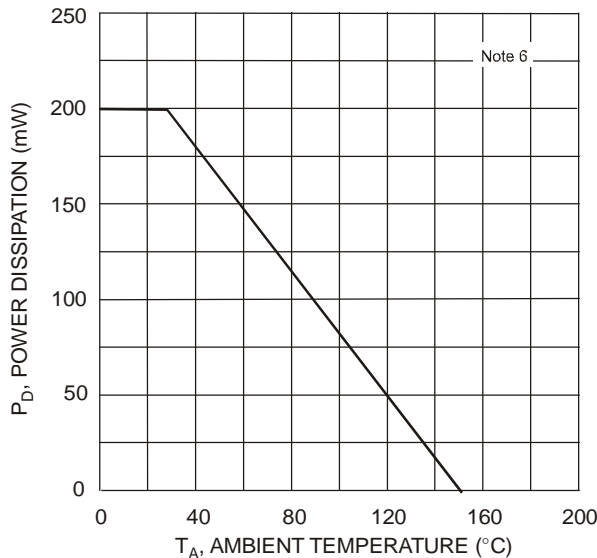

Fig. 1 Power Derating Curve, Total Package

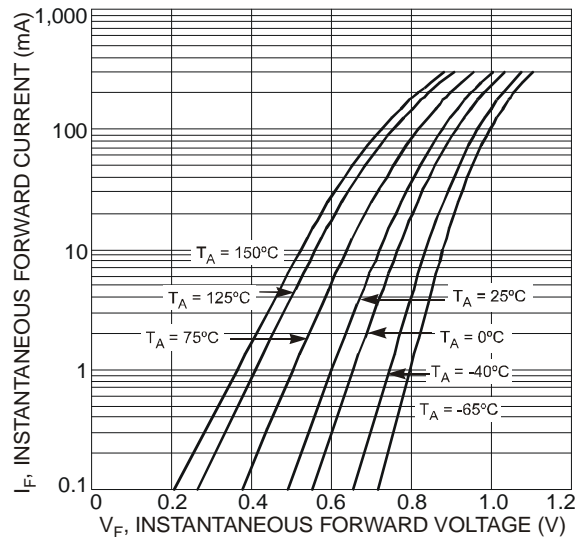

Fig. 2 Typical Forward Characteristics, Per Element

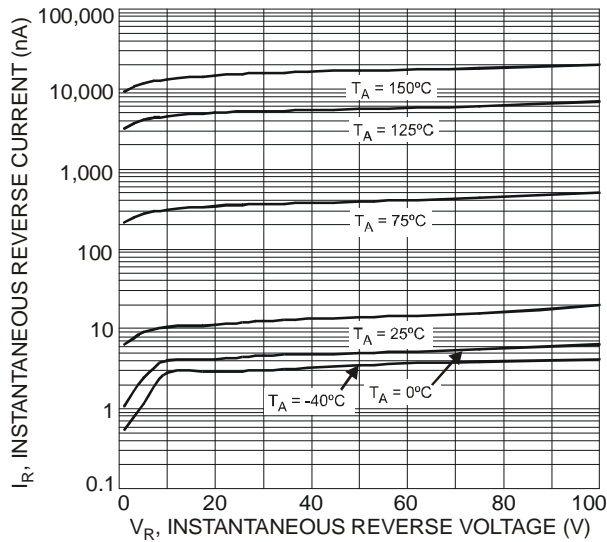

Fig. 3 Typical Reverse Characteristics, Per Element

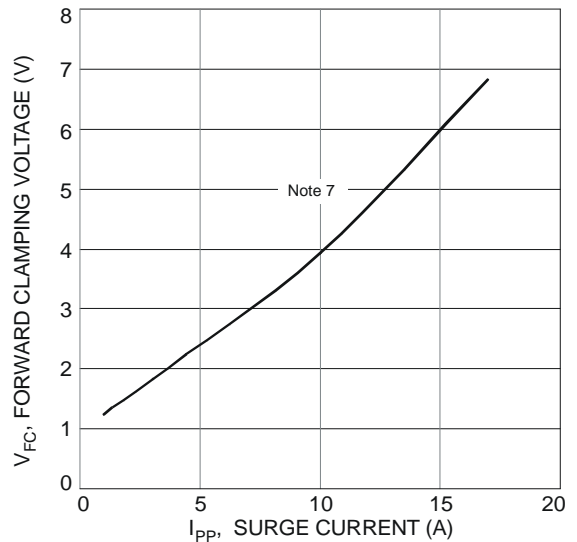
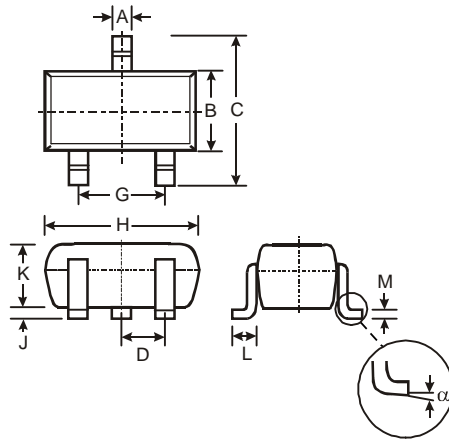

Fig. 4 Typical Forward Clamping Characteristics

**Package Outline Dimensions**



| SOT323               |      |      |      |
|----------------------|------|------|------|
| Dim                  | Min  | Max  | Typ  |
| A                    | 0.25 | 0.40 | 0.30 |
| B                    | 1.15 | 1.35 | 1.30 |
| C                    | 2.00 | 2.20 | 2.10 |
| D                    | -    | -    | 0.65 |
| G                    | 1.20 | 1.40 | 1.30 |
| H                    | 1.80 | 2.20 | 2.15 |
| J                    | 0.0  | 0.10 | 0.05 |
| K                    | 0.90 | 1.00 | 1.00 |
| L                    | 0.25 | 0.40 | 0.30 |
| M                    | 0.10 | 0.18 | 0.11 |
| $\alpha$             | 0°   | 8°   | -    |
| All Dimensions in mm |      |      |      |

**Suggested Pad Layout**

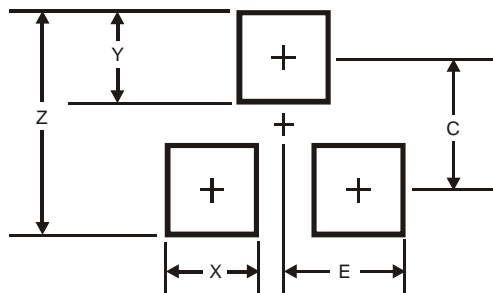

| Dimensions | Value (in mm) |
|------------|---------------|
| Z          | 2.8           |
| X          | 0.7           |
| Y          | 0.9           |
| C          | 1.9           |
| E          | 1.0           |

**IMPORTANT NOTICE**

DIODES INCORPORATED MAKES NO WARRANTY OF ANY KIND, EXPRESS OR IMPLIED, WITH REGARDS TO THIS DOCUMENT, INCLUDING, BUT NOT LIMITED TO, THE IMPLIED WARRANTIES OF MERCHANTABILITY AND FITNESS FOR A PARTICULAR PURPOSE (AND THEIR EQUIVALENTS UNDER THE LAWS OF ANY JURISDICTION).

Diodes Incorporated and its subsidiaries reserve the right to make modifications, enhancements, improvements, corrections or other changes without further notice to this document and any product described herein. Diodes Incorporated does not assume any liability arising out of the application or use of this document or any product described herein; neither does Diodes Incorporated convey any license under its patent or trademark rights, nor the rights of others. Any Customer or user of this document or products described herein in such applications shall assume all risks of such use and will agree to hold Diodes Incorporated and all the companies whose products are represented on Diodes Incorporated website, harmless against all damages.

Diodes Incorporated does not warrant or accept any liability whatsoever in respect of any products purchased through unauthorized sales channel. Should Customers purchase or use Diodes Incorporated products for any unintended or unauthorized application, Customers shall indemnify and hold Diodes Incorporated and its representatives harmless against all claims, damages, expenses, and attorney fees arising out of, directly or indirectly, any claim of personal injury or death associated with such unintended or unauthorized application.

Products described herein may be covered by one or more United States, international or foreign patents pending. Product names and markings noted herein may also be covered by one or more United States, international or foreign trademarks.

**LIFE SUPPORT**

Diodes Incorporated products are specifically not authorized for use as critical components in life support devices or systems without the express written approval of the Chief Executive Officer of Diodes Incorporated. As used herein:

A. Life support devices or systems are devices or systems which:

1. are intended to implant into the body, or
2. support or sustain life and whose failure to perform when properly used in accordance with instructions for use provided in the labeling can be reasonably expected to result in significant injury to the user.

B. A critical component is any component in a life support device or system whose failure to perform can be reasonably expected to cause the failure of the life support device or to affect its safety or effectiveness.

Customers represent that they have all necessary expertise in the safety and regulatory ramifications of their life support devices or systems, and acknowledge and agree that they are solely responsible for all legal, regulatory and safety-related requirements concerning their products and any use of Diodes Incorporated products in such safety-critical, life support devices or systems, notwithstanding any devices- or systems-related information or support that may be provided by Diodes Incorporated. Further, Customers must fully indemnify Diodes Incorporated and its representatives against any damages arising out of the use of Diodes Incorporated products in such safety-critical, life support devices or systems.

Copyright © 2011, Diodes Incorporated

**[www.diodes.com](http://www.diodes.com)**

## Looking for pricing, stock, or lifecycle information?

Click below to explore more details on WIN SOURCE:

 [View DESD1P0RFWQ-7 on WIN SOURCE](#)

 [Diodes Incorporated](#) Information

## Optimize Your Supply Chain with WIN SOURCE Solutions

-  Global Sourcing Solution
-  Obsolete Management
-  Cost Control Management
-  Shortage Management
-  Alternative Solution
-  Excess Inventory Management