

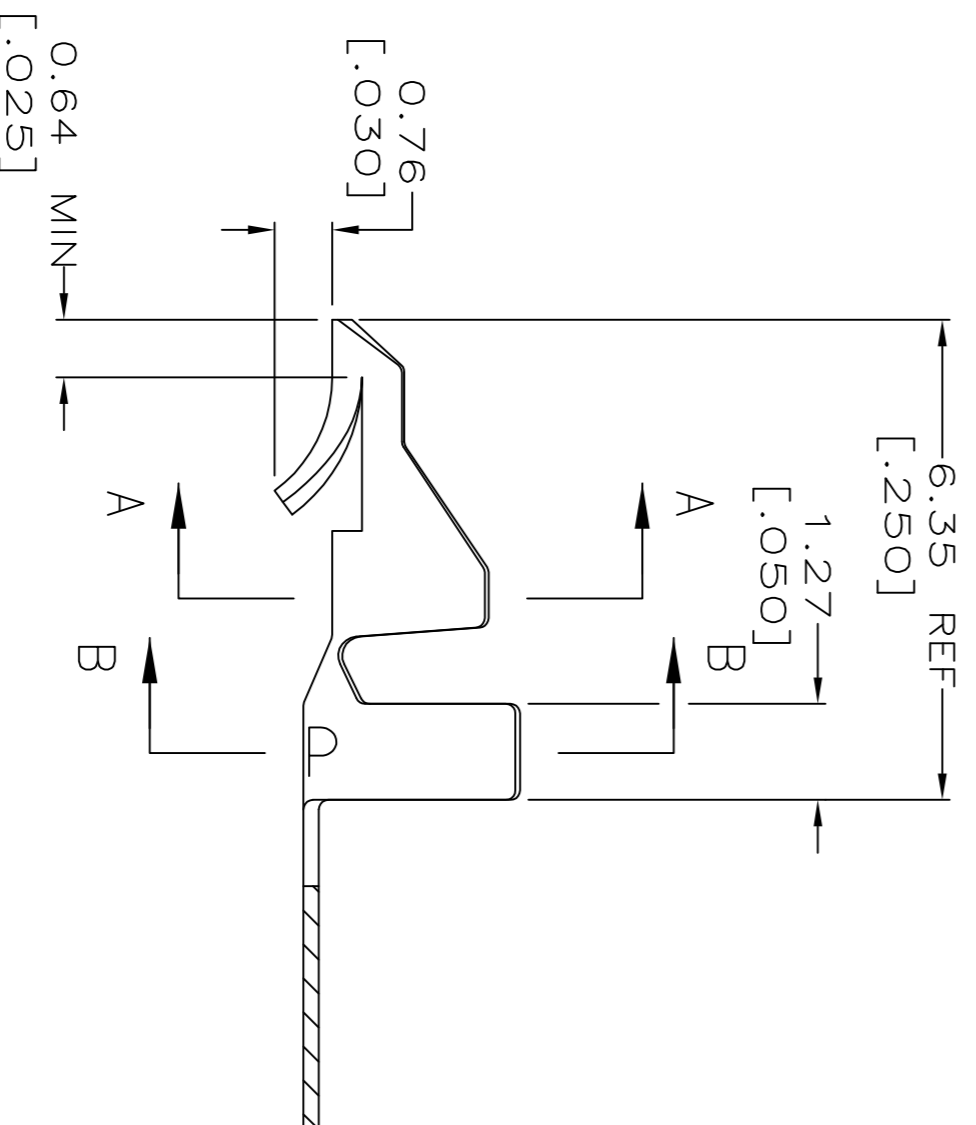

THE DATASHEET OF
350566-7

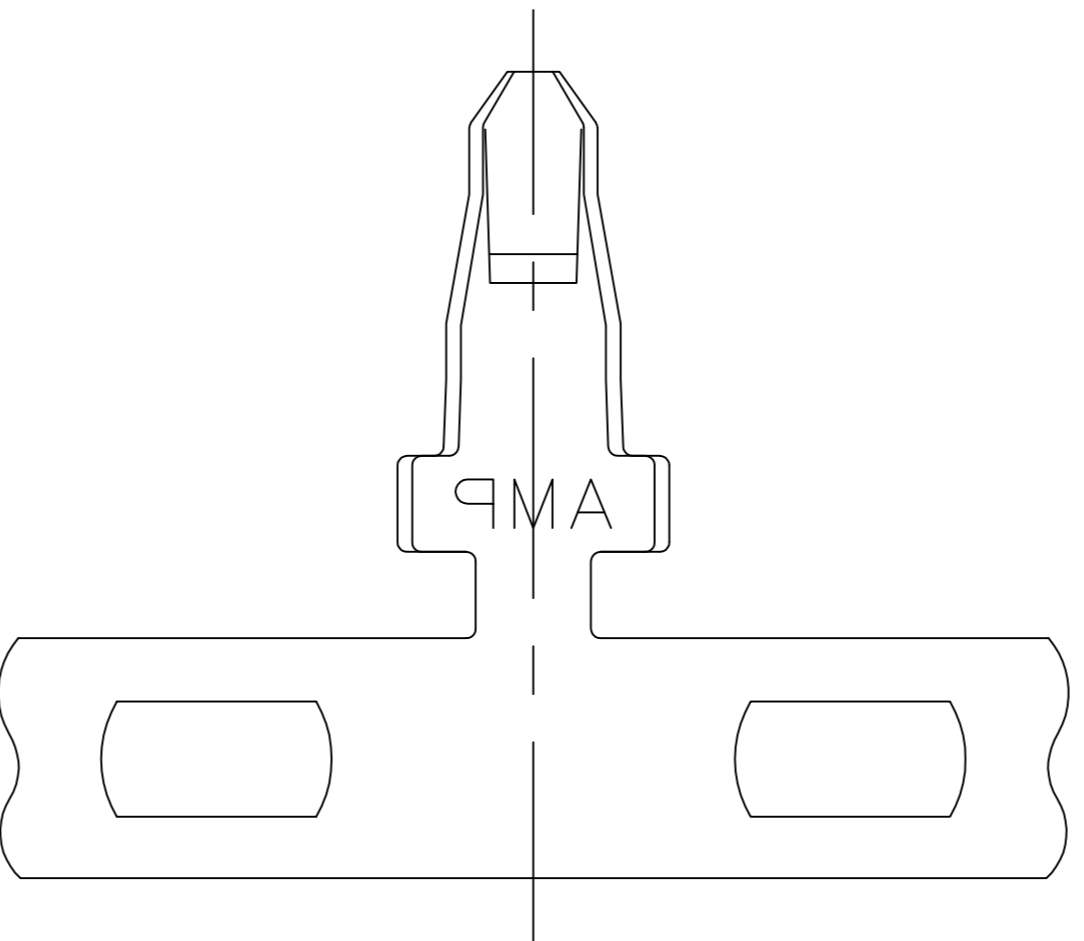

REVISIONS					
P	LTR	DESCRIPTION	DATE	DMN	AP/ID
ABS	REVISED PER ECR-17-013215		18SEP17	J.Z	D.Z



- 1 PARTS COMPLY WITH AMP SOLDERABILITY SPEC 109-11-3.
- 2 PARTS COMPLY WITH AMP SOLDERABILITY SPEC 109-11-5.
- 3 PARTS COMPLY WITH AMP SOLDERABILITY SPEC 109-11-1.
- 4 HOLE DIAMETER TO BE 1.83±0.08 FOR WIRE 0.3-0.6mm2 (20-22 AWG) OR 1.96±0.08 FOR WIRE 0.8-0.9mm2 (18 AWG).
- 5 CARRIER STRIP TO HAVE 1.52 [.060] DIA PILOT HOLE.
- 6 0.00508 [.000200] MIN BRIGHT TIN-LEAD.
- 7 0.00318 [.000150] MIN MATTIE TIN-LEAD OVER
0.00305 [.000120] MIN MATTIE COPPER.
- 8 0.00305 [.000120] MIN TIN OVER
0.00102 [.000040] MIN NICKEL.
- 9 WIRE RANGE: 0.3 -0.9 mm² (22 - 18 AWG).
- 10 INSULATION RANGE: 1.52 - 2.79 [.060 - .110] DIA.
- 11 DIMENSIONS IN BRACKETS ARE IN INCHES.
- 12 0.00508 [.000200] MIN BRIGHT TIN.

1	12	0.20[.008] PH BRZ	3-350566-1
3	8	0.20[.008] BRASS	350566-7
5	8	0.20[.008] BRASS	350566-5
3	8	0.20[.008] BRASS	350566-3
2	8	0.20[.008] BRASS	350566-1
1	12	0.20[.008] PH BRZ	350566-1
NOTES		FINISH	PART NO.
MATERIAL		MATERIAL	

THIS DRAWING IS A CONTROLLED DOCUMENT.

DMN S. CARPENTER 20AUG2003
CHK J. ELLIS 20AUG2003

AP/ID J. ELLIS 20AUG2003
Product SPEC

DIMENSIONS:
INCHES

TOLERANCES UNLESS
OTHERWISE SPECIFIED:

0 P/C ±
1 P/C ±
2 P/C ±
3 P/C ± 0.13 [.005]
4 P/C ±
ANGLES ±

MATERIAL
SEE TABLE

FINISH
SEE TABLE

APPLICATION SPEC
WEIGHT 0.000000

SIZE A2
CAGE CODE 00779
DRAWING NO. 350566

SCALE 10:1

SHEET 1 of 1

REV ABS

METRIC

MINI AMP-IN (TM)

STE TE Connectivity

Looking for pricing, stock, or lifecycle information?

Click below to explore more details on WIN SOURCE:

- [View 350566-7 on WIN SOURCE](#)
- [TE Connectivity Information](#)

Optimize Your Supply Chain with WIN SOURCE Solutions

- ✓ Global Sourcing Solution
- ✓ Obsolete Management
- ✓ Cost Control Management
- ✓ Shortage Management
- ✓ Alternative Solution
- ✓ Excess Inventory Management