



**THE DATASHEET OF
971-SLR-SMD-1.1/08**



971-SLR-SMD-1,1

Pin strip for SMD
Plug-in area \varnothing 1,1 mm

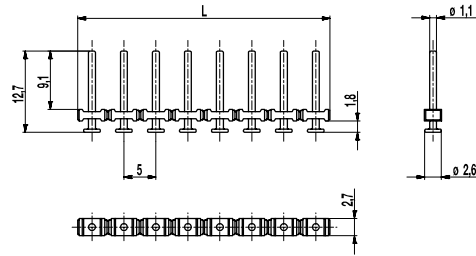

PCB LAYOUT

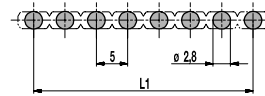

$L1 = (\text{No. of poles} - 1) \times \text{pitch}$
Solder paste thickness: 0,15 - 0,2 mm

GENERAL INFORMATION

Pitch	5 mm
No. of poles	2 - 12
Usable with	plug connectors of series 115-F-.../...-1,1-SW; 950-FL-DS, 950-TFL-DS, 950-NAF-DS, 950-GFL-DS, 950-NLFL-DS, 950-RFL-DS

TECHNICAL DATA

Overvoltage Category	III	III	II
Pollution Severity Level	3	2	2
Rated Voltage	160 V	160 V	320 V
Rated Impulse Voltage	2,5 kV	2,5 kV	2,5 kV
Rated Insulation Voltage	130 V acc. to EN 60998-1		
Rated Current	10 A		
Soldering process	Reflow solder		

APPROVALS

	Current [A]	Voltage [V]	Group	AWG	[Nm]
	10 [1]	300	B		
	10	300	B		

MATERIAL

Moulding	PA HT, black, V-0
Comparative Tracking Index	CTI \geq 600
Insulating Group	I
Temperature Range	-40°C up to 120°C; reflow solder temperature peak max. 255°C acc. to DIN EN 61760-1
Solder pin	\varnothing 1,1 mm (plug-in area); tin plated brass

OPTIONS / ACCESSORIES

- Other plug pin lengths on request
- Other solder pin surfaces on request

[1] Above headers with 1.0 or 1.1 mm dia. pins are rated 12A max. with manufacturer's Cat. No. 120-W-111 terminal blocks. Above headers with 1.1 mm or 1.3 mm dia. pins are rated 12A max. with 115-F-111, 115-F-211 and 115-F-118 terminal blocks.

CONFIGURATIONS

Poles	Part number	Article number	Length (L)	Packaging	PU	Tape Width	Tape Height
2	971-SLR-SMD-1,1/02	12.893.822	9,50 mm	Box	1000		
3	971-SLR-SMD-1,1/03	13.893.822	14,50 mm	Box	500		
4	971-SLR-SMD-1,1/04	14.893.822	19,50 mm	Box	500		
5	971-SLR-SMD-1,1/05	15.893.822	24,50 mm	Box	250		
6	971-SLR-SMD-1,1/06	16.893.822	29,50 mm	Box	250		
2	971-SLR-SMD-1,1/02-T&R	12.893.822.A00	9,50 mm	Tape-on-Reel	500	32 mm	15,9 mm
3	971-SLR-SMD-1,1/03-T&R	13.893.822.A00	14,50 mm	Tape-on-Reel	500	32 mm	15,9 mm
4	971-SLR-SMD-1,1/04-T&R	14.893.822.A00	19,50 mm	Tape-on-Reel	500	56 mm	15,9 mm
5	971-SLR-SMD-1,1/05-T&R	15.893.822.A00	24,50 mm	Tape-on-Reel	500	56 mm	15,9 mm
6	971-SLR-SMD-1,1/06-T&R	16.893.822.A00	29,50 mm	Tape-on-Reel	500	56 mm	15,9 mm

further number of poles on request



Looking for pricing, stock, or lifecycle information?

Click below to explore more details on WIN SOURCE:

- [View 971-SLR-SMD-1.1/08 on WIN SOURCE](#)
- [WECO Electrical Connectors Inc. Information](#)

Optimize Your Supply Chain with WIN SOURCE Solutions

- ✓ Global Sourcing Solution
- ✓ Obsolete Management
- ✓ Cost Control Management
- ✓ Shortage Management
- ✓ Alternative Solution
- ✓ Excess Inventory Management