



**THE DATASHEET OF
2002**





.250 (6.4) "STURDI-MOUNT" PC QUICK-FIT HEADERS

AVAILABLE IN BRASS OR STEEL TABS

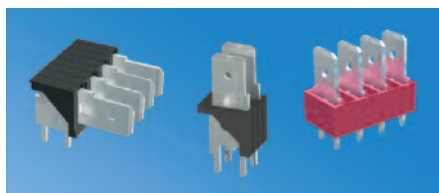

- Ideal for rugged multi-insertion applications
- Pre-assembled header reduces PC assembly costs
- Increases PC board retention strength
- Keeps terminals perpendicular
- Maintains position for wave soldering

SPECIFICATIONS

- Material:** .032 (.80) Brass or Steel, Tin Plated
- Insulator:** Thermoplastic, UL Rated 94V-0
- Current Rating:** 15 Amps @ 500V AC
- Temperature Rating:** -58°F to +292°F (-50°C to +145°C)

HORIZONTAL

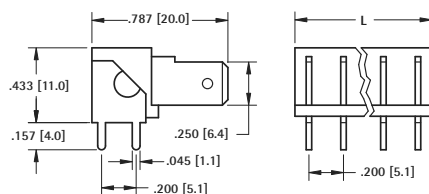

| BRASS TABS CAT. NO. | STEEL TABS CAT. NO. | NO. OF TABS | L DIM. |
|------------------------|------------------------|-------------|--------------|
| 7802 | 7822 | 2 | .362 (8.2) |
| 7803 | 7823 | 3 | .562 (14.3) |
| 7804 | 7824 | 4 | .762 (19.4) |
| 7805 | 7825 | 5 | .962 (24.4) |
| 7806 | 7826 | 6 | 1.162 (29.5) |

VERTICAL

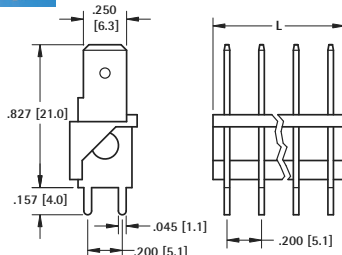

| BRASS TABS CAT. NO. | STEEL TABS CAT. NO. | NO. OF TABS | L DIM. |
|------------------------|------------------------|-------------|--------------|
| 7812 | 7832 | 2 | .362 (8.2) |
| 7813 | 7833 | 3 | .562 (14.3) |
| 7814 | 7834 | 4 | .762 (19.4) |
| 7815 | 7835 | 5 | .962 (24.4) |
| 7816 | 7836 | 6 | 1.162 (29.5) |

LOW PROFILE

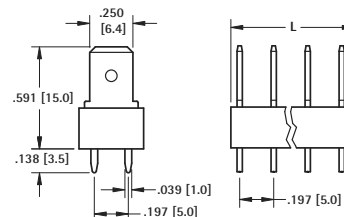
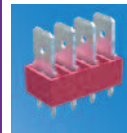

| BRASS TABS CAT. NO. | STEEL TABS CAT. NO. | NO. OF TABS | L DIM. |
|------------------------|------------------------|-------------|--------------|
| 7817 | 7827 | 2 | .320 (8.1) |
| 7818 | 7828 | 3 | .517 (13.1) |
| 7819 | 7829 | 4 | .713 (18.1) |
| 7820 | 7830 | 5 | .910 (23.1) |
| 7821 | 7831 | 6 | 1.107 (28.1) |

RIVET MOUNT QUICK-FIT TERMINALS



- UL recognized bright brass Quick-Fit terminals
- Rivet mount male tab versions meet NEMA 2-E201546 & UL 310 specifications
- Designed for repeated mating cycles
- For tabs 0.110 (2.8mm) to 0.250 (6.4mm)

.110 (2.8) - .187 (4.8) - .250 (6.4) TABS

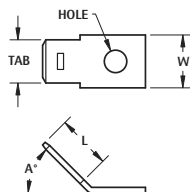
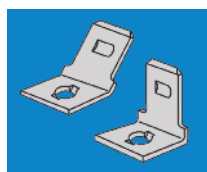

.110 (2.8) - .187 (4.8) - .250 (6.4) TABS

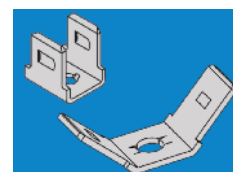
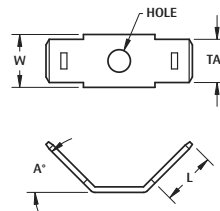

| BRIGHT BRASS | | | | | | | MATTE TIN | | | |
|---------------------|---------------------|------------|-------------|------------|------------|------------|---------------------|---------------------|--|--|
| A = 45° CAT. NO. | A = 90° CAT. NO. | TAB SIZE | MAT'L THICK | L TAB | W WIDTH | HOLE DIA. | A = 45° CAT. NO. | A = 90° CAT. NO. | | |
| 2004 | 2002 | .110 (2.8) | .020 (.51) | .283 (7.2) | .180 (4.6) | .096 (2.4) | 1233 | 1220 | | |
| 1271 | 1261 | .187 (4.8) | .020 (.51) | .250 (6.4) | .250 (6.4) | .100 (2.5) | 1234 | 1221 | | |
| 1280 | 1256 | .250 (6.4) | .032 (.81) | .312 (7.9) | .306 (7.8) | .130 (3.3) | 1235 | 1222 | | |

| BRIGHT BRASS | | | | | | | MATTE TIN | | | |
|---------------------|---------------------|------------|-------------|------------|------------|------------|---------------------|---------------------|--|--|
| A = 45° CAT. NO. | A = 90° CAT. NO. | TAB SIZE | MAT'L THICK | L TAB | W WIDTH | HOLE DIA. | A = 45° CAT. NO. | A = 90° CAT. NO. | | |
| 2005 | 2003 | .110 (2.8) | .020 (.51) | .283 (7.2) | .180 (4.6) | .096 (2.4) | 1240 | 1227 | | |
| 1263 | 1262 | .187 (4.8) | .020 (.51) | .250 (6.4) | .250 (6.4) | .100 (2.5) | 1241 | 1228 | | |
| 1258 | 1257 | .250 (6.4) | .032 (.81) | .312 (7.9) | .306 (7.8) | .130 (3.3) | 1242 | 1229 | | |

.110 (2.8) TAB

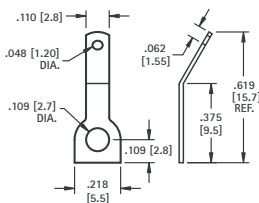

MATERIAL: .020 (.51) Brass, Tin Plate

| CAT. NO. | ANGLE |
|----------|-------|
| 1269 | 0° |
| 1270 | 30° |

.187 (4.8) - .205 (6.4) TABS

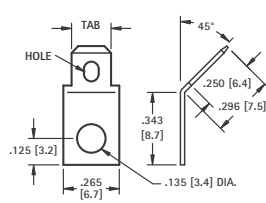

45° TAB MATERIAL: .020 (.51) Brass, Tin Plate

| CAT. NO. | TAB | HOLE |
|----------|------------|-------------------------------|
| 4005 | .205 (5.2) | .132 (3.4) x .070 (1.78) Slot |
| 4095 | .187 (4.7) | .078 (1.98) Dia. Hole |

MULTIPLE .250 (6.4) TAB

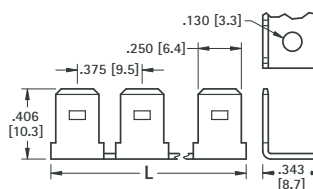
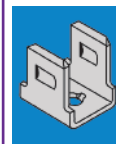



BRIGHT BRASS MATERIAL: .032 (.81) Bright Brass

| CAT. NO. | PAIRS | L | TAB SIZE |
|----------|-------|--------------|------------|
| 1005 | 2 | .687 (17.4) | .250 (6.4) |
| 1006 | 3 | 1.062 (27.0) | |
| 1007 | 4 | 1.441 (36.6) | |
| 1008 | 5 | 1.820 (46.2) | |



Looking for pricing, stock, or lifecycle information?

Click below to explore more details on WIN SOURCE:

-  [View 2002](#) on WIN SOURCE
-  [Keystone Electronics](#) Information

Optimize Your Supply Chain with WIN SOURCE Solutions

-  Global Sourcing Solution
-  Obsolete Management
-  Cost Control Management
-  Shortage Management
-  Alternative Solution
-  Excess Inventory Management