



**THE DATASHEET OF
CDRH60D43RNP-150MC**



SMD Power Inductor CDRH60D43R



Description

- Ferrite drum core construction
- Magnetically shielded
- L × W × H: 6.3 × 6.3 × 4.5 mm Max.
- Product weight: 0.55g(Ref.)
- Moisture Sensitivity Level: 1
- RoHS compliance.

Environmental Data

- Operating temperature range: -40°C ~ +105°C (including coil's self temperature rise)
- Storage temperature range: -40°C ~ +105°C
- Solder reflow temperature: 260 °C peak.

Packaging

- Carrier tape and reel packaging
- 13.0" diameter reel
- 1500pcs per reel

Applications

- Ideally used in slim TV, car navigation etc as DC-DC converter inductors.

Dimension - [mm]

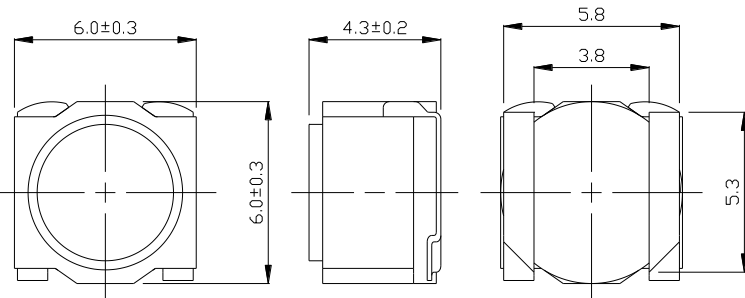

Land pattern and Schematics - [mm]

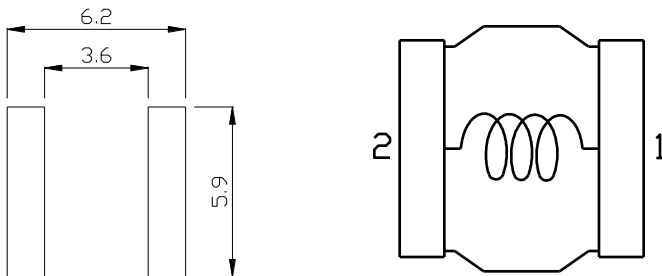



Electrical Characteristics

Part No.	Stamp	Inductance (μH) [Within] ※1	D.C.R. ($\text{m}\Omega$) [within](at 20°C)	Saturation current (A) ※2		Temperature rise current (A) ※3
				(at 20°C)	(at 105°C)	
CDRH60D43RNP-1R5NC	B	$1.5 \pm 30\%$	$15 \pm 25\%$	5.80	4.80	5.20
CDRH60D43RNP-2R2NC	C	$2.2 \pm 30\%$	$17 \pm 25\%$	4.80	4.00	4.40
CDRH60D43RNP-3R3NC	D	$3.3 \pm 30\%$	$22 \pm 25\%$	4.40	3.60	4.10
CDRH60D43RNP-4R7MC	E	$4.7 \pm 20\%$	$26 \pm 25\%$	3.50	2.80	3.80
CDRH60D43RNP-6R8MC	F	$6.8 \pm 20\%$	$31 \pm 25\%$	3.10	2.50	3.45
CDRH60D43RNP-100MC	G	$10 \pm 20\%$	$38 \pm 25\%$	2.60	2.00	2.90
CDRH60D43RNP-150MC	H	$15 \pm 20\%$	$78 \pm 25\%$	2.10	1.60	1.98
CDRH60D43RNP-220MC	J	$22 \pm 20\%$	$118 \pm 20\%$	1.80	1.30	1.55
CDRH60D43RNP-330MC	K	$33 \pm 20\%$	$178 \pm 20\%$	1.45	1.12	1.33
CDRH60D43RNP-470MC	L	$47 \pm 20\%$	$270 \pm 20\%$	1.20	0.90	1.04
CDRH60D43RNP-680MC	M	$68 \pm 20\%$	$325 \pm 20\%$	1.00	0.75	0.90
CDRH60D43RNP-101MC	N	$100 \pm 20\%$	$415 \pm 20\%$	0.85	0.66	0.82
CDRH60D43RNP-151MC	P	$150 \pm 20\%$	$670 \pm 20\%$	0.68	0.52	0.65
CDRH60D43RNP-221MC	Q	$220 \pm 20\%$	$1030 \pm 20\%$	0.56	0.44	0.49
CDRH60D43RNP-331MC	R	$330 \pm 20\%$	$1325 \pm 20\%$	0.47	0.38	0.45

※1 Measuring condition Inductance at 100kHz .

※2 Saturation current: The value of DC current when the inductance decreases to 70% of its nominal.

※3 Temperature rise current: The value of DC current when the temperature rise is $\Delta T=40^\circ\text{C}$ ($T_a=20^\circ\text{C}$).

SMD Power Inductor CDRH60D43R



Saturation Current & Temperature Rise Graph

— L (20°C) — L (105°C) — ΔT

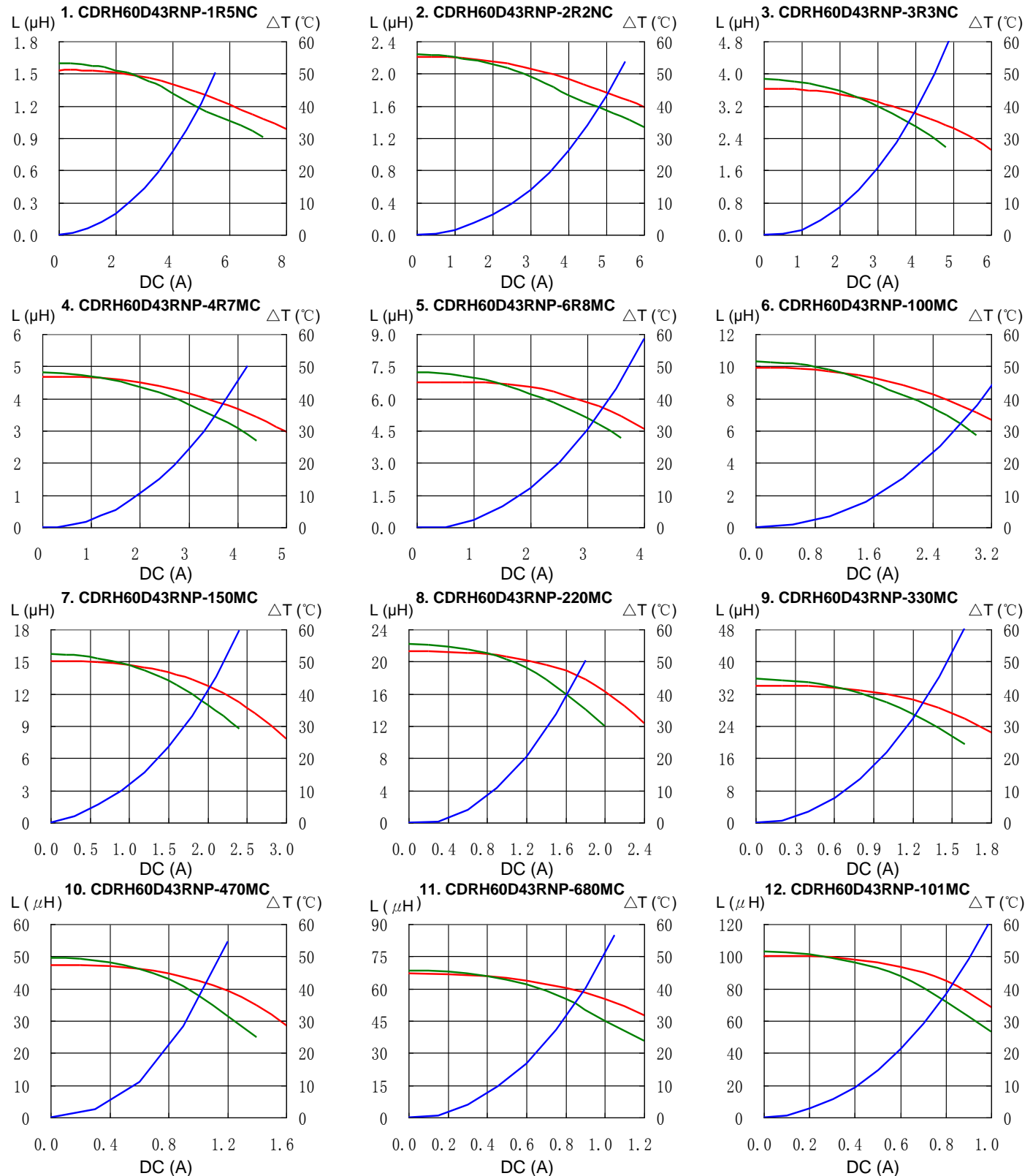

SMD Power Inductor CDRH60D43R

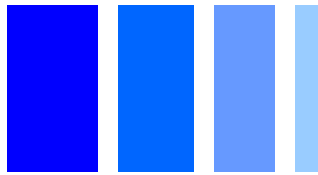

Saturation Current & Temperature Rise Graph

— L (20°C) — L (105°C) — ΔT

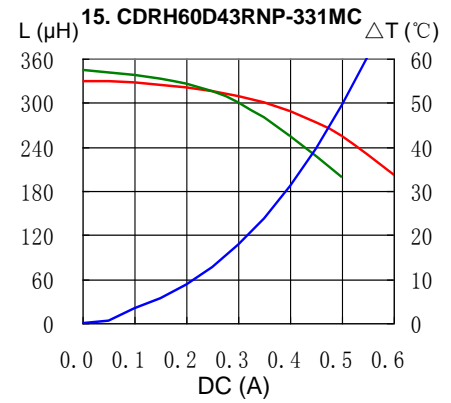
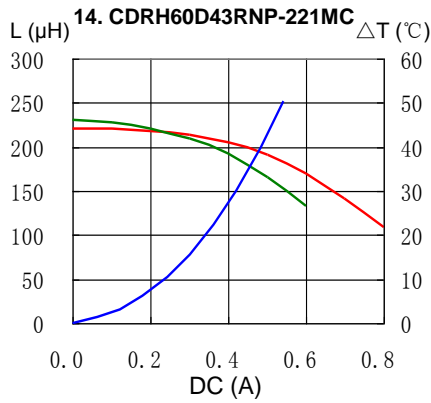
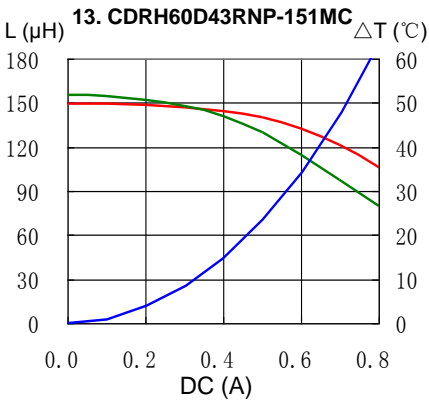

Solder Reflow Condition

Heat Endurance

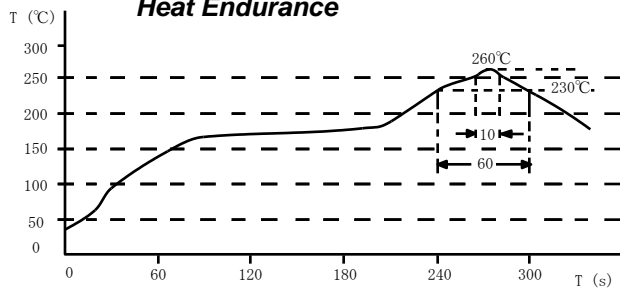

Temperature Chart

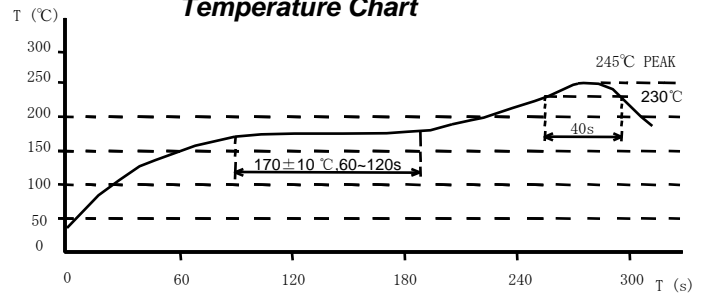

Please refer to the sales offices on our website - <http://www.sumida.com>

Hong Kong

Tel.+852-2880-6781
FAX.+852-2565-9600
sales@hk.sumida.com

Saitama(Japan)

Tel.+81-48-691-7300
FAX.+81-48-691-7340
sales@jp.sumida.com

Chicago

Tel.+1-847-545-6700
FAX. +1-847-545-6720
sales@us.sumida.com

Shanghai

Tel.+86-21-5836-3299
FAX.+86-21-5836-3266
shanghai.sales@cn.sumida.com

Seoul

Tel.+82-2-6237-0777
FAX.+82-2-6237-0778
sales@kr.sumida.com

Obernzell

Tel.+49-8591-937-0
FAX. +49-8591-937-103
contact@eu.sumida.com

Shenzhen

Tel.+86-755-8291-0228
FAX.+86-755-8291-0338
shenzhen.sales@cn.sumida.com

Singapore

Tel.+65-6296-3388
FAX.+65-6841-4426
sales@sg.sumida.com

Neumarkt

Tel.+49-9181-4509-110
FAX. +49-9181-4509-310
infocomp@eu.sumida.com

Taipei

Tel.+886-2-8751-2737
FAX.+886-2-8751-2738
sales@tw.sumida.com

San Jose

Tel.+1-408-321-9660
FAX.+1-408-321-9308
sales@us.sumida.com

Looking for pricing, stock, or lifecycle information?

Click below to explore more details on WIN SOURCE:

- ⊖ [View CDRH60D43RNP-150MC on WIN SOURCE](#)
- ⊖ [Sumida America Components Inc. Information](#)

Optimize Your Supply Chain with WIN SOURCE Solutions

- ✓ Global Sourcing Solution
- ✓ Obsolete Management
- ✓ Cost Control Management
- ✓ Shortage Management
- ✓ Alternative Solution
- ✓ Excess Inventory Management