



# THE DATASHEET OF SF2472E



- **Low-loss UHF SAW Filter**
- **3.0 x 3.0 mm Surface-mount Package**
- **Complies with Directive 2002/95/EC (RoHS)**
- **Moisture Sensitivity Level: 1**
- **AEC-Q200 Qualified**

**Maximum Rating**

Rating	Value	Units
DC Voltage on any Non-ground Terminal	3	V
Input Power Level: Pass Band:	33	dBm
Stop Band:	15	dBm
Operable Temperature Range	-45 to +125	°C
Specification Temperature Range	0 to +50	°C
Storage Temperature Range	-40 to +85	°C

**SF2472E**

**869 MHz  
SAW Filter**

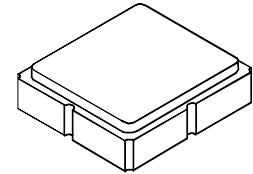

**SM3030-8**

Characteristic	Sym	Notes	Min	Typ	Max	Units
Center Frequency	$f_C$			869		MHz
Maximum Insertion Loss, 698 to 862 MHz (0 to +25°C) (+25 to +50°C)  880 to 960 MHz  1710 to 1880 MHz  2110 to 2690 MHz	$IL_{MAX}$			1.9	2.5	dB
				1.9	2.9	
				1.0	2.5	
				1.7	2.5	
Attenuation, 0 dB Reference: 868 to 870 MHz			20	24		dB
Temperature Coefficient of frequency				-36		ppm/k
Source Impedance $Z_S$				50		ohm
Load Impedance $Z_L$				50		

Case Style	SM3030-8 3.0 x 3.0 mm Nominal Footprint
Lid Symbolization, Y=year, WW=week, S=shift, dot=pin 1 indicator	B7_YWWS
Standard Reel Quantity	500 Pieces/Reel
Reel Size 7 inch	
Reel Size 13 inch	3000 Pieces/Reel

Electrical Connections	
Input	2
Output	6
All Others - Ground	1, 3, 4, 5, 7, 8

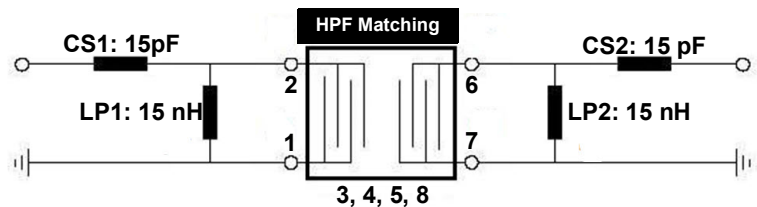

**CAUTION: Electrostatic Sensitive Device. Observe precautions for handling.**

**NOTES:**

1. The design, manufacturing process, and specifications of this device are subject to change.
2. US or International patents may apply.
3. RoHS compliant from the first date of manufacture.

# Transfer Function

Span: 100 MHz

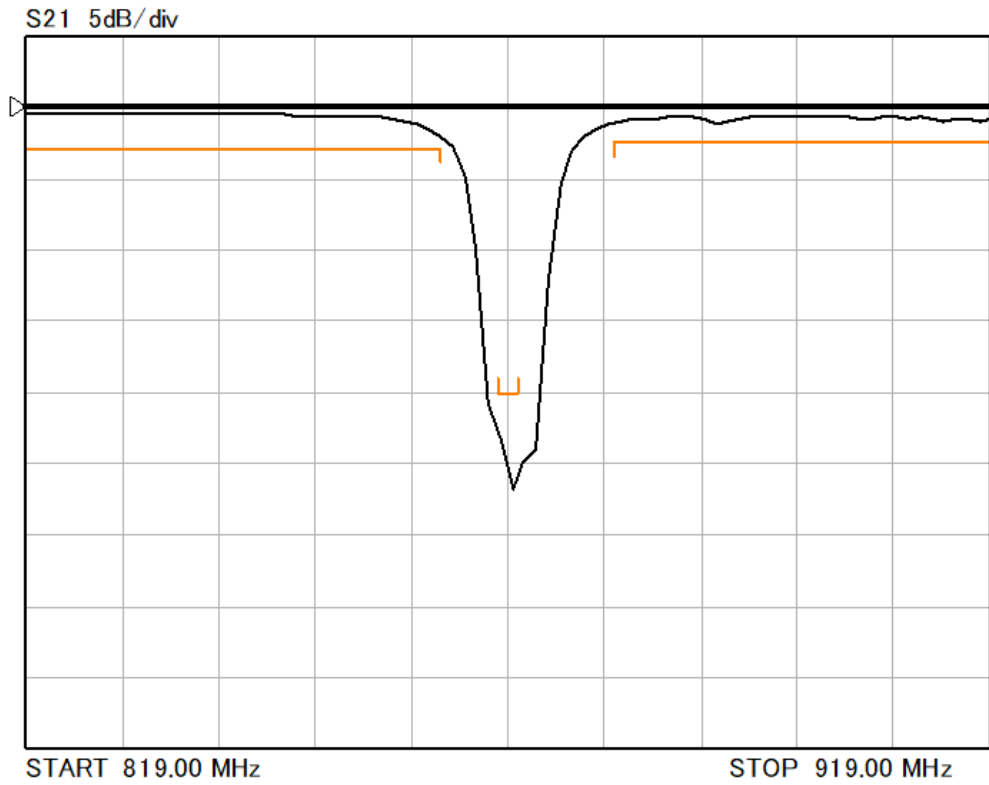

Span: 2000 MHz

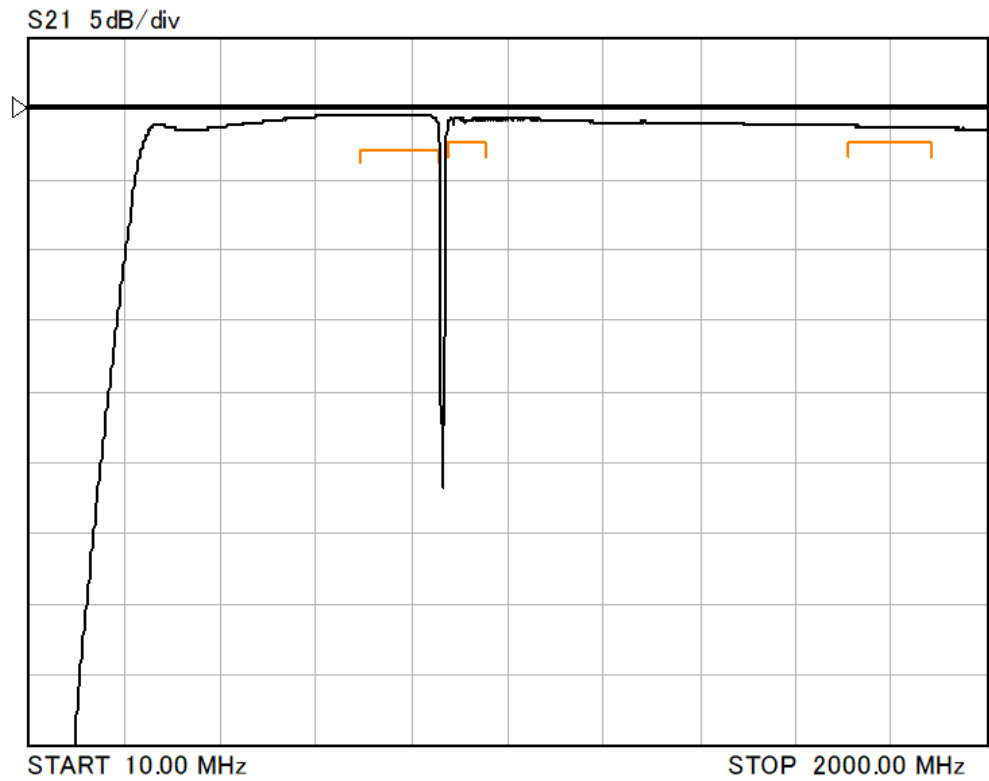

# Frequency Response Plot

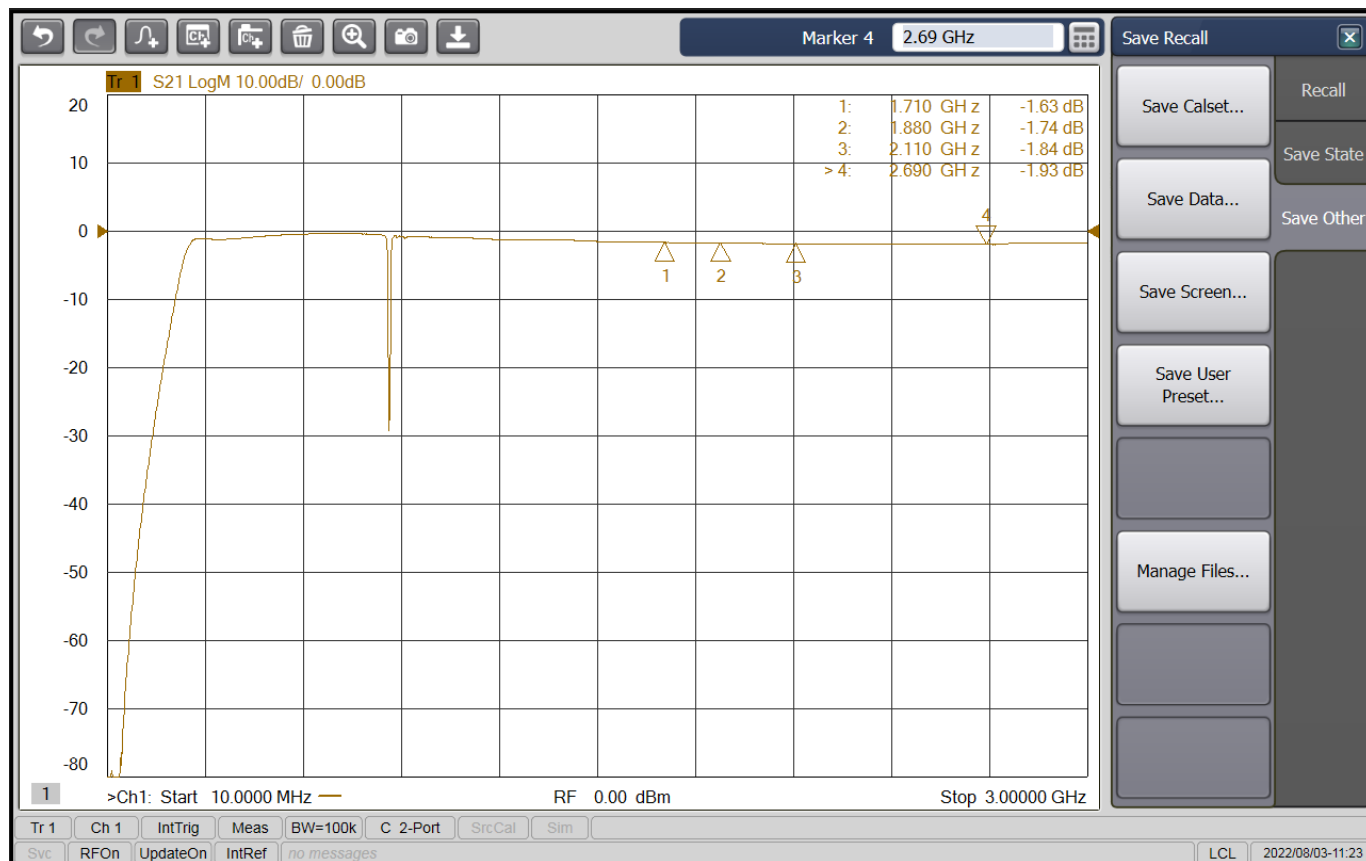

## 8-Terminal Ceramic Surface-Mount Case 3.0 x 3.0 mm Nominal Footprint

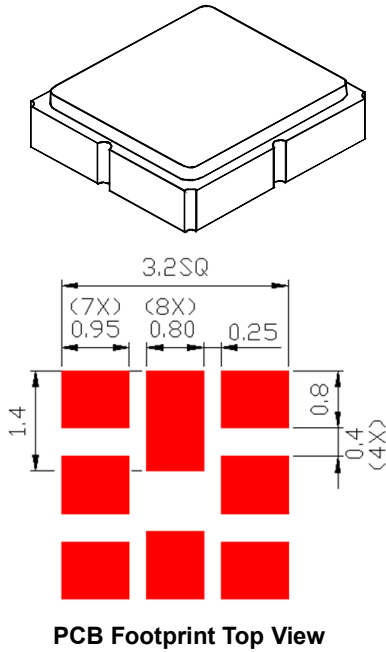

**Case and PCB Footprint Dimensions**

Dimension	mm			Inches		
	Min	Nom	Max	Min	Nom	Max
<b>A</b>	2.90	3.00	3.10	0.114	0.118	0.122
<b>B</b>	2.90	3.00	3.10	0.114	0.118	0.122
<b>C</b>	0.90	1.00	1.10	0.035	0.039	0.043
<b>D</b>	0.79	0.92	1.05	0.031	0.036	0.041
<b>E</b>	0.62	0.75	0.88	0.024	0.029	0.034
<b>F</b>	0.47	0.60	0.73	0.018	0.023	0.028
<b>G</b>	0.50	0.60	0.70	0.019	0.023	0.027
<b>H</b>	1.10	1.20	1.30	0.043	0.047	0.051

**Case Materials**

Materials	
Solder Pad Plating	0.3 to 1.0 $\mu\text{m}$ Gold over 1.27 to 8.89 $\mu\text{m}$ Nickel
Lid Plating	2.0 to 3.0 $\mu\text{m}$ Nickel
Body	$\text{Al}_2\text{O}_3$ Ceramic

TOP VIEW

BOTTOM VIEW

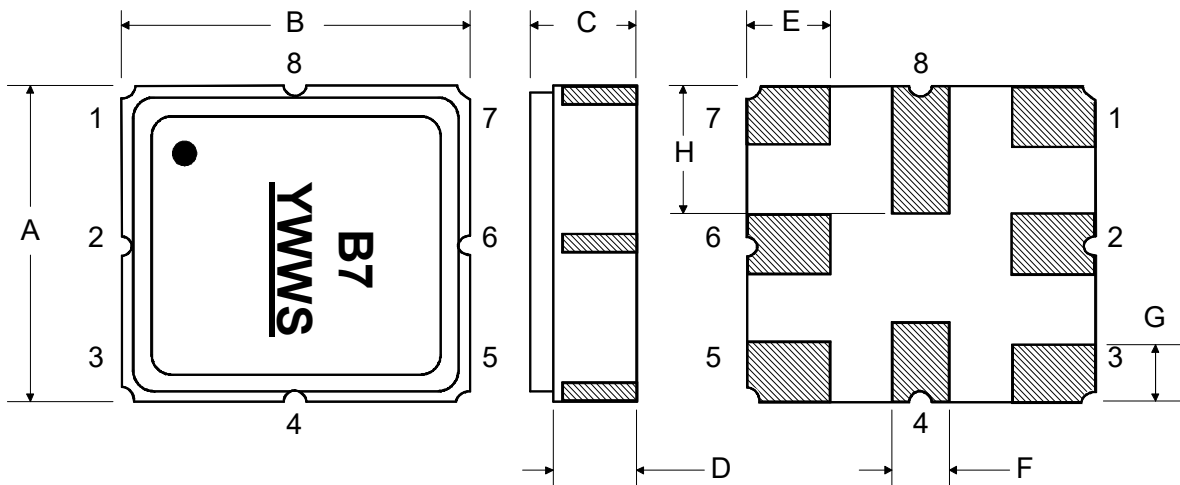

# Tape and Reel Specifications

Tape and Reel Standard per ANSI/EIA481

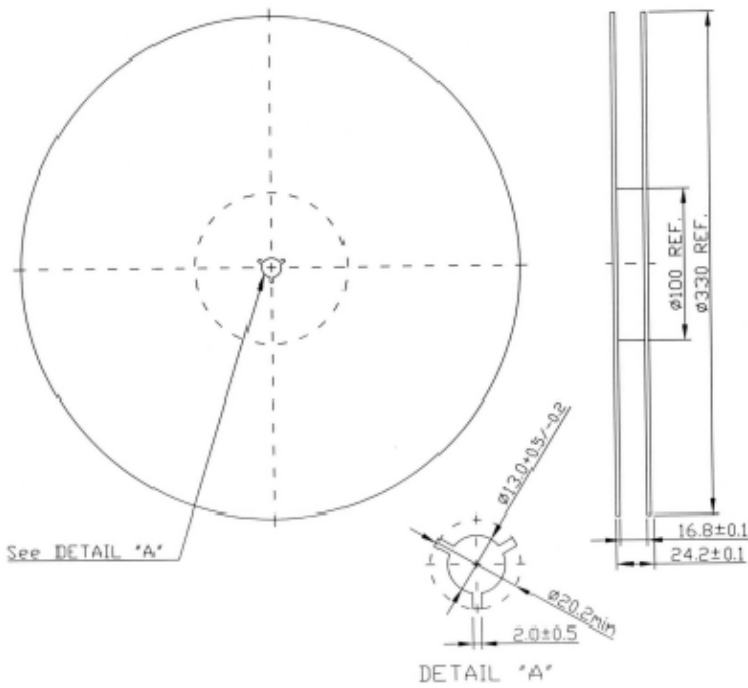

"B"		Quantity Per Reel
Nominal Size		
Inches	millimeters	
7	178	500
13	330	3000

Carrier Tape Dimensions	
Ao	3.35 mm
Bo	3.35 mm
Ko	1.4 mm
Pitch	8.0 mm
W	12.0 mm

## COMPONENT ORIENTATION and DIMENSIONS

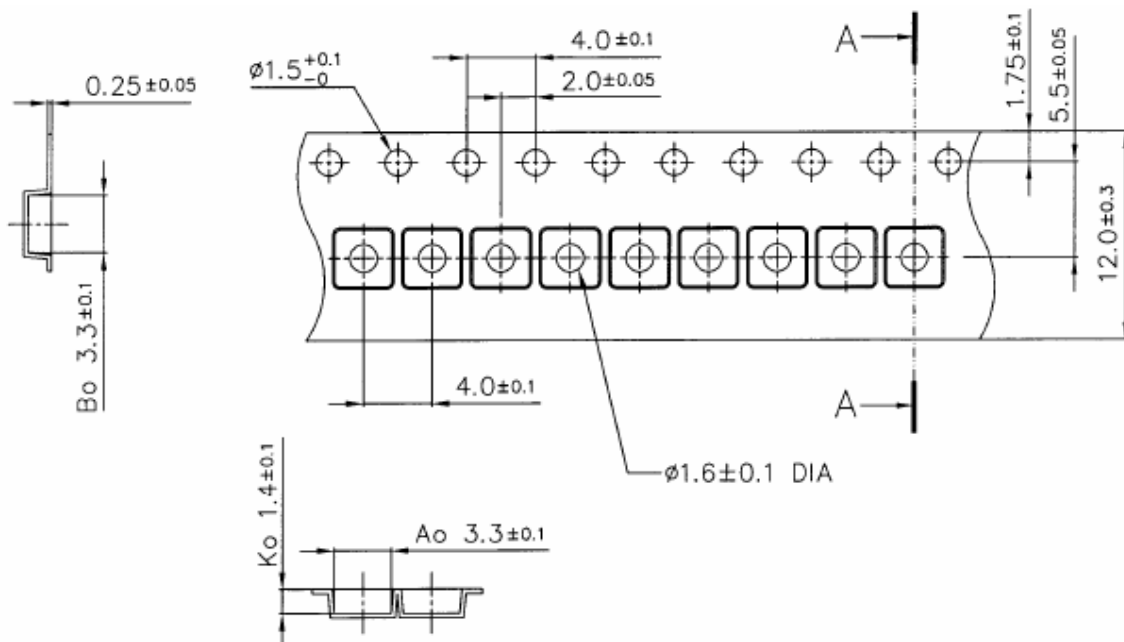

## Recommended Reflow Profile

1. Preheating shall be fixed at 150~180°C for 60~90 seconds.
2. Ascending time to preheating temperature 150°C shall be 30 seconds min.
3. Heating shall be fixed at 220°C for 50~80 seconds and at 260°C+0/-5°C peak (20~40sec).
4. Time: 2 times.

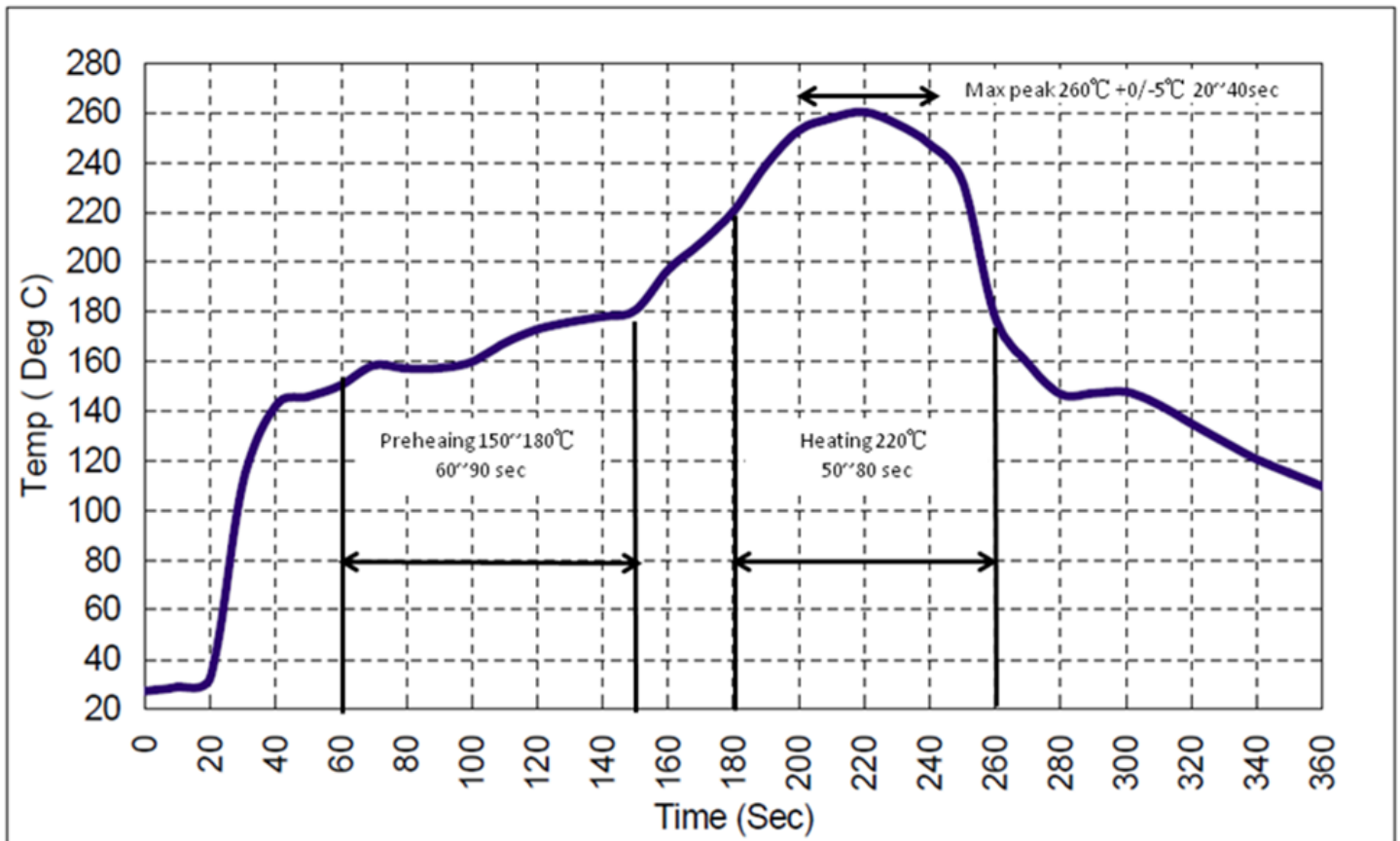

## Looking for pricing, stock, or lifecycle information?

Click below to explore more details on WIN SOURCE:

 [View SF2472E on WIN SOURCE](#)

 [RF Monolithics, Inc Information](#)

## Optimize Your Supply Chain with WIN SOURCE Solutions

-  Global Sourcing Solution
-  Obsolete Management
-  Cost Control Management
-  Shortage Management
-  Alternative Solution
-  Excess Inventory Management