

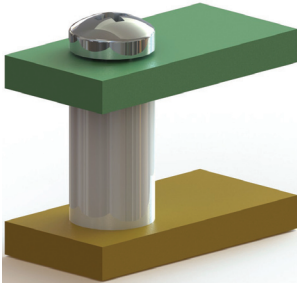

**THE DATASHEET OF
SWI1610A**



SWI
Round Nylon Spacer



- Resistant to corrosion and many chemicals
- Available for standard imperial thread sizes

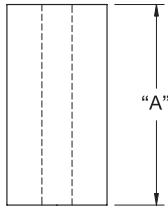
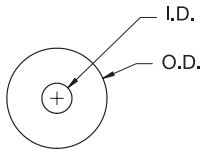

Material: Nylon Color: Natural					
Part No.	I.D.	O.D.	"A" Spacer Length	Fits Screw	Standard Pack
SWI1240A	.125 (3.2)	.305 (7.7)	.500 (12.7)	#4 (M3)	2,000
SWI1550A	.194 (4.9)	.500 (12.7)	1.000 (25.4)	#10 (M4)	1,000
SWI1570A	.205 (5.2)	.500 (12.7)	.510 (13)	#10 (M5)	1,000
SWI1610A	.250 (6.4)	.740 (18.8)	.250 (6.4)	#12 (M6)	5,000
SWI1620A	.253 (6.4)	.500 (12.7)	.125 (3.2)	1/4" (M6)	15,000
SWI1640A	.257 (6.5)	.500 (12.7)	.500 (12.7)		1,000
SWI1690A	.257 (6.5)	.500 (12.7)	.312 (7.9)		1,000
SWI1760A	.286 (7.3)	.500 (12.7)	.103 (2.6)		6,000
SWI1840A	.335 (8.5)	.750 (19.1)	.250 (6.4)	5/16" (M8)	7,400
SWI1860A	.375 (9.5)	.750 (19.1)	.065 (1.7)	5/16" (M9)	10,000
SWI1880A	.375 (9.5)	.875 (22.2)	.375 (9.5)		3,500
SWI1910A	.376 (9.6)	.546 (13.9)	.484 (12.3)		2,000
SWI1930A	.380 (9.7)	.625 (15.9)	.062 (1.6)	3/8" (M9)	5,000
SWI1960A	.380 (9.7)	.750 (19.1)	.187 (4.7)		1,000
SWI2020A	.500 (12.7)	.750 (19.1)	.375 (9.5)	7/16" (M12)	1,000
SWI2040A	.500 (12.7)	1.000 (25.4)	.100 (2.5)		8,000
SWI2050A	.500 (12.7)	1.250 (31.8)	.063 (1.6)		1,000
SWI2090A	.505 (12.8)	.750 (19.1)	.125 (3.2)	1/2" (M12)	1,000
SWI2100A	.512 (13)	1.258 (32)	.064 (1.6)		6,000
SWI2150A	.629 (16)	1.125 (28.6)	.128 (3.3)	9/16" (M13)	1,000

Looking for pricing, stock, or lifecycle information?

Click below to explore more details on WIN SOURCE:

- ⊖ [View SWI1610A on WIN SOURCE](#)
- ⊖ [Essentra Components Information](#)

Optimize Your Supply Chain with WIN SOURCE Solutions

- ✓ Global Sourcing Solution
- ✓ Obsolete Management
- ✓ Cost Control Management
- ✓ Shortage Management
- ✓ Alternative Solution
- ✓ Excess Inventory Management