

PART NUMBER

SSL-LX5099USBSIW

REV.

-

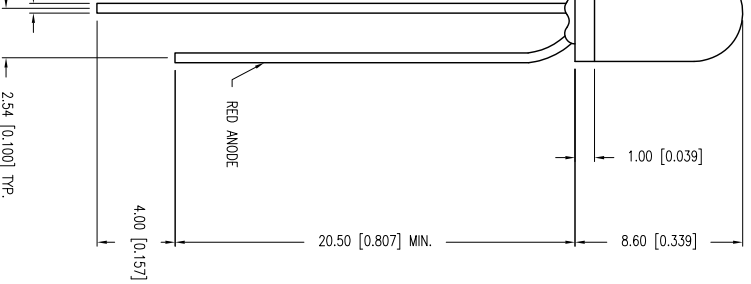
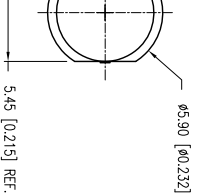

ELECTRO-OPTICAL CHARACTERISTICS $I_A=25^{\circ}\text{C}$			
PARAMETER	MIN	TYP	MAX
PEAK WAVELENGTH	636 (RED)	470 (BLUE)	
FORWARD VOLTAGE (R/B)	2.0/3.5	2.5/4.0	
REVERSE VOLTAGE	5.0		
AXIAL INTENSITY (R/B)	100/80		
VIEWING ANGLE	60		
EMITTED COLOR:	RED/BLUE		
EPOXY LENS FINISH:	MILKY WHITE DIFFUSED		

LIMITS OF SAFE OPERATION AT 25°C			
PARAMETER	COLORS	MAX	UNITS
PEAK FORWARD CURRENT*	(R/B)	185/150	mA
STEADY CURRENT	(R/B)	30/25	mA
POWER DISSIPATION	(R/B)	170/120	mW
DERATE FROM 25°C		-1.2	mW/°C
OPERATING TEMP.		-40 TO +85	°C
STORAGE TEMP.		-40 TO +85	°C
SOLDERING TEMP.		+260	°C
2.0mm FROM BODY			3 SEC. MAX
* I<10uS			

X=+1 (+0.039), X-X=+0.5 (+0.020), X+X=+0.25 (+0.010), XXX=+0.127 (+0.005), LEAD SIZE=+0.05 (+0.002), LEAD LENGTH=+0.75 (+0.030), MIN=-0.00
 HELEN ROAD
 E. I. L. 60067-6976
 +1.847.359.2790
 1.847.359.6538
 WWW.LUXEIX.COM

T=5mm 3 LEADED BICOLOR LED, 636nm AllInGAP RED, 470nm InGaN BLUE, MILKY WHITE DIFFUSED LENS.
 THE SPECIFICATIONS MAY CHANGE AT ANY TIME WITHOUT NOTICE DUE TO NEW MATERIALS OR PRODUCT IMPROVEMENT

CONFIDENTIAL INFORMATION
 THE INFORMATION CONTAINED IN THIS DOCUMENT IS THE PROPERTY OF LUXEIX INC. EXCEPT AS SPECIFICALLY AUTHORIZED IN WRITING BY LUXEIX INC., THE HOLDER OF THIS DOCUMENT SHALL KEEP ALL INFORMATION CONTAINED HEREIN CONFIDENTIAL AND SHALL PROTECT SAME IN WHOLE OR IN PART FROM DISCLOSURE AND DISSEMINATION TO ALL THIRD PARTIES.

DATE:	10.09.07	DRAWN BY:	JN
PAGE:	1 OF 1	CHKD BY:	SS
SCALE:		APRVD BY:	SS
UNIT:	mm [INCH]		

UNCONTROLLED DOCUMENT



Looking for pricing, stock, or lifecycle information?

Click below to explore more details on WIN SOURCE:

- ⊖ [View SSL-LX5099USBSIW on WIN SOURCE](#)
- ⊖ [Lumex Opto/Components Inc. Information](#)

Optimize Your Supply Chain with WIN SOURCE Solutions

- ✓ Global Sourcing Solution
- ✓ Obsolete Management
- ✓ Cost Control Management
- ✓ Shortage Management
- ✓ Alternative Solution
- ✓ Excess Inventory Management