

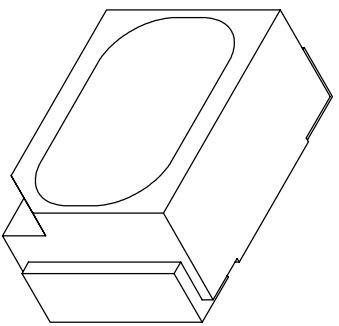

**THE DATASHEET OF
SML-LX23IC-TR**



| PART NUMBER | | SML-LX231C-TR | | REV. | G |
|-------------|-------------------------------------|-----------------------|--|------|---|
| DATE | E.C.N. NUMBER AND REVISION COMMENTS | | | | |
| 02.05.99 | E.C.N. #10BRDR | ADDED REFLOW PROFILE. | | | A |
| 08.09.99 | E.C.N. #10543. | | | | B |
| 01.05.01 | E.C.N. #10695. | | | | C |
| 03.14.03 | E.C.N. #10967. | | | | D |
| 02.07.05 | E.C.N. #11148. | | | | E |
| 12.14.09 | E.C.N. #10603. | | | | F |
| 03.28.11 | E.C.N. #10BRDR & REDRAWN. | | | | G |



ELECTRO-OPTICAL CHARACTERISTICS $I_A=25\text{mA}$

| PARAMETER | MIN | TYP | MAX | UNITS | TEST COND |
|--------------------|------------------|-----|-----|----------------|----------------------|
| PEAK WAVELENGTH | | 635 | | nm | |
| FORWARD VOLTAGE | | 2.0 | 2.5 | V_f | $I_f=100\mu\text{A}$ |
| REVERSE VOLTAGE | 5.0 | | | V_r | |
| AXIAL INTENSITY | | 20 | | med | $I_f=20\text{mA}$ |
| VIEWING ANGLE | | 90 | | 2θ theo | |
| EMITTED COLOR: | RED | | | | |
| EPOXY LENS FINISH: | WATER CLEAR LENS | | | | |

LIMITS OF SAFE OPERATION AT 25°C PER CHIP

| PARAMETER | MAX | UNITS |
|-----------------------|------------|-------|
| PEAK FORWARD CURRENT* | 160 | mA |
| STEADY CURRENT | 30 | mA |
| POWER DISSIPATION | 100 | mW |
| DERATE FROM 25°C | -1.2 | mW/°C |
| OPERATING TEMP. | -25 TO +80 | °C |
| STORAGE TEMP. | -30 TO +85 | °C |
| SOLDERING TEMP. | +240 | °C |

NOTES:

1. THE CATHODE IS ORIENTED TOWARDS THE TAPE SPROCKET HOLE.

CAUTION: MOISTURE SENSITIVE DEVICE
PER JEDEC LEVEL 4 STANDARDS

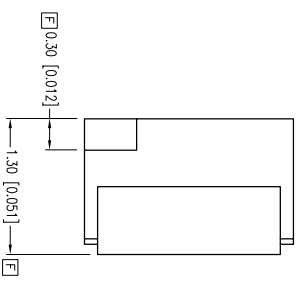

RECOMMENDED SOLDER PAD LAYOUT

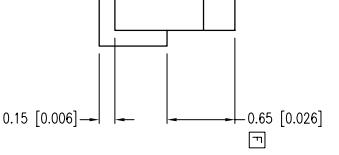
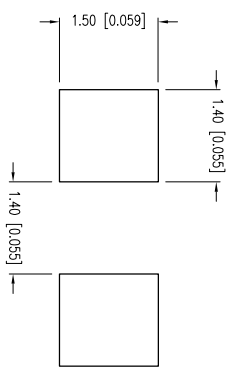

X±1 (+0.039), X±±0.5 (+0.020), XXX=±0.25 (+0.010), XXXX=±0.127 (+0.005), LEAD SIZE=±0.05 (+0.002), LEAD LENGTH=±0.75 (+0.030), MIN= -0.00 DECENTRAL PRECISION MAX. = +0.00 DECENTRAL PRECISION

HELEN ROAD
E, IL 60067-6976
+1.847.359.2790
WWW.LUMEX.COM

2mm x 3mm SURFACE MOUNT WITH REFLECTOR, 635nm RED LED, WATER CLEAR LENS.

THE SPECIFICATIONS MAY CHANGE AT ANY TIME WITHOUT NOTICE DUE TO NEW MATERIALS OR PRODUCT IMPROVEMENT

UNCONTROLLED DOCUMENT

| | | | |
|--------|-----------|-----------|----|
| DATE: | 03.28.11 | DRAWN BY: | AB |
| PAGE: | 1 OF 2 | CHKD BY: | JD |
| SCALE: | NTS | APRVD BY: | JD |
| UNIT: | mm [INCH] | | |

CONFIDENTIAL INFORMATION
THE INFORMATION CONTAINED IN THIS DOCUMENT IS THE PROPERTY OF LUMEX INC. EXCEPT AS SPECIFICALLY AUTHORIZED IN WRITING BY LUMEX INC., THE HOLDER OF THIS DOCUMENT SHALL KEEP ALL INFORMATION CONTAINED HEREIN CONFIDENTIAL AND SHALL PROTECT SAME IN WHOLE OR IN PART FROM DISCLOSURE AND DISSEMINATION TO ALL THIRD PARTIES.

| PART NUMBER | | SML-LX231C-TR | | REV. | G |
|-------------|---------------------------------------|---------------|--|------|------|
| DATE | E.C.N. NUMBER AND REVISION COMMENTS | | | | REV. |
| 02.05.99 | E.C.N. #10BRDR. ADDED REFLOW PROFILE. | | | | A |
| 08.09.99 | E.C.N. #10543. | | | | B |
| 01.05.01 | E.C.N. #10695. | | | | C |
| 03.14.03 | E.C.N. #10967. | | | | D |
| 02.07.05 | E.C.N. #11148. | | | | E |
| 12.14.09 | E.C.N. #10603. | | | | F |
| 03.28.11 | E.C.N. #10BRDR & REDRAWN. | | | | G |

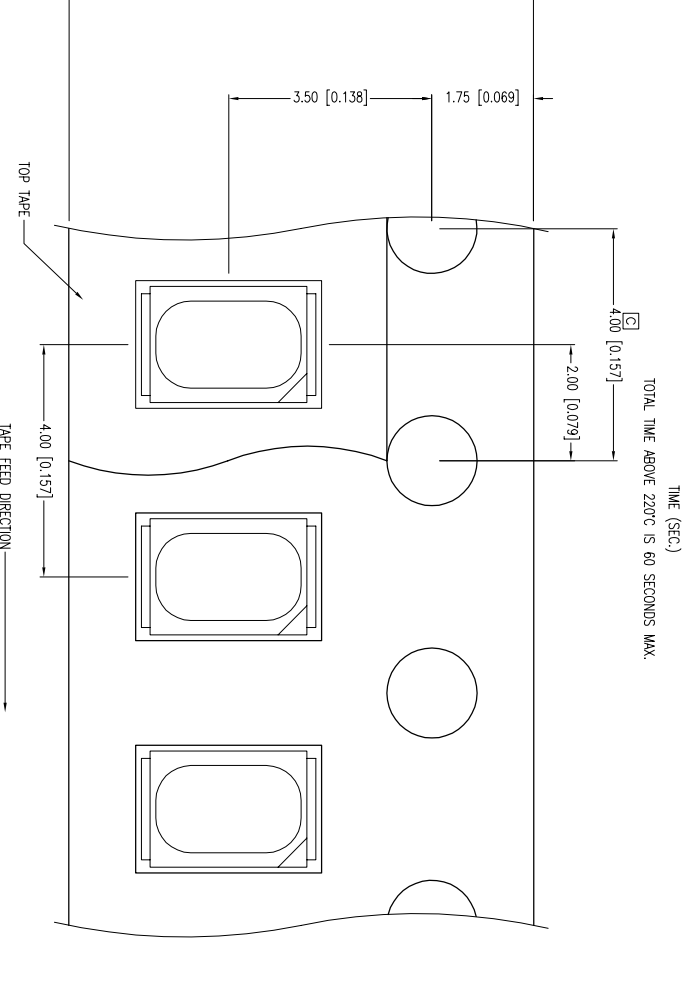
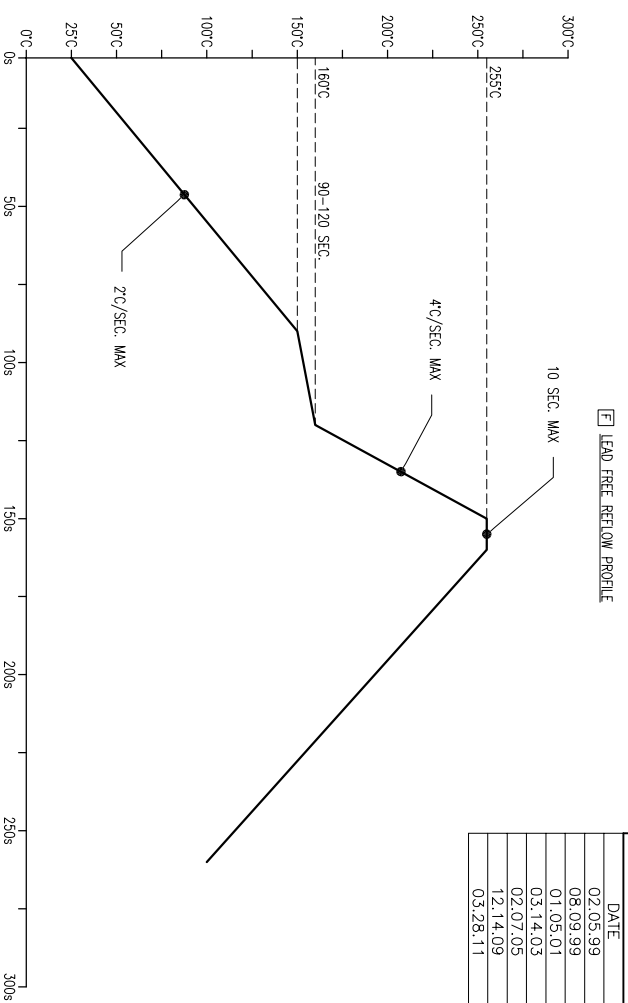

HELEN ROAD
 E. IL 60067-6976
 +1.847.359.2790
 WWW.LUMEX.COM

2mm x 3mm SURFACE MOUNT WITH REFLECTOR, 635nm RED LED, WATER CLEAR LENS.

UNCONTROLLED DOCUMENT

DATE: 03.28.11 DRAWN BY: AB
 PAGE: 2 OF 2 CHKD BY: JD
 SCALE: NTS APRVD BY: JD
 UNIT: mm [INCH]

±0.039, X±0.05 ±0.020, XXX±0.25 ±0.010, XXXX±0.127 ±0.005, LEAD SIZE±0.05 ±0.002, LEAD LENGTH±0.75 ±0.030, MIN±0.000, DECIMAL PRECISION MAX±0.000, DECIMAL PRECISION



CONFIDENTIAL INFORMATION
 THE INFORMATION CONTAINED IN THIS DOCUMENT IS THE PROPERTY OF LUMEX INC. EXCEPT AS SPECIFICALLY AUTHORIZED IN WRITING BY LUMEX INC., THE HOLDER OF THIS DOCUMENT SHALL KEEP ALL INFORMATION CONTAINED HEREIN CONFIDENTIAL AND SHALL PROTECT SAME IN WHOLE OR IN PART FROM DISCLOSURE AND DISSEMINATION TO ALL THIRD PARTIES.

THE SPECIFICATIONS MAY CHANGE AT ANY TIME WITHOUT NOTICE DUE TO NEW MATERIALS OR PRODUCT IMPROVEMENT



Looking for pricing, stock, or lifecycle information?

Click below to explore more details on WIN SOURCE:

-  [View SML-LX23IC-TR on WIN SOURCE](#)
-  [Lumex Opto/Components Inc. Information](#)

Optimize Your Supply Chain with WIN SOURCE Solutions

-  Global Sourcing Solution
-  Obsolete Management
-  Cost Control Management
-  Shortage Management
-  Alternative Solution
-  Excess Inventory Management