

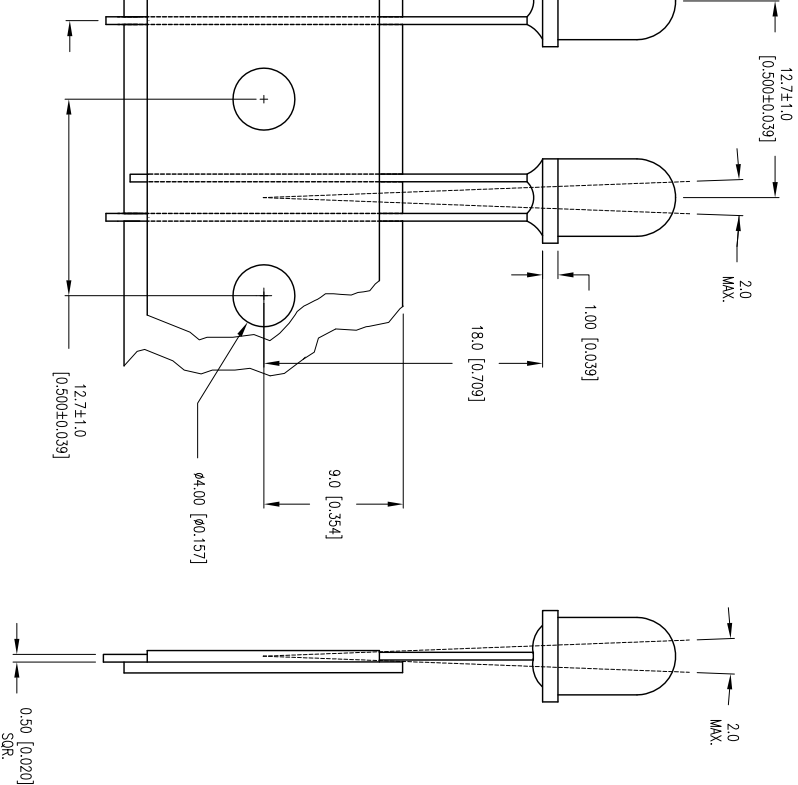

**THE DATASHEET OF
SSL-LX5093GD-TR**

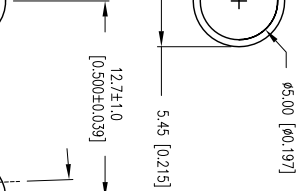

| | | | | |
|-------------|-------------------------------------|--|------|---|
| PART NUMBER | SSL-LX5093GD-TR | | REV. | B |
| DATE | E.C.N. NUMBER AND REVISION COMMENTS | | REV. | |
| 10.19.06 | E.C.N. #11148. | | A | |
| 11.16.11 | E.C.N. #10BRDR. & REDRAWN. | | B | |



ELECTRO-OPTICAL CHARACTERISTICS $T_a=25^{\circ}\text{C}$ $I_f=20\text{mA}$

| PARAMETER | MIN | TP | MAX | UNITS | TEST COND |
|-----------------|-----|----------------|-----|----------|----------------------|
| PEAK WAVELENGTH | | 565 | | nm | |
| FORWARD VOLTAGE | | 2.2 | 2.6 | Vf | $I_f=100\mu\text{A}$ |
| REVERSE VOLTAGE | 5.0 | | | Vr | |
| AXIAL INTENSITY | | 30 | | md | $I_f=20\text{mA}$ |
| VIEWING ANGLE | | 60 | | 2x theta | |
| EMITTED COLOR: | | GREEN | | | |
| LENS FINISH: | | GREEN DIFFUSED | | | |

LIMITS OF SAFE OPERATION AT 25°C

| PARAMETER | MAX | UNITS |
|-----------------------|------------|-------|
| PEAK FORWARD CURRENT* | 150 | mA |
| STEADY CURRENT | 25 | mA |
| POWER DISSIPATION | 105 | mW |
| DERATE FROM 25°C | -1.2 | mW/°C |
| OPERATING TEMP. | -40 TO +85 | °C |
| STORAGE TEMP. | -40 TO +85 | °C |
| SOLDERING TEMP.: | +260 | °C |
| 2.0mm FROM BODY | 3 | SEC. |

* I<10μS

X±1 (+0.039), X.X=±0.5 (+0.020), X.XX=±0.25 (+0.010), X.XXX=±0.127 (+0.005), LEAD SIZE=±0.05 (+0.002), LEAD LENGTH=±0.75 (+0.030), MIN.= -0.00 DECADEAL PRECISION MAX.= +0.00 DECADEAL PRECISION

QUASARBRITE T-5mm (T-1 3/4) 565nm GREEN LED, GREEN DIFFUSED LENS, TAPE AND REEL.

THE SPECIFICATIONS MAY CHANGE AT ANY TIME WITHOUT NOTICE DUE TO NEW MATERIALS OR PRODUCT IMPROVEMENT

CONFIDENTIAL INFORMATION

THE INFORMATION CONTAINED IN THIS DOCUMENT IS THE PROPERTY OF LUXEY INC. EXCEPT AS SPECIFICALLY AUTHORIZED IN WRITING BY LUXEY INC., THE HOLDER OF THIS DOCUMENT SHALL KEEP ALL INFORMATION CONTAINED HEREIN CONFIDENTIAL AND SHALL PROTECT SAME IN WHOLE OR IN PART FROM DISCLOSURE AND DISSEMINATION TO ALL THIRD PARTIES.

Y: AFE
 CAN. TL 60188-4900
 800.278.3666
 3.15.1252
 LUXEY.COM
 /TW PHOTONICS GROUP

UNCONTROLLED DOCUMENT

| | | | |
|--------|-----------|-----------|----|
| DATE: | 11.16.11 | DRAWN BY: | AB |
| PAGE: | 1 OF 1 | CHKD BY: | KF |
| SCALE: | NTS | APRVD BY: | SS |
| UNIT: | mm [INCH] | | |



Looking for pricing, stock, or lifecycle information?

Click below to explore more details on WIN SOURCE:

- ⊖ [View SSL-LX5093GD-TR on WIN SOURCE](#)
- ⊖ [Lumex Opto/Components Inc. Information](#)

Optimize Your Supply Chain with WIN SOURCE Solutions

- ✓ Global Sourcing Solution
- ✓ Obsolete Management
- ✓ Cost Control Management
- ✓ Shortage Management
- ✓ Alternative Solution
- ✓ Excess Inventory Management