

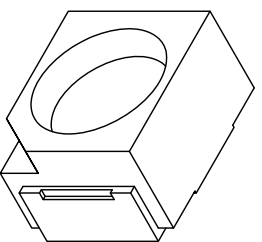

**THE DATASHEET OF  
SML-LX2832ZIC-TR**

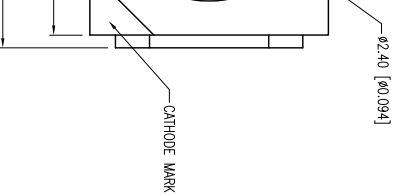

| PART NUMBER | SML-LX2832ZIC-TR                    | REV. | E |
|-------------|-------------------------------------|------|---|
| DATE        | E.C.N. NUMBER AND REVISION COMMENTS |      |   |
| 03.14.03    | E.C.N. #10967.                      |      | A |
| 02.08.05    | E.C.N. #11148.                      |      | B |
| 10.16.07    | E.C.N. #11450.                      |      | C |
| 05.06.10    | E.C.N. #11627.                      |      | D |
| 04.11.12    | E.C.N. #10BRDR. & REDRAWN/#11812.   |      | E |



0.50±0.10 [0.020±0.004]

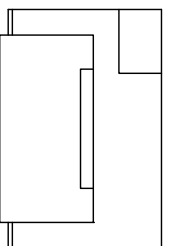

| ELECTRO-OPTICAL CHARACTERISTICS $T_a=25^{\circ}\text{C}$ |             |     |     |
|--|-------------|-----|-----|
| PARAMETER  | MIN         | TPY | MAX |
| PEAK WAVELENGTH  |             | 630 |     |
| FORWARD VOLTAGE  |             | 2.4 | 2.8 |
| REVERSE VOLTAGE  | 5.0         |     |     |
| AXIAL INTENSITY  |             | 800 |     |
| VIEWING ANGLE  |             | 120 |     |
| EMITTED COLOR:   | RED         |     |     |
| LENS FINISH:   | WATER CLEAR |     |     |

LIMITS OF SAFE OPERATION AT 25°C

| PARAMETER             | MAX        | UNITS |
|-----------------------|------------|-------|
| PEAK FORWARD CURRENT* | 150        | mA    |
| STEADY CURRENT        | 30         | mA    |
| POWER DISSIPATION     | 120        | mW    |
| DERATE FROM 25°C      | -1.2       | mW/°C |
| OPERATING TEMP.       | -40 TO +85 | °C    |
| STORAGE TEMP.         | -40 TO +85 | °C    |
| SOLDERING TEMP.:      | +260       | °C    |
| 2.0mm FROM BODY       | 3          | SEC.  |

\*  $t < 100\mu\text{S}$

**E D A**  
CAUTION: MOISTURE SENSITIVE DEVICE  
PER JEDEC LEVEL 3 STANDARDS

**G** RECOMMENDED SOLDER PAD LAYOUT

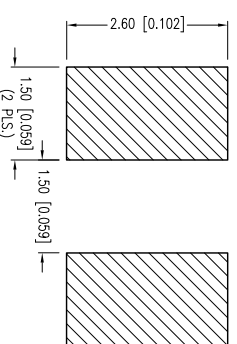

X±1 (+0.039), X.X=±0.5 (+0.020), X.XX=±0.25 (+0.010), X.XXX=±0.127 (+0.005), LEAD SIZE=±0.05 (+0.002), LEAD LENGTH=±0.75 (+0.030), MIN.= -0.000, PRECISION MAX.= +0.000, PRECISION

EN 8000  
60067-6976  
947.359.2790  
LUXEY.COM  
/7W PHOTONICS GROUP

2.8mm X 3.2mm SML /W REFLECTOR, 630nm LED, WATER CLEAR LENS, 2,000 PCS PER TAPE & REEL.

\*\*THE SPECIFICATIONS MAY CHANGE AT ANY TIME WITHOUT NOTICE DUE TO NEW MATERIALS OR PRODUCT IMPROVEMENT\*\*

CONFIDENTIAL INFORMATION  
THE INFORMATION CONTAINED IN THIS DOCUMENT IS THE PROPERTY OF LUXEY INC. EXCEPT AS SPECIFICALLY AUTHORIZED IN WRITING BY LUXEY INC., THE HOLDER OF THIS DOCUMENT SHALL KEEP ALL INFORMATION CONTAINED HEREIN CONFIDENTIAL AND SHALL PROTECT SAME IN WHOLE OR IN PART FROM DISCLOSURE AND DISSEMINATION TO ALL THIRD PARTIES.

UNCONTROLLED DOCUMENT

|        |           |           |    |
|--------|-----------|-----------|----|
| DATE:  | 04.11.12  | DRAWN BY: | AB |
| PAGE:  | 1 OF 2    | CHKD BY:  | DT |
| SCALE: | NTS       | APRVD BY: | DT |
| UNIT:  | mm [INCH] |           |    |



| PART NUMBER |                                   | SML-LX2832ZIC-TR                    |  | REV. | E |
|-------------|-----------------------------------|-------------------------------------|--|------|---|
| DATE        |                                   | E.C.N. NUMBER AND REVISION COMMENTS |  | REV. |   |
| 03.14.03    | E.C.N. #10967.                    |                                     |  | A    |   |
| 02.08.05    | E.C.N. #11148.                    |                                     |  | B    |   |
| 10.16.07    | E.C.N. #11450.                    |                                     |  | C    |   |
| 05.06.10    | E.C.N. #11627.                    |                                     |  | D    |   |
| 04.11.12    | E.C.N. #10BRDR. & REDRAWN/#11812. |                                     |  | E    |   |

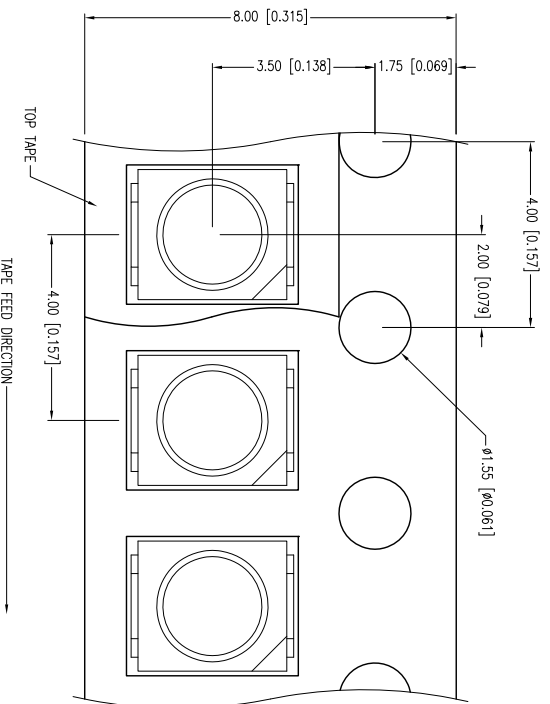
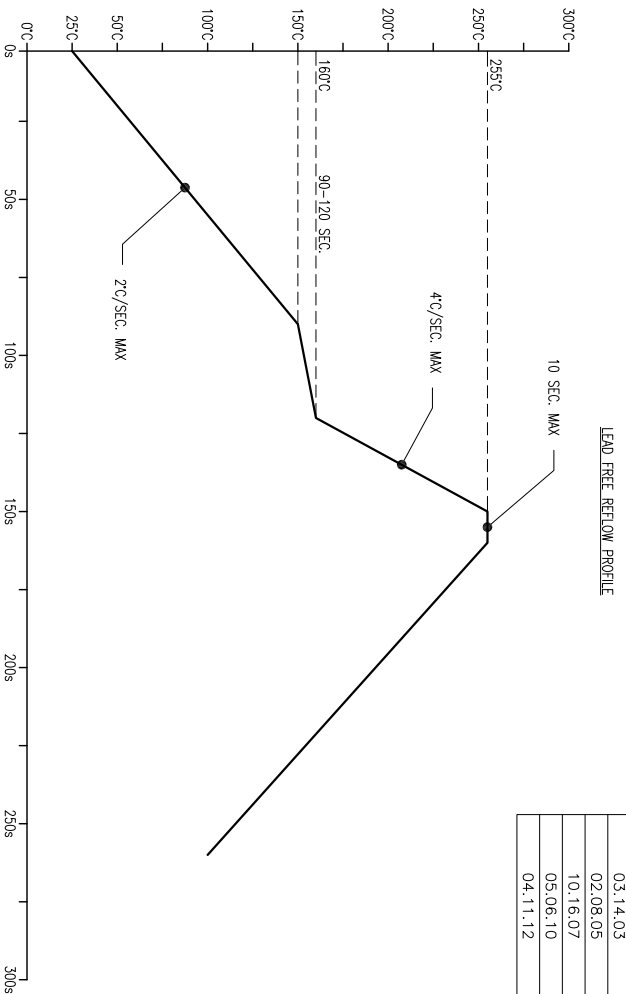

NOTES:  
 1. THE POLARITY MARK IS ORIENTED TOWARDS THE TAPE SPROCKET HOLE.

## Looking for pricing, stock, or lifecycle information?

Click below to explore more details on WIN SOURCE:

- ⊖ [View SML-LX2832ZIC-TR on WIN SOURCE](#)
- ⊖ [Lumex Opto/Components Inc. Information](#)

## Optimize Your Supply Chain with WIN SOURCE Solutions

- ✓ Global Sourcing Solution
- ✓ Obsolete Management
- ✓ Cost Control Management
- ✓ Shortage Management
- ✓ Alternative Solution
- ✓ Excess Inventory Management