

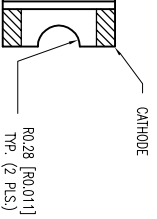

**THE DATASHEET OF
SML-LXL1206SIC-TR**



PART NUMBER		SML-LXL1206SIC-TR		REV.	D
DATE	E.C.N. #10967	E.C.N. NUMBER AND REVISION COMMENTS		REV.	
03.14.03	E.C.N. #11148			A	
03.17.05	E.C.N. #11508			B	
05.26.10	E.C.N. #11665			C	
10.12.10				D	



MODE

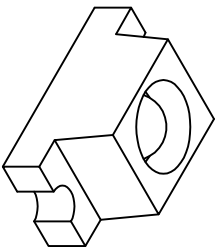
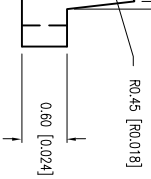

ELECTRO-OPTICAL CHARACTERISTICS $I_A=25\text{mA}$

PARAMETER	MIN	TYP	MAX	UNITS	TEST COND
PEAK WAVELENGTH		636		nm	
FORWARD VOLTAGE		2.0	2.6	V _f	$I_f=100\mu\text{A}$
REVERSE VOLTAGE	5.0			V _r	$I_f=20\text{mA}$
AXIAL INTENSITY		75		med	
VIEWING ANGLE		60		2x theta	
EMITTED COLOR:	RED				
EPOXY LENS FINISH:	WATER CLEAR				

LIMITS OF SAFE OPERATION AT 25°C

PARAMETER	MAX	UNITS
PEAK FORWARD CURRENT*	160	mA
STEADY CURRENT	30	mA
POWER DISSIPATION	100	mW
DERATE FROM 25°C	-1.2	mW/°C
OPERATING TEMP.	-40 TO +85	°C
STORAGE TEMP.	-40 TO +85	°C
* I_C=0.5		

CAUTION: MOISTURE SENSITIVE DEVICE
PER JEDEC LEVEL 2 STANDARDS

- NOTES:
- THE CATHODE IS ORIENTED TOWARDS THE TAPE SPROCKET HOLE.

LEAD FREE REFLOW PROFILE
10 SEC. MAX.

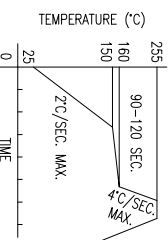

TOTAL TIME ABOVE 220°C IS 60 SECONDS MAX.

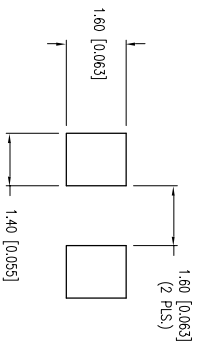
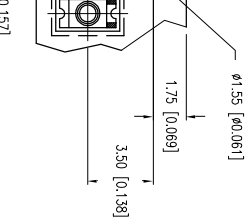

RECOMMENDED SOLDER PAD LAYOUT

DATE: X=±1 (+0.039), X-X=±0.5 (+0.020), X-X=±0.25 (+0.010), X-X-X=±0.127 (+0.005), LEAD SIZE=±0.05 (+0.002), LEAD LENGTH=±0.75 (+0.030), MIN= -0.00
E. HELEN ROAD
TINE, IL 60067-6976
TEL: +1.847.359.2790
WWW.LUMEX.COM

DATE: 01.08.01
PAGE: 1 OF 1
SCALE: N/A
UNIT: mm [INCH]

CONFIDENTIAL INFORMATION
THE INFORMATION CONTAINED IN THIS DOCUMENT IS THE PROPERTY OF LUXE INC. EXCEPT AS SPECIFICALLY AUTHORIZED IN WRITING BY LUXE INC., THE HOLDER OF THIS DOCUMENT SHALL KEEP ALL INFORMATION CONTAINED HEREIN CONFIDENTIAL AND SHALL PROTECT SAME IN WHOLE OR IN PART FROM DISCLOSURE AND DISSEMINATION TO ALL THIRD PARTIES.

CONFERENTIAL INFORMATION
THE SPECIFICATIONS MAY CHANGE AT ANY TIME WITHOUT NOTICE DUE TO NEW MATERIALS OR PRODUCT IMPROVEMENT.

3.0mm x 1.6mm PCB SURFACE MOUNT LED WITH LENS,

UNCONTROLLED DOCUMENT

DRAWN BY: CT
CHKD BY: KF
APPRD BY: SA

Looking for pricing, stock, or lifecycle information?

Click below to explore more details on WIN SOURCE:

- ⊖ [View SML-LXL1206SIC-TR on WIN SOURCE](#)
- ⊖ [Lumex Opto/Components Inc. Information](#)

Optimize Your Supply Chain with WIN SOURCE Solutions

- ✓ Global Sourcing Solution
- ✓ Obsolete Management
- ✓ Cost Control Management
- ✓ Shortage Management
- ✓ Alternative Solution
- ✓ Excess Inventory Management