



**THE DATASHEET OF
SML-LX4747UWC-TR10**



PART NUMBER

SML-LX4747UWC-TR10

REV. --

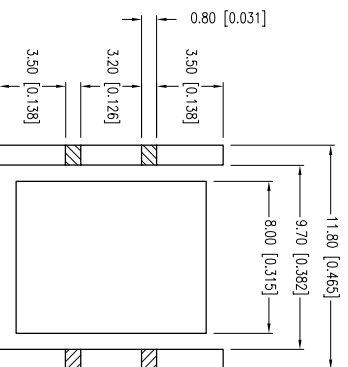
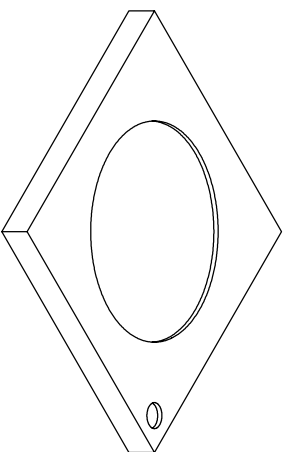
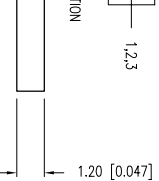
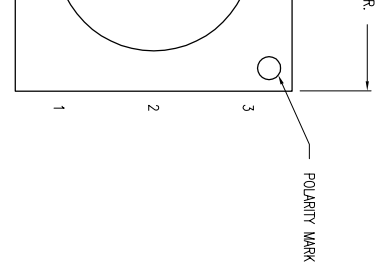

RECOMMENDED SOLDER PAD LAYOUT

ELECTRO-OPTICAL CHARACTERISTICS $T_A=25^{\circ}\text{C}$ $I_f=1000\text{mA}$						
PARAMETER	SYMBOL	MIN	TYP	MAX	UNITS	TEST COND
FORWARD VOLTAGE	V_f	9.3	10.4	11.5	V	$I_f=1000\text{mA}$
REVERSE VOLTAGE	V_r	15			V	$I_f=10\mu\text{A}$
LUMINOUS FLUX	Φ_v	490	600		lm	$I_f=1000\text{mA}$
COLOR TEMPERATURE		5310	6000	7040	°K	
VIEWING ANGLE			120		2x theta	
EMITTED COLOR:					COOL WHITE	
EPOXY LENS FINISH:					WATER CLEAR LENS	

LIMITS OF SAFE OPERATION AT 25°C

PARAMETER	MAX	UNITS
PEAK FORWARD CURRENT	1200	mA
STEADY CURRENT	1000	mA
POWER DISSIPATION	11.5	mW
OPERATING TEMP.	-40 TO +90	°C
STORAGE TEMP.	-40 TO +100	°C

THERMAL PARAMETERS

PARAMETER	MAX	UNITS
JUNCTION TEMPERATURE	110	°C
THERMAL RESISTANCE (JUNCTION/SOLDER)	3.5	°C/W
TEMPERATURE COEFFICIENT OF V_f	-5.6	mV/°C

CAUTION: MOISTURE SENSITIVE DEVICE
PER JEDEC LEVEL 2 STANDARDS

CAUTION: STATIC SENSITIVE DEVICE
FOLLOW PROPER E.S.D. HANDLING PROCEDURES
WHEN WORKING WITH THIS PART.

X=±1 (±0.039), X±=±0.5 (±0.020), XXX=±0.25 (±0.010), XXXX=±0.127 (±0.005), LEAD SIZE=±0.05 (±0.002), LEAD LENGTH=±0.75 (±0.030), MIN=-_{0.00} DECIMAL PRECISION MAX.=+0.00
HELEN ROAD
E, IL 60067-6976
+1.847.359.2790
WWW.LUMEX.COM

12mm x 12mm SURFACE MOUNT LED, COOL WHITE.

THE SPECIFICATIONS MAY CHANGE AT ANY TIME WITHOUT NOTICE DUE TO NEW MATERIALS OR PRODUCT IMPROVEMENT

CONFIDENTIAL INFORMATION
THE INFORMATION CONTAINED IN THIS DOCUMENT IS THE PROPERTY OF LUMEX INC. EXCEPT AS SPECIFICALLY AUTHORIZED IN WRITING BY LUMEX INC., THE HOLDER OF THIS DOCUMENT SHALL
KEEP ALL INFORMATION CONTAINED HEREIN CONFIDENTIAL AND SHALL PROTECT SAME IN WHOLE OR IN PART FROM DISCLOSURE AND DISSEMINATION TO ALL THIRD PARTIES.

DATE:	02.04.11	DRAWN BY:	AB
PAGE:	1 OF 4	CHKD BY:	KF
SCALE:		APRVD BY:	BC
UNIT:	mm [INCH]		

UNCONTROLLED DOCUMENT



PART NUMBER

SML-LX4747UWC-TR10

REV.

--

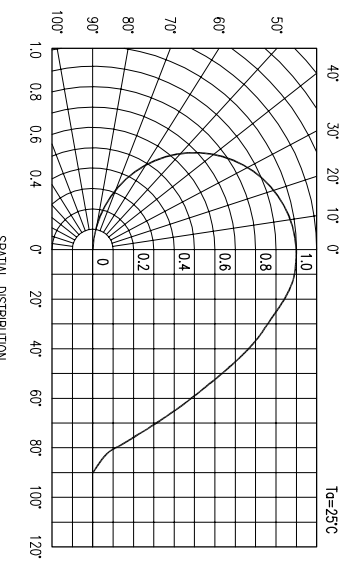
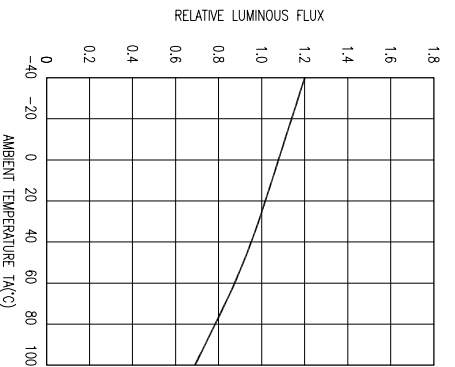
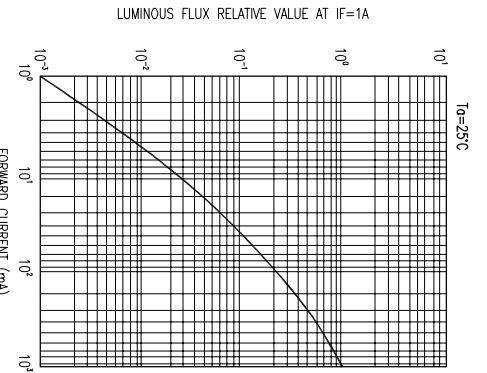

HELEN ROAD
 E, IL 60067-6976
 +1.847.359.2790
 +1.847.359.6538
 WWW.LUMEX.COM

12mm x 12mm SURFACE MOUNT LED, COOL WHITE.
 THE SPECIFICATIONS MAY CHANGE AT ANY TIME WITHOUT NOTICE DUE TO NEW MATERIALS OR PRODUCT IMPROVEMENT.
 CONFIDENTIAL INFORMATION
 THE INFORMATION CONTAINED IN THIS DOCUMENT IS THE PROPERTY OF LUMEX INC. EXCEPT AS SPECIFICALLY AUTHORIZED IN WRITING BY LUMEX INC., THE HOLDER OF THIS DOCUMENT SHALL KEEP ALL INFORMATION CONTAINED HEREIN CONFIDENTIAL AND SHALL PROTECT SAME IN WHOLE OR IN PART FROM DISCLOSURE AND DISSEMINATION TO ALL THIRD PARTIES.

UNCONTROLLED DOCUMENT
 DATE: 02.04.11 DRAWN BY: AB
 PAGE: 2 OF 4 CHKD BY: KF
 SCALE: APRVD BY: BC
 UNIT: mm [INCH]



PART NUMBER

SML-LX4747UWC-TR10

REV.

--

LEAD FREE REFLOW PROFILE

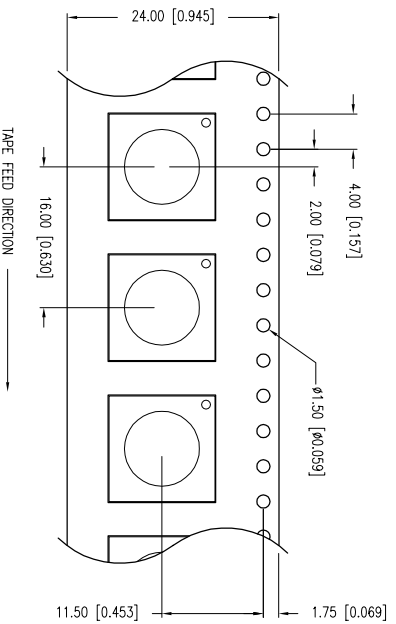
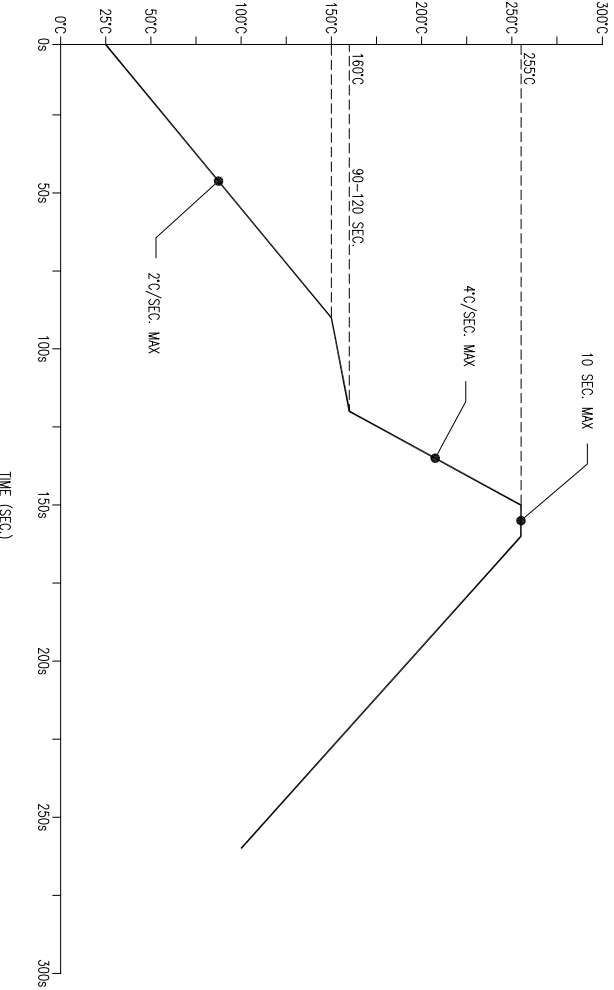

X=+1 (-0.039), X+0.5 (-0.020), XXX=+0.25 (-0.010), XXXX=+0.127 (-0.005), LEAD SIZE=+0.05 (-0.002), LEAD LENGTH=+0.75 (-0.030), MIN=-^{+0.00}_{-0.00} DECIMAL PRECISION
HELEN ROAD
E. IL 60067-6976
+1.847.359.2790
1.847.359.6538
WWW.LUMEX.COM

12mm x 12mm SURFACE MOUNT LED, COOL WHITE.

THE SPECIFICATIONS MAY CHANGE AT ANY TIME WITHOUT NOTICE DUE TO NEW MATERIALS OR PRODUCT IMPROVEMENT

CONFIDENTIAL INFORMATION
THE INFORMATION CONTAINED IN THIS DOCUMENT IS THE PROPERTY OF LUMEX INC. EXCEPT AS SPECIFICALLY AUTHORIZED IN WRITING BY LUMEX INC., THE HOLDER OF THIS DOCUMENT SHALL KEEP ALL INFORMATION CONTAINED HEREIN CONFIDENTIAL AND SHALL PROTECT SAME IN WHOLE OR IN PART FROM DISCLOSURE AND DISSEMINATION TO ALL THIRD PARTIES.

UNCONTROLLED DOCUMENT

DATE: 02.04.11 DRAWN BY: AB

PAGE: 4 OF 4 CHKD BY: KF

SCALE: APPROV BY: BC

UNIT: mm [INCH]



Looking for pricing, stock, or lifecycle information?

Click below to explore more details on WIN SOURCE:

- ⊖ [View SML-LX4747UWC-TR10 on WIN SOURCE](#)
- ⊖ [Lumex Opto/Components Inc. Information](#)

Optimize Your Supply Chain with WIN SOURCE Solutions

- ✓ Global Sourcing Solution
- ✓ Obsolete Management
- ✓ Cost Control Management
- ✓ Shortage Management
- ✓ Alternative Solution
- ✓ Excess Inventory Management