

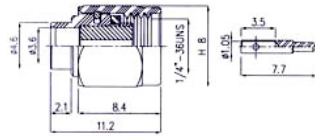

**THE DATASHEET OF
SMA-50SAG7567BRX**



1. SMA Straight Plug (With Center Contact)



Semi-Rigid
Cable -Direct
Solder Attachment

Finish: gold plated center contact & body
Insulation: Teflon

Ordering Code	Applicable Cable RG/U	Notes
SMA-50PAG0112BRX	RG 402/U (.141")	
SMA-50PAG0113BRX	RG 405/U (.085")	

2. SMA Right Angle Plug

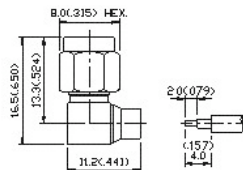

Semi-Rigid
Cable -Direct
Solder Attachment

Finish: gold plated center contact & body
Insulation: Teflon

Ordering Code	Applicable Cable RG/U	Notes
SMA-50PAG0612BRX	RG 402/U (.141")	
SMA-50PAG0613BRX	RG 405/U (.085")	

3. SMA Straight Jack

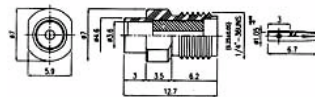

Semi-Rigid
Cable -Direct
Solder Attachment

Finish: gold plated center contact & body
Insulation: Teflon

Ordering Code	Applicable Cable RG/U	Notes
SMA-50SAG0112BRX	RG 402/U (.141")	
SMA-50SAG0113BRX	RG 405/U (.085")	

4. SMA Straight Bulkhead Jack

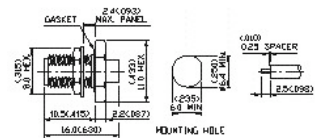

Semi-Rigid
Cable -Direct
Solder Attachment

Finish: gold plated center contact & body
Insulation: Teflon

Ordering Code	Applicable Cable RG/U	Notes
SMA-50SAG6412BRX	RG 402/U (.141")	
SMA-50SAG6413BRX	RG 405/U (.085")	

5. SMA Straight Square Flange Jack

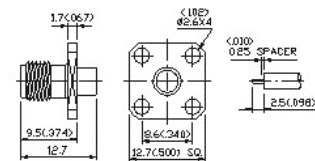

Semi-Rigid
Cable -Direct
Solder Attachment

Finish: gold plated center contact & body
Insulation: Teflon

Ordering Code	Applicable Cable RG/U	Notes
SMA-50SAG5612BRX	RG 402/U (.141")	
SMA-50SAG5613BRX	RG 405/U (.085")	

6. SMA Straight 2 Hole Flange Jack



Finish: gold plated center contact & body
Insulation: Teflon

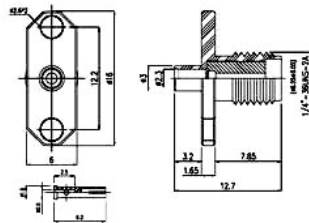

Semi-Rigid
Cable -Direct
Solder Attachment

Ordering Code	Applicable Cable RG/U	Notes
SMA-50SAG7812BRX	RG 402/U (.141")	
SMA-50SAG7813BRX	RG 405/U (.085")	

7. SMA Straight Plug Clamp



Finish: gold plated center contact & body
Insulation: Teflon

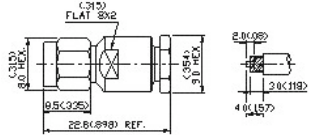

Flexible
Cable -Clamp
Attachment

Ordering Code	Applicable Cable RG/U	Notes
SMA-50PAG0704BRX	RG 402/U (.141")	
SMA-50PAG0702BRX	RG 405/U (.085")	

8. SMA Right Angle Plug Crimp



Finish: gold plated center contact & body
Insulation: Teflon

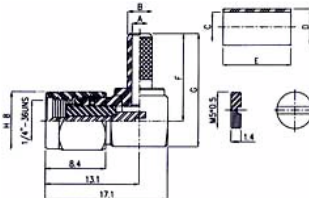

Flexible
Cable -Clamp
Attachment

Ordering Code	Applicable Cable RG/U	Notes
SMA-50PAG0404BRX	58,58A,141A	
SMA-50PAG0402BRX	174,188A,316	
SMA-50PAG0416BRX	142B/U	

9. SMA Stright Plug Crimp

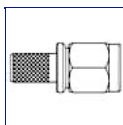

Finish: gold plated center contact & body
Insulation: Teflon

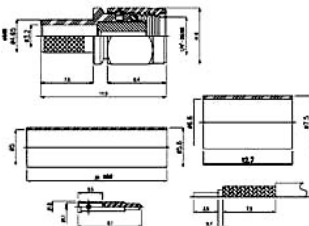

Ordering Code	Applicable Cable RG/U	Notes
SMA-50PAG0321BRX	RG-142/U.223	

10. SMA Straight Plug Crimp



Finish: gold plated center contact & body
Insulation: Teflon

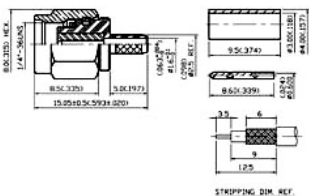

Flexible
Cable -Clamp
Attachment

Ordering Code	Applicable Cable RG/U	Notes
SMA-50PAG0304BRX	58,58A,141A	L=17.8mm
SMA-50PAG0302BRX	174,188A,316	L=16.3mm
SMA-50PAG0316BRX	142B/U	L=17.8mm

Finish: gold plated center contact & body
Insulation: Teflon

Ordering Code
SMA-50SAG5999BRX

17. SMA Square Flange Jack Receptacle (Exposed Teflon)

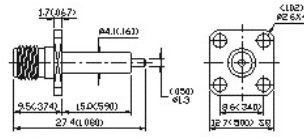

Panel Mount
Receptacle
(Exposed Teflon)

Finish: gold plated center contact & body
Insulation: Teflon

Ordering Code
SMA-50SAG6999BRX

18. SMA 2 Hole Flange Jack Receptacle (Exposed Teflon)

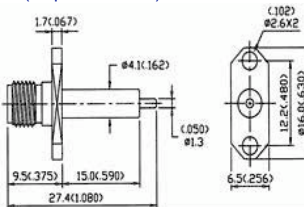

Panel Mount
Receptacle (Exposed
Teflon)

Finish: gold plated center contact & body
Insulation: Teflon

Ordering Code
SMA-50SAG6199BRX
SMA-50SAG6152BRX

19. SMA Square Flange Plug Receptacle (Tab Contact)

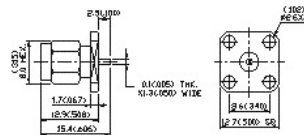

Panel Mount
Receptacle (Tab
Contact)

Finish: gold plated center contact & body
Insulation: Teflon

Ordering Code
SMA-50PAG6299BRX

20. SMA Square Flange Jack Receptacle (Tab Contact)



Click on the picture
for a detailed view

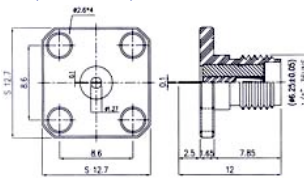

Panel Mount
Receptacle (Tab
Contact)

Finish: gold plated center contact & body
Insulation: Teflon

Ordering Code
SMA-50SAG6299BRX

21. SMA 2 Hole Flange Plug Receptacle (Tab Contact)

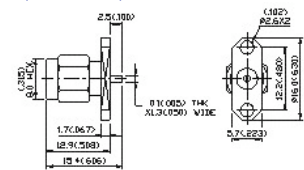

Panel Mount
Receptacle (Tab
Contact)

Finish: gold plated center contact & body
Insulation: Teflon

Ordering Code
SMA-50PAG6399BRX

22. SMA 2 Hole Flange Jack Receptacle (Tab Contact)

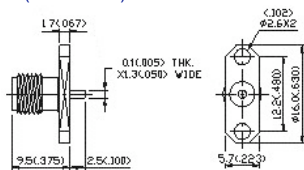

Panel Mount
Receptacle (Tab
Contact)

Finish: gold plated center contact & body
Insulation: Teflon

Ordering Code
SMA-50SAG6399BRX



Finish: gold plated center contact & body
Insulation: Teflon

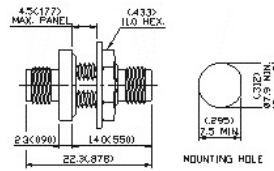

In-Series Adapter

Ordering Code
SMAS-SMASAG02X

41. SMA Plug-Plug In-series Adapter



Finish: gold plated center contact & body
Insulation: Teflon

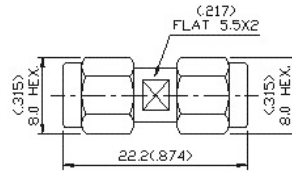

In-Series Adapter

Ordering Code
SMAP-SMAPAG01X

42. SMA Jack-Jack In-series Adapter



Finish: gold plated center contact & body
Insulation: Teflon

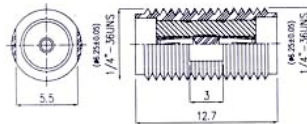

In-Series Adapter

Ordering Code
SMAS-SMASAG01X

For other plating options contact factory

43. SMA Right Angle PCB Mount Jack Receptacle



Finish: gold plated center contact & body
Insulation: Teflon

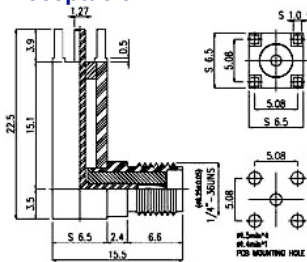

Printed Circuit Board
Receptacle

Ordering Code
SMA-50SAG7567BRX

For other plating options contact factory

Looking for pricing, stock, or lifecycle information?

Click below to explore more details on WIN SOURCE:

- ⊖ [View SMA-50SAG7567BRX on WIN SOURCE](#)
- ⊖ [Conec Information](#)

Optimize Your Supply Chain with WIN SOURCE Solutions

- ✓ Global Sourcing Solution
- ✓ Obsolete Management
- ✓ Cost Control Management
- ✓ Shortage Management
- ✓ Alternative Solution
- ✓ Excess Inventory Management