



Code Conductor, Aluminum Splice

For Use with Stranded Aluminum-to-Aluminum or Copper-to-Copper Conductors

Type SA

- Manufactured from high conductivity thick wall wrought aluminum
- Factory pre-filled with joint compound and sealed with easy pull-out end plug to inhibit corrosion
- Color-coded end plugs and Panduit and specified competitor die index numbers marked on barrel for proper crimp die selection
- Tin-plated to inhibit corrosion
- Internal solid center prevents over-insertion of conductor
- UL Listed and CSA Certified to 35 KV** and temperature rated to 90°C when crimped with Panduit and specified competitor crimping tools and dies

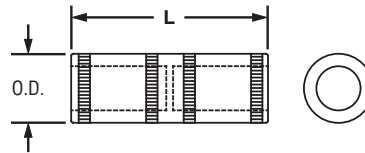

| Part Number | Aluminum or Copper Conductor Size | Figure Dimensions (In.) | | Panduit Color Code | Panduit Die Index No.‡ | Burdny Die Index No.‡ | T&B Die Index No.‡ | Wire Strip Length (In.) | Std. Pkg. Qty. |
|-------------|-----------------------------------|-------------------------|------|--------------------|------------------------|-----------------------|--------------------|-------------------------|----------------|
| | | Barrel O.D. | L | | | | | | |
| SA6-X | #6 AWG | 0.34 | 1.62 | Gray | P29 | 346 | 29 | 3/4 | 10 |
| SA4-X | #4 AWG | 0.48 | 2.13 | Green | P37 | 375 | 37 | 7/8 | 10 |
| SA2-X | #2 AWG | 0.53 | 2.00 | Pink | P42 | 348 | 45 | 7/16 | 10 |
| SA1-X | #1 AWG | 0.53 | 2.00 | Gold | P45 | 471 | 45 | 7/16 | 10 |
| SA1/0-X | 1/0 AWG | 0.64 | 2.12 | Tan | P50 | 296 | 50 | 1 | 10 |
| SA2/0-5 | 2/0 AWG | 0.69 | 2.31 | Olive | P54 | 297 | 54 | 1 1/8 | 5 |
| SA3/0-5 | 3/0 AWG | 0.76 | 2.62 | Ruby | P60 | 467 | 60 | 1 1/4 | 5 |
| SA4/0-5 | 4/0 AWG | 0.88 | 2.75 | White | P66 | 298 | 66 | 1 5/16 | 5 |
| SA250-5 | 250 kcmil | 0.91 | 2.94 | Red | P71 | 324 | 71 | 1 7/16 | 5 |
| SA300-2 | 300 kcmil | 1.01 | 3.12 | Blue | P76 | 470 | 76 | 1 1/2 | 2 |
| SA350-2 | 350 kcmil | 1.12 | 3.37 | Brown | P87 | 299 | 87 | 1 5/8 | 2 |
| SA400-2 | 400 kcmil | 1.19 | 3.75 | Green | P94 | 472 | 94 | 1 13/16 | 2 |
| SA500-2 | 500 kcmil | 1.32 | 3.87 | Pink | P99 | 300 | 99 | 1 7/8 | 2 |
| SA600-2 | 600 kcmil | 1.44 | 4.12 | Black | P106 | 473 | 106 | 2 | 2 |
| SA750-1 | 750 kcmil | 1.60 | 4.62 | Red | P125 | 301 | 115 | 2 1/4 | 1 |
| SA800-1 | 800 kcmil | 1.66 | 4.75 | Gray | P140 | 474 | 125 | 2 5/16 | 1 |
| SA1000-1 | 1000 kcmil | 1.84 | 5.25 | Brown | P161 | 302 | 161 | 2 9/16 | 1 |

‡See pages D3.84, D3.85 for tool and die information.

**Consult cable manufacturer for voltage stress relief instructions with applications greater than 2000 V.

See page D2.118 for Panduit joint compounds recommended for pad to pad and conductor connections.

A. System Overview

B1. Cable Ties

B2. Cable Accessories

B3. Stainless Steel Ties

C1. Wiring Duct

C2. Surface Raceway

C3. Abrasion Protection

C4. Cable Management

D1. Terminals

D2. Power Connectors

D3. Grounding Connectors

E1. Labeling Systems

E2. Labels

E3. Pre-Printed & Write-On Markers



E4. Permanent Identification

E5. Lockout/Tagout & Safety Solutions

F. Index

Looking for pricing, stock, or lifecycle information?

Click below to explore more details on WIN SOURCE:

-  [View SA2-X on WIN SOURCE](#)
-  [Panduit Corp](#) Information

Optimize Your Supply Chain with WIN SOURCE Solutions

-  Global Sourcing Solution
-  Obsolete Management
-  Cost Control Management
-  Shortage Management
-  Alternative Solution
-  Excess Inventory Management