



**THE DATASHEET OF
SE15PJ-M3/85A**



Surface Mount ESD Capability Rectifiers

eSMP® Series

SMP (DO-220AA)

Cathode Anode

LINKS TO ADDITIONAL RESOURCES



| PRIMARY CHARACTERISTICS | |
|-------------------------|----------------------------|
| $I_{F(AV)}$ | 1.5 A |
| V_{RRM} | 100 V, 200 V, 400 V, 600 V |
| I_{FSM} | 30 A |
| I_R | 5 μ A |
| V_F at $I_F = 1.0$ A | 0.868 V |
| T_J max. | 175 °C |
| Package | SMP (DO-220AA) |
| Circuit configuration | Single |

FEATURES

- Very low profile - typical height of 1.0 mm
- Ideal for automated placement
- Oxide planar chip junction
- Low forward voltage drop
- Typical I_R less than 0.1 μ A
- ESD capability
- Meets MSL level 1, per J-STD-020, LF maximum peak of 260 °C
- AEC-Q101 qualified
- Material categorization: for definitions of compliance please see www.vishay.com/doc?99912

AUTOMOTIVE GRADE

RoHS
COMPLIANT
HALOGEN
FREE

TYPICAL APPLICATIONS

General purpose, power line polarity protection and rail-to-rail protection in consumer, industrial, and automotive applications.

MECHANICAL DATA

Case: SMP (DO-220AA)

Molding compound meets UL 94 V-0 flammability rating
Base P/N-M3 - halogen-free, RoHS-compliant, and commercial grade

Base P/NHM3 - halogen-free, RoHS-compliant, and automotive grade

Terminals: matte tin plated leads, solderable per J-STD-002 and JESD 22-B102

M3 suffix meets JESD 201 class 1A whisker test, HM3 suffix meets JESD 201 class 2 whisker test

| MAXIMUM RATINGS ($T_A = 25$ °C unless otherwise noted) | | | | | | |
|---|----------------|-------------|--------|--------|--------|------|
| PARAMETER | SYMBOL | SE15PB | SE15PD | SE15PG | SE15PJ | UNIT |
| Device marking code | | 15B | 15D | 15G | 15J | |
| Max. repetitive peak reverse voltage | V_{RRM} | 100 | 200 | 400 | 600 | V |
| Average forward current (fig. 1) | $I_{F(AV)}$ | 1.5 | | | | A |
| Peak forward surge current 10 ms single half sine-wave superimposed on rated load | I_{FSM} | 30 | | | | A |
| Operating junction and storage temperature range | T_J, T_{STG} | -55 to +175 | | | | °C |



| ELECTRICAL CHARACTERISTICS ($T_A = 25\text{ }^\circ\text{C}$ unless otherwise noted) | | | | | | |
|---|---|-----------------------------------|-------------|-------|------|---------------|
| PARAMETER | TEST CONDITIONS | SYMBOL | TYP. | MAX. | UNIT | |
| Max. instantaneous forward voltage | $I_F = 1.5\text{ A}$ | $T_A = 25\text{ }^\circ\text{C}$ | $V_F^{(1)}$ | 0.968 | 1.05 | V |
| | | $T_A = 125\text{ }^\circ\text{C}$ | | 0.868 | 0.95 | |
| Max. reverse current | Rated V_R | $T_A = 25\text{ }^\circ\text{C}$ | $I_R^{(2)}$ | - | 5.0 | μA |
| | | $T_A = 125\text{ }^\circ\text{C}$ | | 5.4 | 50 | |
| Max. reverse recovery time | $I_F = 0.5\text{ A}$, $I_R = 1.0\text{ A}$, $I_{rr} = 0.25\text{ A}$ | t_{rr} | 900 | - | ns | |
| Typical junction capacitance | 4.0 V, 1 MHz | C_J | 9.5 | - | pF | |

Notes

- (1) Pulse test: 300 μs pulse width, 1 % duty cycle
(2) Pulse test: Pulse width $\leq 40\text{ ms}$

| THERMAL CHARACTERISTICS ($T_A = 25\text{ }^\circ\text{C}$ unless otherwise noted) | | | | | | |
|--|-----------------------|--------|--------|--------|--------|--------------------|
| PARAMETER | SYMBOL | SE15PB | SE15PD | SE15PG | SE15PJ | UNIT |
| Typical thermal resistance | $R_{\theta JA}^{(1)}$ | 105 | | | | $^\circ\text{C/W}$ |
| | $R_{\theta JL}^{(1)}$ | 25 | | | | |
| | $R_{\theta JC}^{(1)}$ | 30 | | | | |

Note

- (1) Thermal resistance from junction to ambient and junction to lead mounted on PCB with 5.0 mm x 5.0 mm copper pad areas. $R_{\theta JL}$ - is measured at the terminal of cathode band. $R_{\theta JC}$ is measured at the top center of the body.

| IMMUNITY TO ELECTRICAL STATIC DISCHARGE TO THE FOLLOWING STANDARDS ($T_A = 25\text{ }^\circ\text{C}$ unless otherwise noted) | | | | | |
|--|--|--|--------|-------|---------|
| STANDARD | TEST TYPE | TEST CONDITIONS | SYMBOL | CLASS | VALUE |
| AEC-Q101-001 | Human body model (contact mode) | $C = 100\text{ pF}$, $R = 1.5\text{ k}\Omega$ | V_C | H3B | > 8 kV |
| AEC-Q101-002 | Machine model (contact mode) | $C = 200\text{ pF}$, $R = 0\text{ }\Omega$ | | M4 | > 400 V |
| JESD22-A114 | Human body model (contact mode) | $C = 100\text{ pF}$, $R = 1.5\text{ k}\Omega$ | | 3B | > 8 kV |
| JESD22-A115 | Machine model (contact mode) | $C = 200\text{ pF}$, $R = 0\text{ }\Omega$ | | C | > 400 V |
| IEC 61000-4-2 ⁽²⁾ | Human body model (contact mode) | $C = 150\text{ pF}$, $R = 330\text{ }\Omega$ | | 4 | > 8 kV |
| | Human body model (air-discharge mode) ⁽¹⁾ | $C = 150\text{ pF}$, $R = 330\text{ }\Omega$ | | 4 | > 15 kV |

Notes

- (1) Immunity to IEC 61000-4-2 air discharge mode has a typical performance > 30 kV
(2) System ESD standard

| ORDERING INFORMATION (Example) | | | | |
|--------------------------------|-----------------|------------------------|---------------|------------------------------------|
| PREFERRED P/N | UNIT WEIGHT (g) | PREFERRED PACKAGE CODE | BASE QUANTITY | DELIVERY MODE |
| SE15PJ-M3/84A | 0.024 | 84A | 3000 | 7" diameter plastic tape and reel |
| SE15PJ-M3/85A | 0.024 | 85A | 10 000 | 13" diameter plastic tape and reel |
| SE15PJHM3/84A ⁽¹⁾ | 0.024 | 84A | 3000 | 7" diameter plastic tape and reel |
| SE15PJHM3/85A ⁽¹⁾ | 0.024 | 85A | 10 000 | 13" diameter plastic tape and reel |

Note

- (1) Automotive grade



RATINGS AND CHARACTERISTICS CURVES (T_A = 25 °C unless otherwise noted)

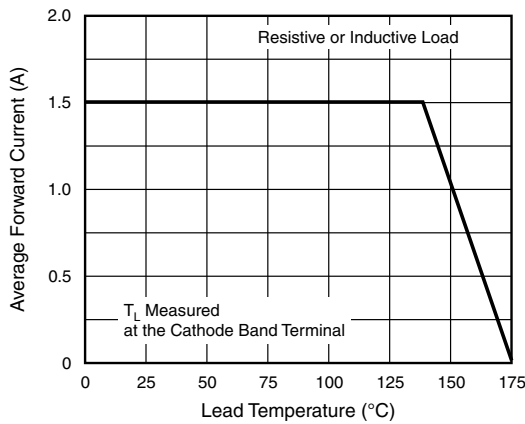

Fig. 1 - Max. Forward Current Derating Curve

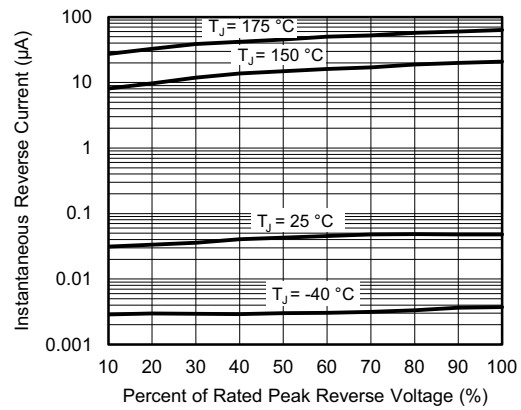

Fig. 4 - Typical Instantaneous Forward Characteristics

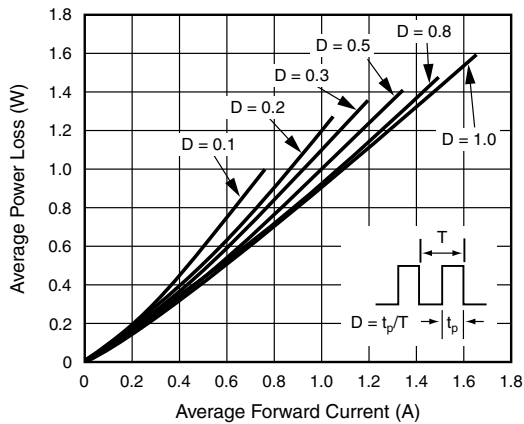

Fig. 2 - Forward Power Loss Characteristics

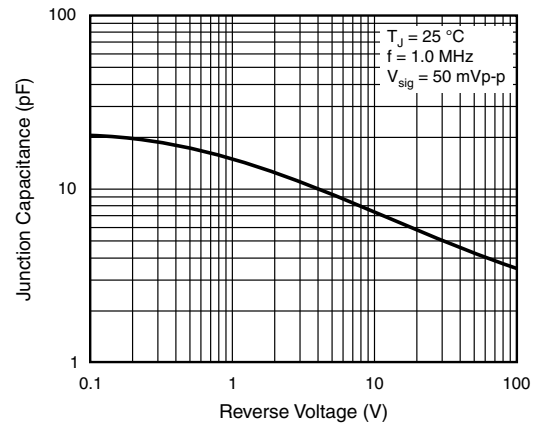

Fig. 5 - Typical Instantaneous Forward Characteristics

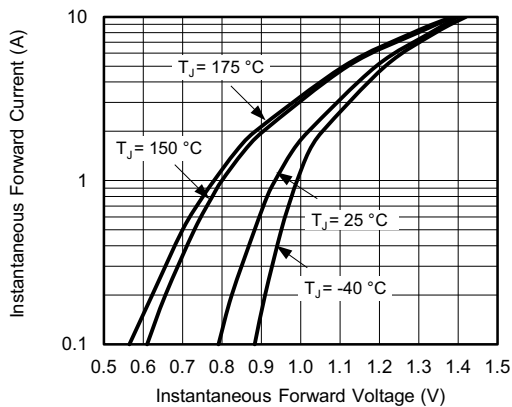
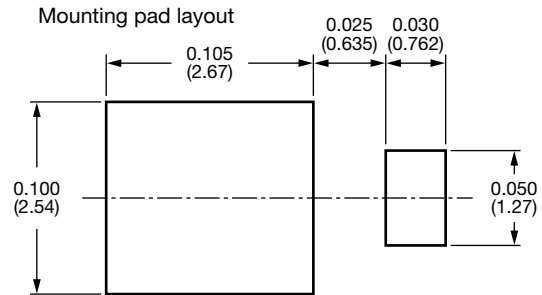
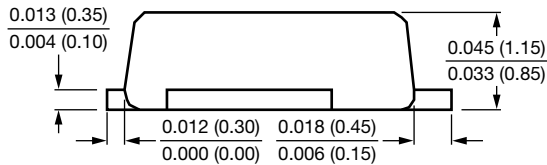
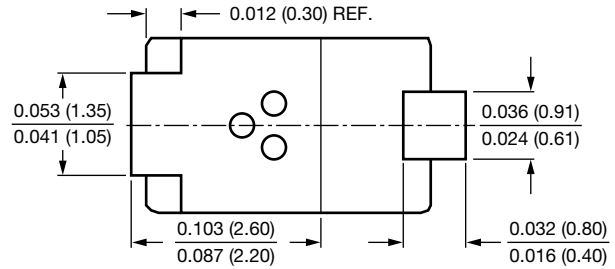
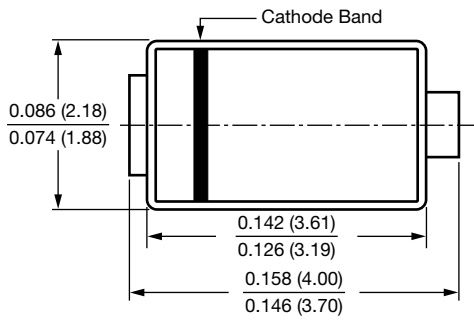

Fig. 3 - Forward Power Loss Characteristics



PACKAGE OUTLINE DIMENSIONS in inches (millimeters)

SMP (DO-220AA)





Disclaimer

ALL PRODUCT, PRODUCT SPECIFICATIONS AND DATA ARE SUBJECT TO CHANGE WITHOUT NOTICE TO IMPROVE RELIABILITY, FUNCTION OR DESIGN OR OTHERWISE.

Vishay Intertechnology, Inc., its affiliates, agents, and employees, and all persons acting on its or their behalf (collectively, "Vishay"), disclaim any and all liability for any errors, inaccuracies or incompleteness contained in any datasheet or in any other disclosure relating to any product.

Vishay makes no warranty, representation or guarantee regarding the suitability of the products for any particular purpose or the continuing production of any product. To the maximum extent permitted by applicable law, Vishay disclaims (i) any and all liability arising out of the application or use of any product, (ii) any and all liability, including without limitation special, consequential or incidental damages, and (iii) any and all implied warranties, including warranties of fitness for particular purpose, non-infringement and merchantability.

Statements regarding the suitability of products for certain types of applications are based on Vishay's knowledge of typical requirements that are often placed on Vishay products in generic applications. Such statements are not binding statements about the suitability of products for a particular application. It is the customer's responsibility to validate that a particular product with the properties described in the product specification is suitable for use in a particular application. Parameters provided in datasheets and / or specifications may vary in different applications and performance may vary over time. All operating parameters, including typical parameters, must be validated for each customer application by the customer's technical experts. Product specifications do not expand or otherwise modify Vishay's terms and conditions of purchase, including but not limited to the warranty expressed therein.

Hyperlinks included in this datasheet may direct users to third-party websites. These links are provided as a convenience and for informational purposes only. Inclusion of these hyperlinks does not constitute an endorsement or an approval by Vishay of any of the products, services or opinions of the corporation, organization or individual associated with the third-party website. Vishay disclaims any and all liability and bears no responsibility for the accuracy, legality or content of the third-party website or for that of subsequent links.

Except as expressly indicated in writing, Vishay products are not designed for use in medical, life-saving, or life-sustaining applications or for any other application in which the failure of the Vishay product could result in personal injury or death. Customers using or selling Vishay products not expressly indicated for use in such applications do so at their own risk. Please contact authorized Vishay personnel to obtain written terms and conditions regarding products designed for such applications.

No license, express or implied, by estoppel or otherwise, to any intellectual property rights is granted by this document or by any conduct of Vishay. Product names and markings noted herein may be trademarks of their respective owners.

Looking for pricing, stock, or lifecycle information?

Click below to explore more details on WIN SOURCE:

 [View SE15PJ-M3/85A on WIN SOURCE](#)

 [Vishay Information](#)

Optimize Your Supply Chain with WIN SOURCE Solutions

-  Global Sourcing Solution
-  Obsolete Management
-  Cost Control Management
-  Shortage Management
-  Alternative Solution
-  Excess Inventory Management