



**THE DATASHEET OF
SMPZ3933B-E3/84A**



Surface Mount Power Voltage-Regulating Diodes

eSMP® Series

SMP (DO-220AA)

Anode Cathode

**RoHS
COMPLIANT
HALOGEN
FREE**

FEATURES

- Very low profile - typical height of 1.0 mm
- Ideal for automated placement
- Low Zener impedance
- Low regulation factor
- Meets MSL level 1, per J-STD-020, LF maximum peak of 260 °C
- Material categorization: for definitions of compliance please see www.vishay.com/doc?99912

TYPICAL APPLICATIONS

For general purpose regulation, industrial, and protection applications.

MECHANICAL DATA

Case: SMP (DO-220AA)

Molding compound meets UL 94 V-0 flammability rating
Base P/N-M3 - halogen-free, RoHS-compliant, and industrial grade

Terminals: matte tin plated leads, solderable per J-STD-002 and JESD 22-B102

M3 suffix meets JESD 201 class 1A whisker test

Polarity: color band denotes cathode end

LINKS TO ADDITIONAL RESOURCES



PRIMARY CHARACTERISTICS	
V_Z	5.6 V to 43 V
P_{tot} at $T_L = 75\text{ °C}$	1500 mW
P_{tot} at $T_L = 25\text{ °C}$	500 mW
T_J max.	150 °C
V_Z specification	Pulse current
Package	SMP (DO-220AA)
Circuit configuration	Single

PACKAGE				
PACKAGE NAME	WEIGHT	MOLDING COMPOUND FLAMMABILITY RATING	MOISTURE SENSITIVITY LEVEL	SOLDERING CONDITIONS
SMP (DO-220AA)	24 mg	UL 94 V-0	MSL level 1 (according J-STD-020)	260 °C/10 s at terminals

MAXIMUM RATINGS ($T_A = 25\text{ °C}$ unless otherwise noted)			
PARAMETER	SYMBOL	VALUE	UNIT
Power dissipation at $T_L = 75\text{ °C}$ (fig. 1) ⁽¹⁾	P_{tot}	1500	mW
Power dissipation at $T_A = 25\text{ °C}$ (fig. 1) ⁽²⁾	P_{tot}	500	mW
Maximum instantaneous forward voltage at 200 mA for all types ⁽³⁾	V_F	1.5	V
Operating junction and storage temperature range	T_J, T_{STG}	-65 to +150	°C

Notes

- (1) Mounted on PCB with 5.0 mm x 5.0 mm copper pads attached to each terminal
- (2) Mounted on minimum recommended pad layout
- (3) Pulse test: 300 μ s pulse width, 1 % duty cycle



ELECTRICAL CHARACTERISTICS	
SYMBOL	PARAMETER
V_Z	Reverse Zener voltage at I_{ZT}
I_{ZT}	Reverse current
Z_{ZT}	Maximum Zener impedance at I_{ZT}
I_{ZK}	Reverse current
Z_{ZK}	Maximum Zener impedance at I_{ZK}
I_R	Reverse leakage current at V_R
V_R	Reverse voltage
I_F	Forward current
V_F	Forward voltage at I_F
I_{ZM}	Maximum DC Zener current



Zener Voltage Regulator

ELECTRICAL CHARACTERISTICS ($T_A = 25^\circ\text{C}$ unless otherwise noted)											
PART NUMBER	DEVICE MARKING CODE	ZENER VOLTAGE RANGE			TEST CURRENT		MAXIMUM ZENER IMPEDANCE		MAXIMUM REVERSE LEAKAGE CURRENT		MAXIMUM ZENER CURRENT
		V_Z at I_{ZT}			I_{ZT}	I_{ZK}	Z_{ZT} AT I_{ZT}	Z_{ZK} AT I_{ZK}	I_R AT V_R		I_{ZM}
		V			mA		Ω		μA	V	mA
		MIN.	NOM.	MAX.			MAX.	MAX.	MAX.		MAX.
SMPZ3919B	19B	5.32	5.6	5.88	66.9	1.0	5.0	700	200	3.0	268
SMPZ3920B	20B	5.89	6.2	6.51	60.5	1.0	2.0	700	200	4.0	242
SMPZ3921B	21B	6.46	6.8	7.14	55.1	1.0	2.5	400	200	5.2	221
SMPZ3922B	22B	7.12	7.5	7.88	50.0	0.5	3.0	400	150	6.0	200
SMPZ3923B	23B	7.79	8.2	8.61	45.7	0.5	3.5	400	50	6.5	183
SMPZ3924B	24B	8.64	9.1	9.56	41.2	0.5	4.0	500	10	7.0	165
SMPZ3925B	25B	9.5	10	10.5	37.5	0.25	4.5	500	2.5	8.0	150
SMPZ3926B	26B	10.5	11	11.6	34.1	0.25	5.5	550	0.5	8.4	136
SMPZ3927B	27B	11.4	12	12.6	31.2	0.25	6.5	550	0.5	9.1	125
SMPZ3928B	28B	12.4	13	13.7	28.8	0.25	7.0	550	0.5	9.9	115
SMPZ3929B	29B	14.3	15	15.8	25	0.25	9.0	600	0.5	11.4	100
SMPZ3930B	30B	15.2	16	16.8	23.4	0.25	10.0	600	0.5	12.2	94
SMPZ3931B	31B	17.1	18	18.9	20.8	0.25	12.0	650	0.5	13.7	83
SMPZ3932B	32B	19.0	20	21	18.7	0.25	14.0	650	0.5	15.2	75
SMPZ3933B	33B	20.9	22	23.1	17.0	0.25	17.5	650	0.5	16.7	68
SMPZ3934B	34B	22.8	24	25.2	15.6	0.25	19.0	700	0.5	18.2	63
SMPZ3935B	35B	25.7	27	28.4	13.9	0.25	23.0	700	0.5	20.6	56
SMPZ3936B	36B	28.5	30	31.5	12.5	0.25	26.0	750	0.5	22.8	50
SMPZ3937B	37B	31.4	33	34.7	11.4	0.25	33.0	800	0.5	25.1	45
SMPZ3938B	38B	34.2	36	37.8	10.4	0.25	38.0	850	0.5	27.4	42
SMPZ3939B	39B	37.1	39	41	9.6	0.25	45.0	900	0.5	29.7	38
SMPZ3940B	40B	40.9	43	45.2	8.7	0.25	53.0	950	0.5	32.7	35

THERMAL CHARACTERISTICS ($T_A = 25^\circ\text{C}$ unless otherwise noted)			
PARAMETER	SYMBOL	LIMIT	UNIT
Typical thermal resistance, junction to lead ⁽¹⁾	$R_{\theta JL}$	50	$^\circ\text{C/W}$
Typical thermal resistance, junction to ambient ⁽²⁾	$R_{\theta JA}$	250	$^\circ\text{C/W}$

Notes

- (1) Mounted on PCB with 5.0 mm x 5.0 mm copper pad areas attached to each terminal
- (2) Mounted on minimum recommended pad layout



ORDERING INFORMATION (Example)				
PREFERRED P/N	UNIT WEIGHT (g)	PREFERRED PACKAGE CODE	BASE QUANTITY	DELIVERY MODE
SMPZ3919B-M3/84A	0.024	84A	3000	7" diameter plastic tape and reel
SMPZ3919B-M3/85A	0.024	85A	10 000	13" diameter plastic tape and reel

RATINGS AND CHARACTERISTICS CURVES ($T_A = 25\text{ }^\circ\text{C}$ unless otherwise noted)



Fig. 1 - Steady State Power Derating



Fig. 3 - Typical Zener Voltage



Fig. 2 - Typical Zener Voltage



Fig. 4 - Typical temperature Coefficients



Fig. 5 - Typical Transient Temperature Coefficients



Fig. 6 - Typical Junction Capacitance

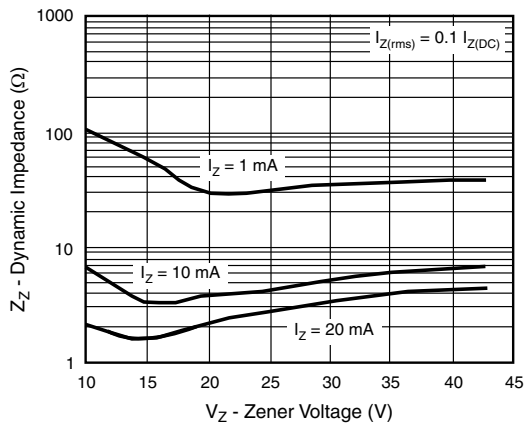
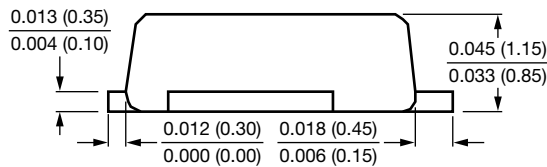
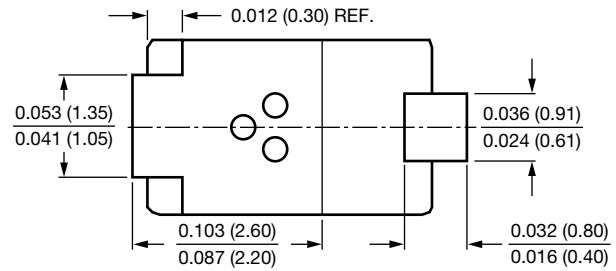

Fig. 7 - Typical Zener Impedance



PACKAGE OUTLINE DIMENSIONS in inches (millimeters)

SMP (DO-220AA)





Disclaimer

ALL PRODUCT, PRODUCT SPECIFICATIONS AND DATA ARE SUBJECT TO CHANGE WITHOUT NOTICE TO IMPROVE RELIABILITY, FUNCTION OR DESIGN OR OTHERWISE.

Vishay Intertechnology, Inc., its affiliates, agents, and employees, and all persons acting on its or their behalf (collectively, "Vishay"), disclaim any and all liability for any errors, inaccuracies or incompleteness contained in any datasheet or in any other disclosure relating to any product.

Vishay makes no warranty, representation or guarantee regarding the suitability of the products for any particular purpose or the continuing production of any product. To the maximum extent permitted by applicable law, Vishay disclaims (i) any and all liability arising out of the application or use of any product, (ii) any and all liability, including without limitation special, consequential or incidental damages, and (iii) any and all implied warranties, including warranties of fitness for particular purpose, non-infringement and merchantability.

Statements regarding the suitability of products for certain types of applications are based on Vishay's knowledge of typical requirements that are often placed on Vishay products in generic applications. Such statements are not binding statements about the suitability of products for a particular application. It is the customer's responsibility to validate that a particular product with the properties described in the product specification is suitable for use in a particular application. Parameters provided in datasheets and / or specifications may vary in different applications and performance may vary over time. All operating parameters, including typical parameters, must be validated for each customer application by the customer's technical experts. Product specifications do not expand or otherwise modify Vishay's terms and conditions of purchase, including but not limited to the warranty expressed therein.

Hyperlinks included in this datasheet may direct users to third-party websites. These links are provided as a convenience and for informational purposes only. Inclusion of these hyperlinks does not constitute an endorsement or an approval by Vishay of any of the products, services or opinions of the corporation, organization or individual associated with the third-party website. Vishay disclaims any and all liability and bears no responsibility for the accuracy, legality or content of the third-party website or for that of subsequent links.

Vishay products are not designed for use in life-saving or life-sustaining applications or any application in which the failure of the Vishay product could result in personal injury or death unless specifically qualified in writing by Vishay. Customers using or selling Vishay products not expressly indicated for use in such applications do so at their own risk. Please contact authorized Vishay personnel to obtain written terms and conditions regarding products designed for such applications.

No license, express or implied, by estoppel or otherwise, to any intellectual property rights is granted by this document or by any conduct of Vishay. Product names and markings noted herein may be trademarks of their respective owners.

Looking for pricing, stock, or lifecycle information?

Click below to explore more details on WIN SOURCE:

 [View SMPZ3933B-E3/84A on WIN SOURCE](#)

 [Vishay Information](#)

Optimize Your Supply Chain with WIN SOURCE Solutions

-  Global Sourcing Solution
-  Obsolete Management
-  Cost Control Management
-  Shortage Management
-  Alternative Solution
-  Excess Inventory Management