



**THE DATASHEET OF  
M701-330442**



IF IN DOUBT - ASK



NOT TO SCALE

THIRD ANGLE PROJECTION

ALL DIMENSIONS IN mm

## SPECIFICATIONS:

MATERIAL:-

MOULDING: PBT G.F. UL94V-0, WHITE  
CONTACT: PHOSPHOR BRONZE, T=0.25

FINISH:-

SELECTIVE GOLD

ELECTRICAL:-

CURRENT RATING: 1.5 AMP

WORKING VOLTAGE: 30V AC/DC

WITHSTANDING VOLTAGE: 500V AC/MINUTE

CONTACT RESISTANCE: 30 mΩ MAX.

INSULATION RESISTANCE: 1000 MΩ MIN.

MECHANICAL:-

DURABILITY: 1500 CYCLES MIN.

MATING FORCE: 35N MAX.

WITHDRAWAL FORCE: 10N MIN.

ENVIRONMENTAL:-

TEMPERATURE RANGE: -55°C TO +85°C

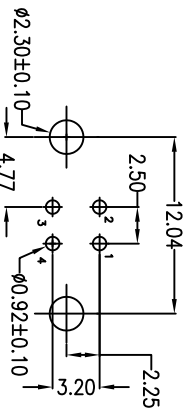
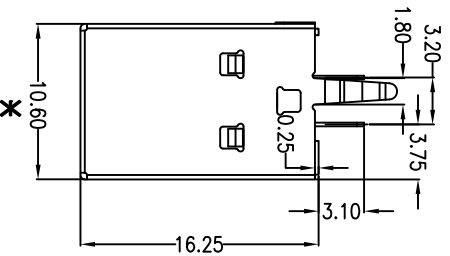

Recommended PCB Layout

NOTES: ALL DIMENSIONS AND NOTES  
MARKED \* ARE CRITICAL AND  
MUST BE CHECKED IN ACCORDANCE  
WITH QUALITY DOC. QI-02A

NAME	ISS.	DATE	C/NOTE
Leo	4	28.10.15	A471
Leo	3	02.10.15	A468
Alien	2	16.07.09	A220
Alien	1	01.08.06	--

APPROVED: B.Lim

CHECKED: D.P

DRAWN: Leo

CUSTOMER REF.:

ASSEMBLY DRG:

MATERIAL:

SEE NOTES

TITLE:

USB B TYPE FEMALE DIP 180°

FINISH:

SEE NOTES

DRAWING NUMBER:

M701-330442

S/AREA:

mm?

SHT

1 OF 1



THIS DRAWING AND ANY  
INFORMATION OR DESCRIPTIVE  
MATTER SET OUT HEREON ARE  
CONFIDENTIAL AND COPYRIGHT  
PROPERTY OF THE HAWKINS  
GROUP AND MUST NOT BE  
DISCLOSED, LOANED, COPIED,  
OR USED FOR MANUFACTURING,  
TENDERING OR FOR ANY  
OTHER PURPOSE WITHOUT  
THEIR WRITTEN PERMISSION.

TOLERANCES  
LINEAR  
XX =  $\pm 0.38mm$   
XXX =  $\pm 0.25mm$   
X.XXX =  $\pm 0.13mm$   
ANGLES  
XX =  $\pm 2^\circ$   
XXX =  $\pm 1^\circ$   
X.XXX =  $\pm 0.5^\circ$   
UNLESS STATED

IN Asia  
6 779 4909  
6 779 3868  
win.com.sg

## Looking for pricing, stock, or lifecycle information?

Click below to explore more details on WIN SOURCE:

-  [View M701-330442 on WIN SOURCE](#)
-  [Harwin Inc. Information](#)

## Optimize Your Supply Chain with WIN SOURCE Solutions

-  Global Sourcing Solution
-  Obsolete Management
-  Cost Control Management
-  Shortage Management
-  Alternative Solution
-  Excess Inventory Management