



**THE DATASHEET OF  
KMR211GLFS**





# KMR 2 Series Microminiature Tact Switch for SMT

Tactile Switches

## G - Ground Pin

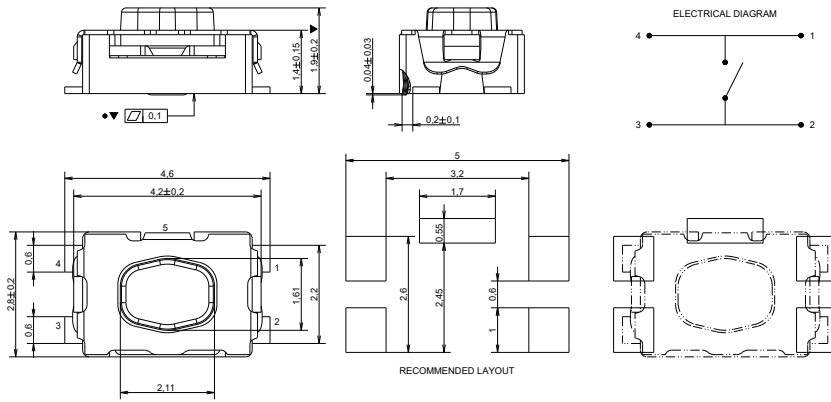

## NG - No Ground Pin

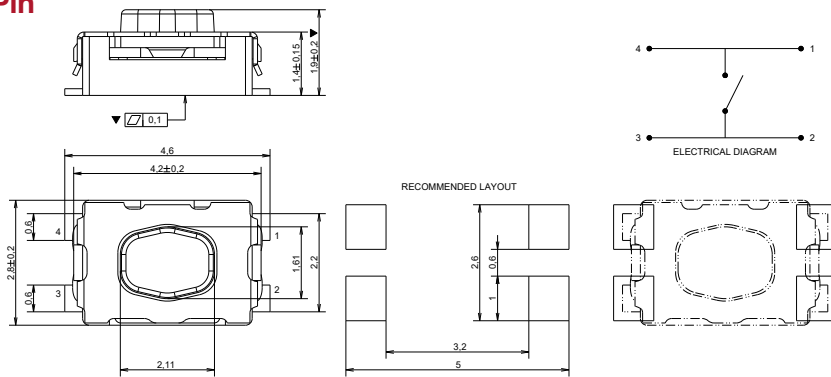

## TAPE & REEL

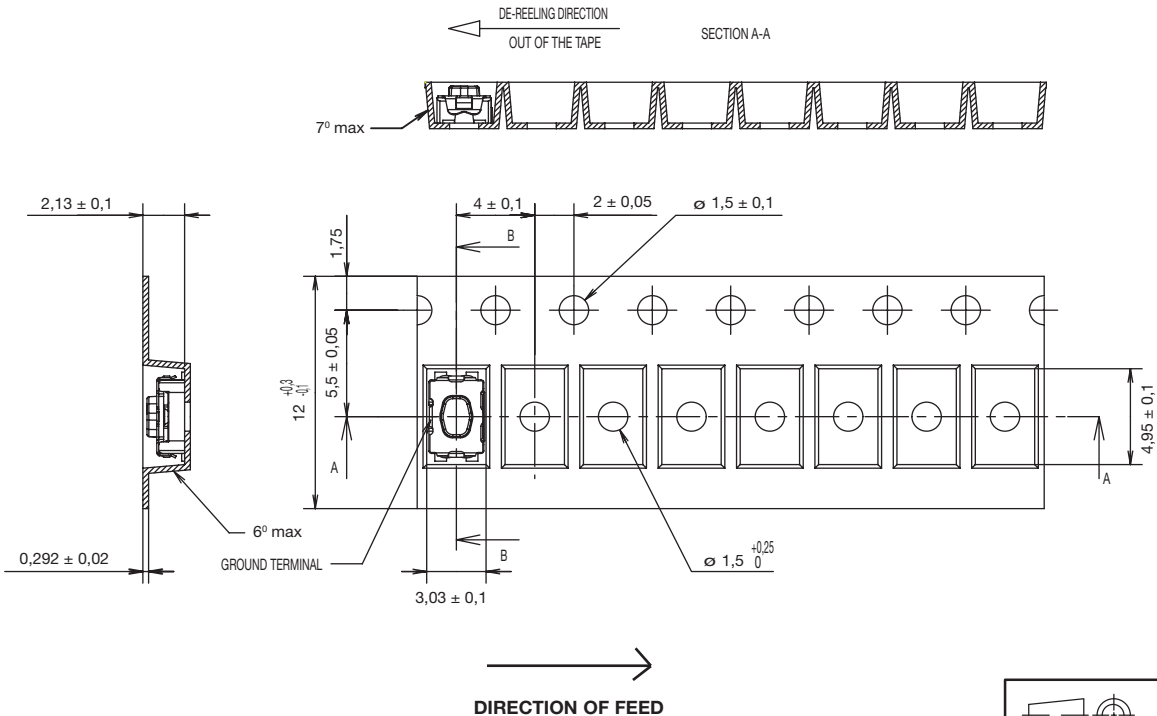

Dimensions are shown: mm  
Specifications and dimensions subject to change



## Looking for pricing, stock, or lifecycle information?

Click below to explore more details on WIN SOURCE:

- ⊖ [View KMR211GLFS on WIN SOURCE](#)
- ⊖ [C&K Components Information](#)

## Optimize Your Supply Chain with WIN SOURCE Solutions

- ✓ Global Sourcing Solution
- ✓ Obsolete Management
- ✓ Cost Control Management
- ✓ Shortage Management
- ✓ Alternative Solution
- ✓ Excess Inventory Management