

DESCRIPTION: DSUB IP67 FLANGE // FEMALE // STANDARD // RIGHT ANGLE PIN PCB MOUNT

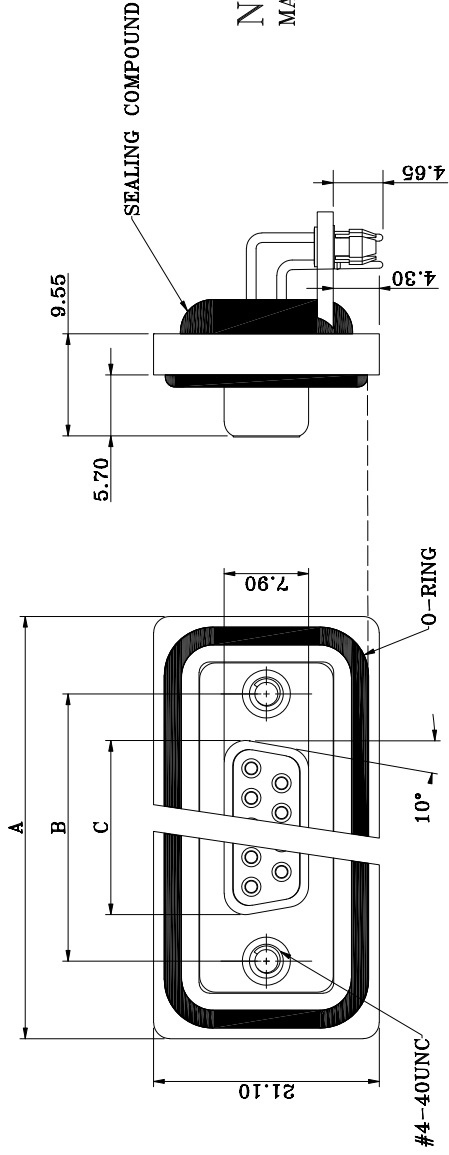

*±0.65 AT CONTACT PCB TERMINATION LOCATION

HARDWARE OPTIONS

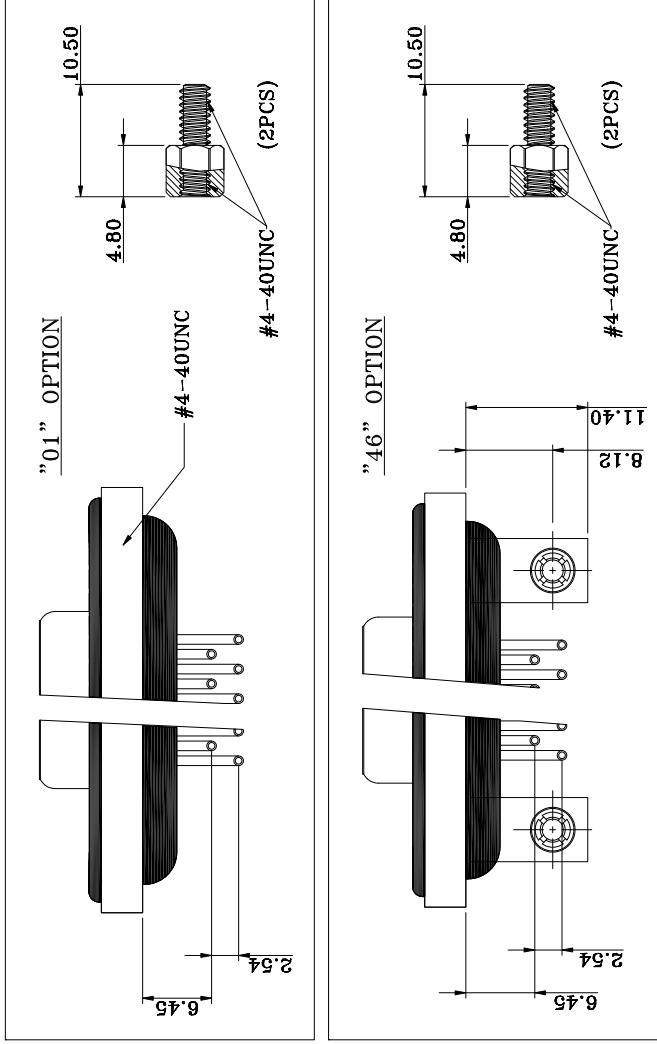

NOTE:

- MATERIAL
- HOUSING
- FLANGE
- CONTACT
- SHELL
- O-RING
- SEALING COMPOUND
- HARDWARE

- ELECTRICAL
- RATED CURRENT
- VOLTAGE
- INSULATOR RESISTANCE
- CONTACT RESISTANCE
- WATER PROOF
- ENVIRONMENT
- OPERATION TEMPERATURE

- SERIES
- SDF = STANDARD DSUB F
- CONTACT TYPE
- R = RIGHT ANGLE PCB M
- POSITIONS

- 09
- 15
- 25
- 37

- GENDER

- 2 = FEMALE
- HARDWARE OPTIONS

- 01 = 4-40 THREADED INS
- 46 = 4-40 THREADED BR

BOARD LOCKS

- CONTACT PLATING OPTIONS
- 1 = GOLD FLASH
- 2 = 30u" GOLD PLATING

SIZE
9
15
25
37

ROHS COMPLIANT



THESE DRAWINGS AND SPECIFICATIONS ARE THE PROPERTY OF NorComp AND SHALL NOT BE REPRODUCED, COPIED OR USED AS THE BASIS FOR THE MANUFACTURE OR SALE OF APPARATUS WITHOUT WRITTEN PERMISSION.

DRAWN:

J. KADEL

DATE:

03/02/2020

TOLERANCES

- X. ±0.40
- .X ±0.30
- .XX ±0.20
- .XXX ±0.10

UNITS = mm

DO NOT S

SCALE:

NorComp

NTS

DWG NO.

DESCRIPTION: DSUB IP67 FLANGE // FEMALE // STANDARD // RIGHT ANGLE PIN PCB MOUNT

**** ϕ 3.20MM HOLES NOT NEEDED FOR "01" HARDWARE OPTION**

09 POSITION

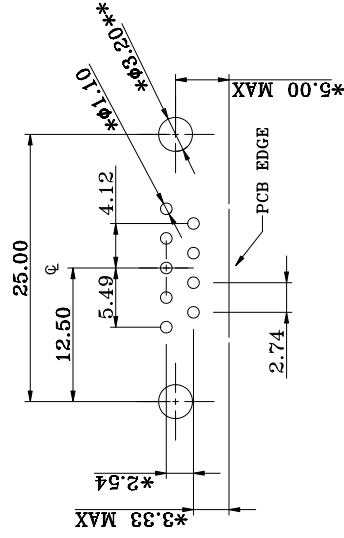

15 POSITION

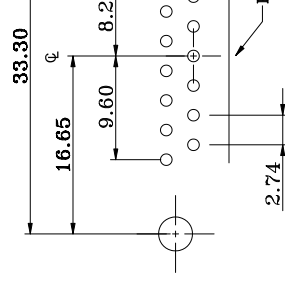

25 POSITION

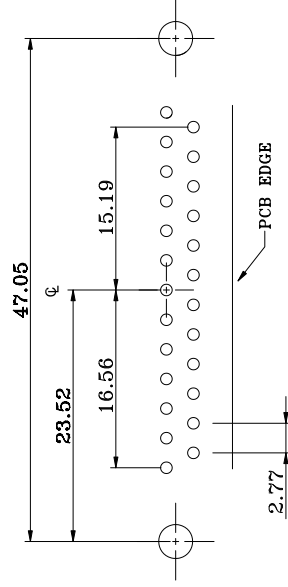

37 POSITION

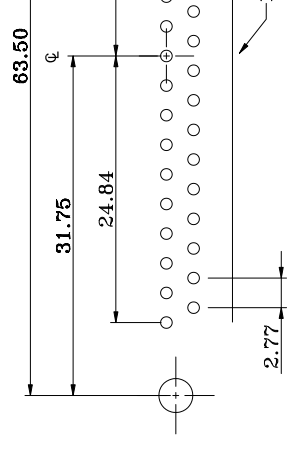

RECOMMENDED PCB LAYOUT

***TYPICAL // HOLE SIZE MAY NOT BE SUITABLE FOR YOUR SPECIFIC APPLICATION**

ROHS COMPLIANT



THESE DRAWINGS AND SPECIFICATIONS ARE THE PROPERTY OF NorComp AND SHALL NOT BE REPRODUCED, COPIED OR USED AS THE BASIS FOR THE MANUFACTURE OR SALE OF APPARATUS WITHOUT WRITTEN PERMISSION.

DRAWN: J. KADEL
DATE: 03/02/2020

UNITS = mm

DO NOT S

TOLERANCES
X. ± 0.40
.X ± 0.30
.XX ± 0.20
.XXX ± 0.10

SCALE: NTS
DWG NO.

NorComp

Looking for pricing, stock, or lifecycle information?

Click below to explore more details on WIN SOURCE:

 [View SDF-R25-213L011 on WIN SOURCE](#)

 [NorComp Inc. Information](#)

Optimize Your Supply Chain with WIN SOURCE Solutions

-  Global Sourcing Solution
-  Obsolete Management
-  Cost Control Management
-  Shortage Management
-  Alternative Solution
-  Excess Inventory Management