



**THE DATASHEET OF  
NPPN061BFLD-RC**



POSITIONS/ CONTACTS	A		B	
	INCH	MM	INCH	MM
02/02	0.079	2.00	0.177	4.50
03/03	0.157	4.00	0.256	6.50
04/04	0.236	6.00	0.335	8.50
05/05	0.315	8.00	0.413	10.50
06/06	0.394	10.00	0.492	12.50
07/07	0.472	12.00	0.571	14.50
08/08	0.551	14.00	0.650	16.50
09/09	0.630	16.00	0.728	18.50
10/10	0.709	18.00	0.807	20.50
11/11	0.787	20.00	0.886	22.50
12/12	0.866	22.00	0.965	24.50
13/13	0.945	24.00	1.043	26.50
14/14	1.024	26.00	1.122	28.50
15/15	1.102	28.00	1.201	30.50
16/16	1.181	30.00	1.280	32.50
17/17	1.260	32.00	1.358	34.50
18/18	1.339	34.00	1.437	36.50
19/19	1.417	36.00	1.516	38.50
20/20	1.496	38.00	1.594	40.50
21/21	1.575	40.00	1.673	42.50
22/22	1.654	42.00	1.752	44.50
23/23	1.732	44.00	1.831	46.50
24/24	1.811	46.00	1.909	48.50
25/25	1.890	48.00	1.988	50.50
26/26	1.969	50.00	2.067	52.50
27/27	2.047	52.00	2.146	54.50
28/28	2.126	54.00	2.224	56.50
29/29	2.205	56.00	2.303	58.50
30/30	2.283	58.00	2.382	60.50
31/31	2.362	60.00	2.461	62.50
32/32	2.441	62.00	2.539	64.50
33/33	2.520	64.00	2.618	66.50
34/34	2.598	66.00	2.697	68.50
35/35	2.677	68.00	2.776	70.50
36/36	2.756	70.00	2.854	72.50
37/37	2.835	72.00	2.933	74.50
38/38	2.913	74.00	3.012	76.50
39/39	2.992	76.00	3.091	78.50
40/40	3.071	78.00	3.169	80.50

**PART NUMBER CODING**

**xPxNxx1BFLx-RC**

**TERMINATION TYPES**

(EVEN NO. OF POSITIONS)  
 C - SMT, SINGLE ROW, PIN 1 LEFT  
 D - SMT, SINGLE ROW, PIN 1 RIGHT

**NUMBER OF POSITIONS**

(CONTACTS PER ROW, 02 THRU 40)

**PLATING**

(.000030" ~ .000050" NICKEL UNDERPLATE)  
 P = GOLD FLASH OVERALL  
 C = .000030" GOLD ON CONTACT SURFACE,  
 .000100" PURE TIN, MATTE ON TERMINATION

**INSULATOR MATERIAL**

N = NYLON 6T  
 OPERATING TEMPERATURE: -40 °C TO +105 °C  
 PROCESSING TEMPERATURE: WAVE / MANUAL SOLDERING  
 L = LCP  
 OPERATING TEMPERATURE: -40 °C TO +125°C  
 PROCESSING TEMP: 260°C MAX FOR 10 SECONDS

REVISIONS				
REV.	ECO. NO	DESCRIPTION	DATE	BY
E	2515	UPDATE CONTACT POINT DIST TO REF, ADD NOTE 11 MATING PARTS	01/16/2012	LH
F	2829	ADD INSULATOR MATERIAL 'LCP' AND 'C' PLATING OPTIONS, UPDATE OPERATING TEMPERATURE	12/10/2014	LH/JHSU

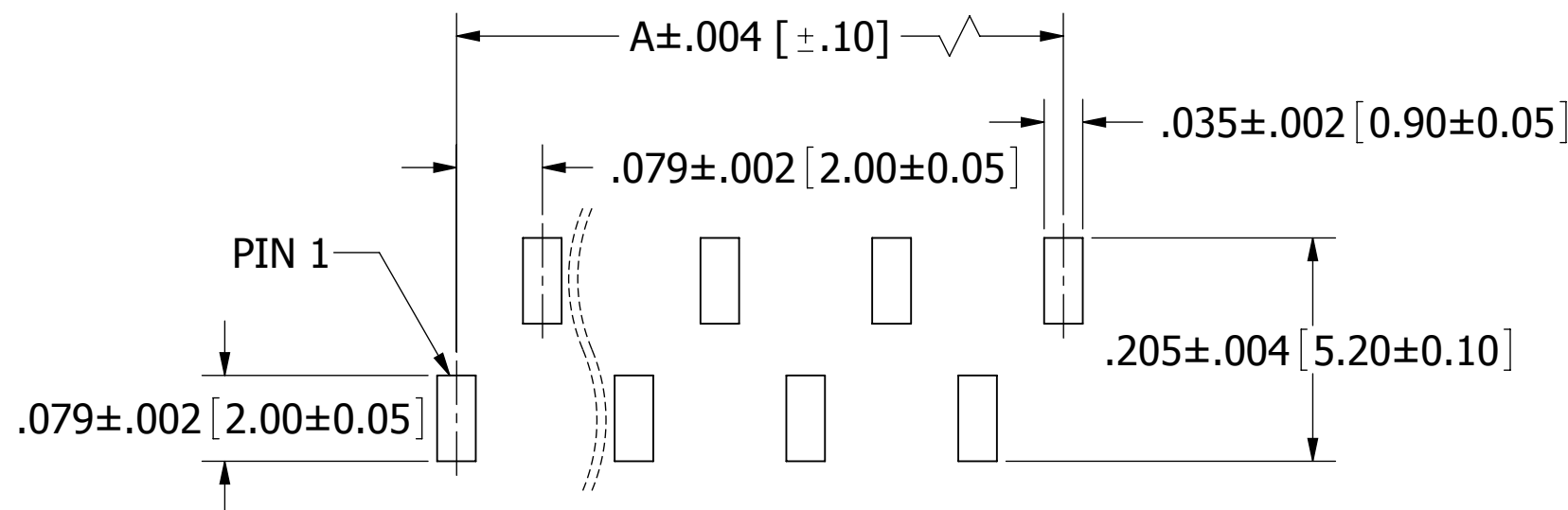

**RECOMMENDED PCB LAYOUT - FOR PN: xPxNxx1BFLD-RC**

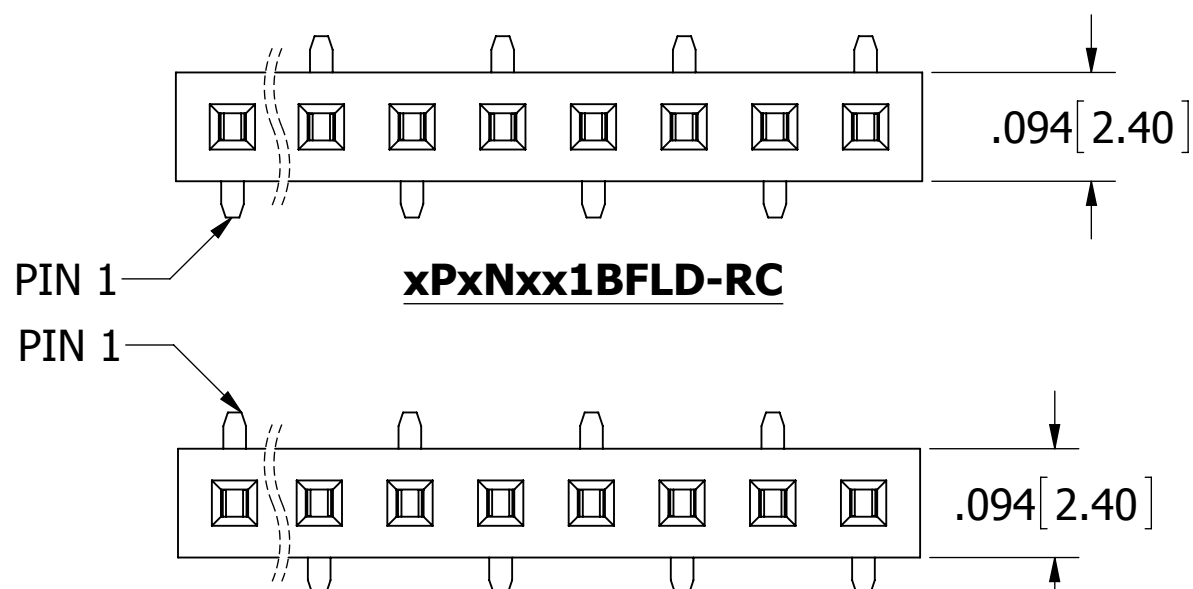

**xPxNxx1BFLD-RC**

**xPxNxx1BFLL-RC**

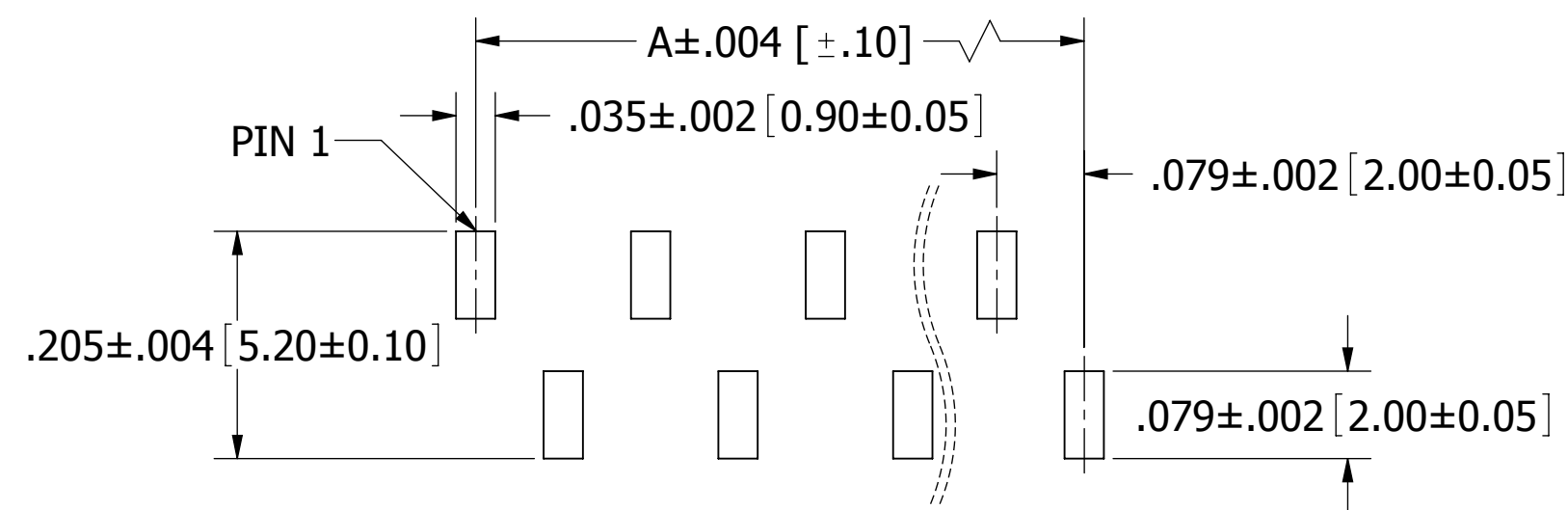

**RECOMMENDED PCB LAYOUT - FOR PN: xPxNxx1BFLL-RC**

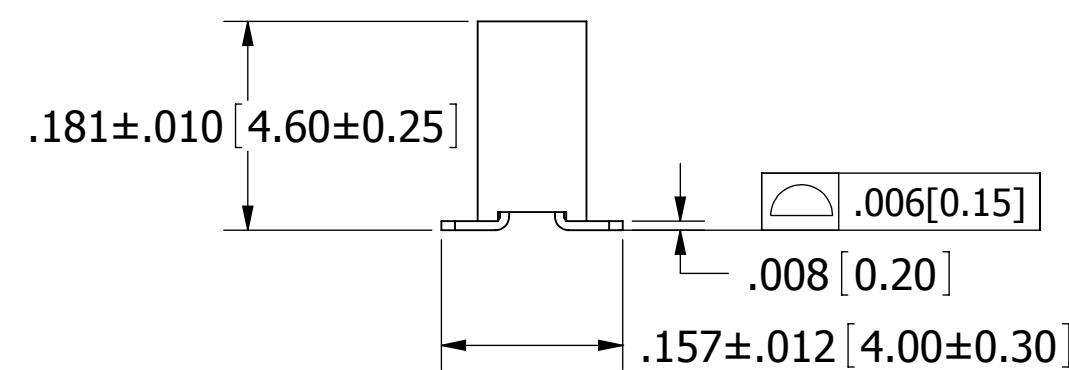
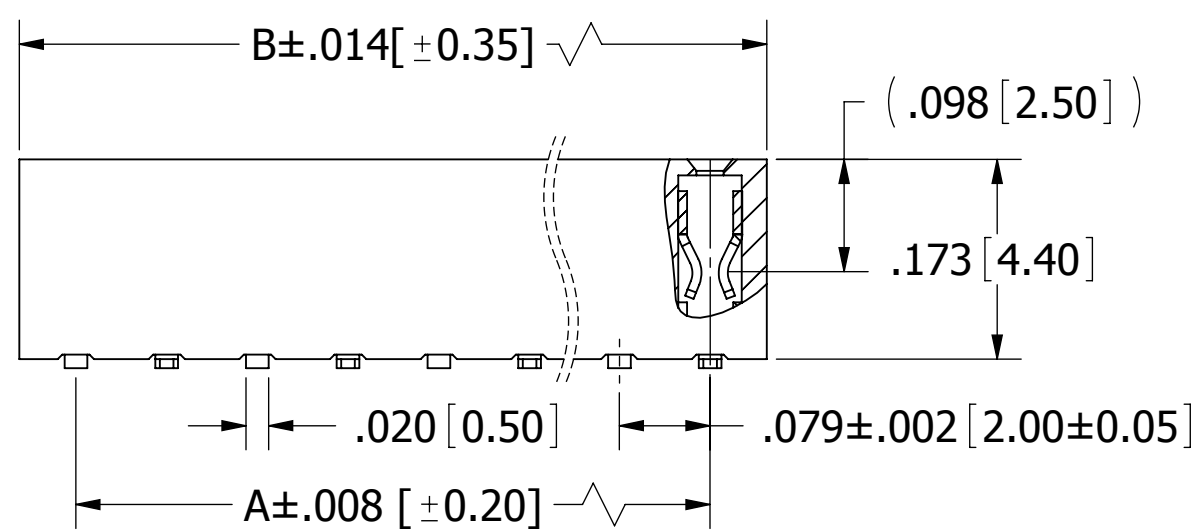

02-20, 0.20mm MAX.  
 21-40, 0.30mm MAX.

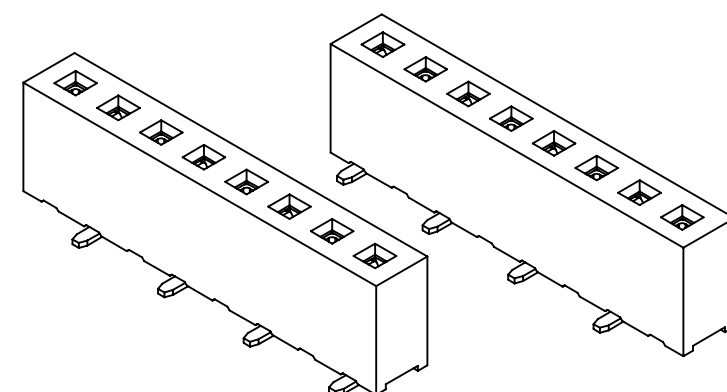

**NOTES:**

- INSULATOR MATERIAL: SEE PART NUMBER CODING
- CONTACT MATERIAL: PHOSPHOR BRONZE
- CONTACT PLATING: SEE PART NUMBER CODING
- CURRENT RATING: 2 AMPS
- VOLTAGE RAATING: 150 V AC/DC
- INSULATOR RESISTANCE: 1000 MEGOHMS MIN
- CONTACT RESISTANCE: 20 MILLIOHMS MAX
- DIELECTRIC WITHSTANDING: 500 VAC
- OPERATING TEMPERATURE: SEE PART NUMBER CODING
- PROCESSING TEMP. : SEE PART NUMBER CODING
- FOR ODD NUMBER POSITIONS, MOUNTING STYLES CAN BE EITHER 'C' OR 'D'
- MATES WITH SULLINS .079 [2.00] CONTACT CENTER MALE HEADER SERIES (.020 [0.50] SQUARE POSTS)

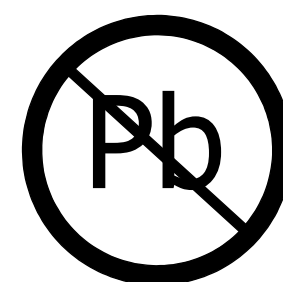

RoHS COMPLIANT

UNLESS OTHERWISE SPECIFIED: DIMENSIONS ARE IN INCHES [MM]	DRAWN	DATE	NAME	
		01/10/2009	JH	
TOLERANCES:	<small>THE INFORMATION HEREIN CONTAINS PROPRIETARY INFORMATION OF SULLINS ELECTRONICS AND IS NOT TO BE REPRODUCED, USED OR DISCLOSED TO OTHERS FOR ANY PURPOSE EXCEPT AS SPECIFICALLY AUTHORIZED IN WRITINGS BY AN OFFICER OF SULLINS ELECTRONICS.</small>			TITLE
ANGULAR: ± 5°				HEADER, FEMALE, 2mm CC, 1 ROW, SMT
DECIMALS				PART NUMBER
.X = ± .012 [.3]				xPxNxx1BFLx-RC
.XX = ± .008 [.20]	SIZE	CAGE CODE	DWG. NO.	REV
.XXX = ± .006 [.15]	C	54453	10489	F
	SCALE: 12:1	SHEET 1 OF 1		

## Looking for pricing, stock, or lifecycle information?

Click below to explore more details on WIN SOURCE:

-  [View NPPN061BFLD-RC on WIN SOURCE](#)
-  [Sullins Connector Solutions](#) Information

## Optimize Your Supply Chain with WIN SOURCE Solutions

-  Global Sourcing Solution
-  Obsolete Management
-  Cost Control Management
-  Shortage Management
-  Alternative Solution
-  Excess Inventory Management