

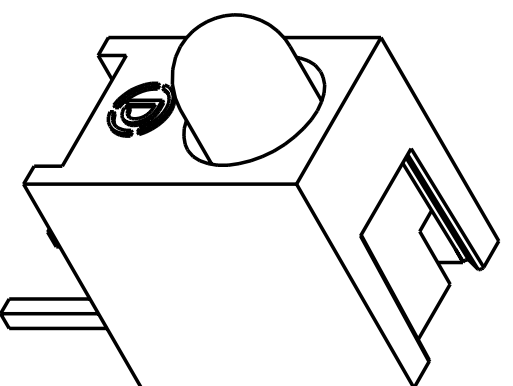

**THE DATASHEET OF
HLMP1300101F**

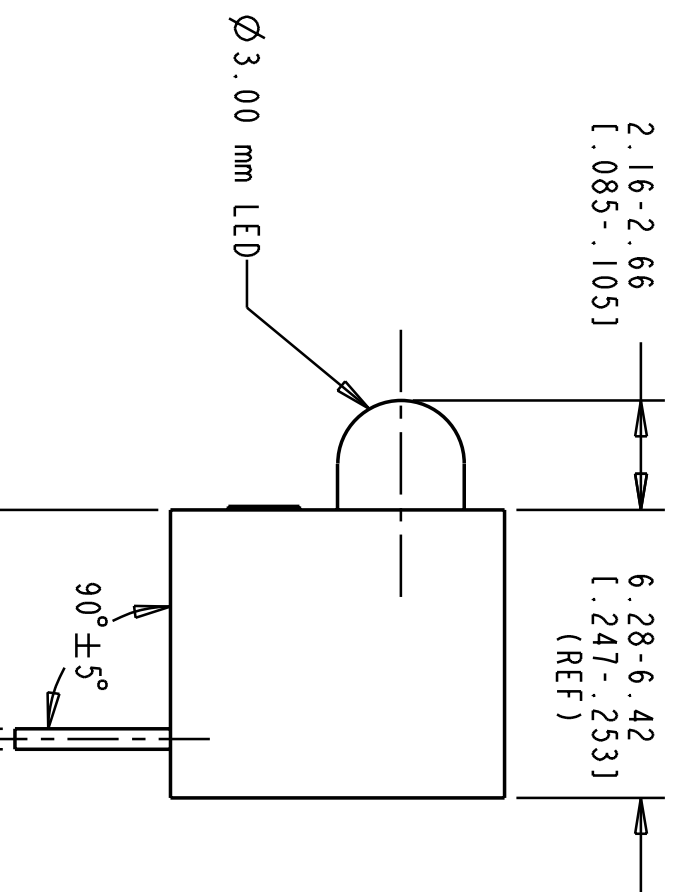

OPERATING CHARACTERISTICS @ TA = 25°C				MAXIMUM RATINGS						
V (V)	REVERSE VOLTAGE	PEAK WAVELENGTH (nm)	LUMINOUS INTENSITY (mcd)		TEST CONDITIONS	LINEAR DERATION	D.C. FORWARD CURRENT (mA)	OPERATING TEMPERATURE	STORAGE TEMPERATURE	LEAD SOLDERING TEMPERATURE
		TYP	MIN	TYP						
2.4	5 V @ Ir = 100 μA	635	8.6	13.8	If = 10 mA	0.5 mA/°C (FROM 50°C)	30	-55°C TO 100°C	-55°C TO 100°C	260°C FOR 5 SEC
2.4	5 V @ Ir = 100 μA	635	8.6	13.8	If = 10 mA	0.5 mA/°C (FROM 50°C)	30	-55°C TO 100°C	-55°C TO 100°C	
2.4	5 V @ Ir = 100 μA	635	8.6	13.8	If = 10 mA	0.5 mA/°C (FROM 50°C)	30	-55°C TO 100°C	-55°C TO 100°C	
3.0	5 V @ Ir = 100 μA	635	8.6	12.0	If = 10 mA	1.8 mW/°C (FROM 25°C)	30	-55°C TO 100°C	-55°C TO 100°C	
2.6	5 V @ Ir = 100 μA	635	35	45	If = 20 mA	—	30	-55°C TO 100°C	-55°C TO 100°C	
3.0	5 V @ Ir = 100 μA	635	6.0	10.0	If = 10 mA	1.8 mW/°C (FROM 25°C)	30	-55°C TO 100°C	-55°C TO 100°C	
2.4	5 V @ Ir = 100 μA	583	3.6	7.0	If = 10 mA	0.2 mA/°C (FROM 50°C)	20	-55°C TO 100°C	-55°C TO 100°C	
2.4	5 V @ Ir = 100 μA	583	3.6	7.0	If = 10 mA	0.2 mA/°C (FROM 50°C)	20	-55°C TO 100°C	-55°C TO 100°C	
2.4	5 V @ Ir = 100 μA	583	3.6	7.0	If = 10 mA	0.2 mA/°C (FROM 50°C)	20	-55°C TO 100°C	-55°C TO 100°C	
3.0	5 V @ Ir = 100 μA	583	6.0	12.0	If = 10 mA	1.6 mW/°C (FROM 50°C)	20	-55°C TO 100°C	-55°C TO 100°C	
2.6	5 V @ Ir = 100 μA	583	35	45	If = 20 mA	—	20	-55°C TO 100°C	-55°C TO 100°C	
3.0	5 V @ Ir = 100 μA	583	6.0	10.0	If = 10 mA	1.6 mW/°C (FROM 50°C)	20	-55°C TO 100°C	-55°C TO 100°C	
2.7	5 V @ Ir = 100 μA	565	2.6	7.0	If = 10 mA	0.5 mA/°C (FROM 50°C)	30	-20°C TO 100°C	-55°C TO 100°C	
2.7	5 V @ Ir = 100 μA	565	2.6	7.0	If = 10 mA	0.5 mA/°C (FROM 50°C)	30	-20°C TO 100°C	-55°C TO 100°C	
3.0	5 V @ Ir = 100 μA	565	2.6	12.0	If = 10 mA	1.8 mW/°C (FROM 25°C)	30	-20°C TO 100°C	-55°C TO 100°C	
2.7	5 V @ Ir = 100 μA	565	2.6	7.0	If = 10 mA	0.5 mA/°C (FROM 50°C)	30	-20°C TO 100°C	-55°C TO 100°C	
3.0	5 V @ Ir = 100 μA	565	35	45	If = 20 mA	—	30	-20°C TO 100°C	-55°C TO 100°C	
3.0	5 V @ Ir = 100 μA	565	4.0	8.5	If = 10 mA	1.8 mW/°C (FROM 25°C)	25	-20°C TO 100°C	-55°C TO 100°C	
T (mA)		D.C. FORWARD VOLTAGE (V)								
MAX										
15	5 V @ Ir = 100 μA	635	1.5	4.0	Vf = 5 V	0.071 V/°C (FROM 50°C)	7.5	-40°C TO 85°C	-55°C TO 100°C	
15	5 V @ Ir = 100 μA	583	2.0	8.0	Vf = 5 V	—	7.5	-40°C TO 85°C	-55°C TO 100°C	
15	5 V @ Ir = 100 μA	565	2.0	8.0	Vf = 5 V	—	7.5	-20°C TO 85°C	-55°C TO 100°C	
MAX										
D.C. FORWARD CURRENT (mA)										
2.2	5 V @ Ir = 50 μA	635	1.0	1.8	If = 2 mA	—	7	-55°C TO 100°C	-55°C TO 100°C	
2.7	5 V @ Ir = 50 μA	583	1.0	1.6	If = 2 mA	—	7	-55°C TO 100°C	-55°C TO 100°C	
2.2	5 V @ Ir = 50 μA	565	1.0	1.6	If = 2 mA	—	7	-20°C TO 100°C	-55°C TO 100°C	
1.8	5 V @ Ir = 100 μA	645	1.3	2.0	If = 1 mA	—	30	-20°C TO 100°C	-55°C TO 100°C	
2.2	5 V @ Ir = 100 μA	645	22	45	If = 20 mA	—	30	-20°C TO 100°C	-55°C TO 100°C	



REV.	ECN NO.	REVISIONS	DRN.	CKD.	APP.	DATE
A	—	NEW RELEASE	M. C.			

THIS DRAWING AND THE CONTENTS HEREIN ARE CONFIDENTIAL AND THE SOLE PROPERTY OF DIALIGHT. REPRODUCTION OF THIS DRAWING OR CONSTRUCTION OF ANY PARTS WITHIN THIS DRAWING ARE FORBIDDEN WITHOUT THE WRITTEN CONSENT OF DIALIGHT.

DRAWING NUMBER		REV	
C-16478		A	
TITLE		MATERIAL	
Ø 3.00 mm CBI ARRAY			
FINISH:		DRAWING NUMBER	
FSCM 83330		C-16478	
SHEET		REV	
OF		A	
FAMILY TABLES:		DRAWING NUMBER	
		C-16478	
		REV	
		A	
		MATERIAL	
		Ø 3.00 mm CBI ARRAY	
		DRAWING NUMBER	
		C-16478	
		REV	
		A	
		MATERIAL	
		Ø 3.00 mm CBI ARRAY	
		DRAWING NUMBER	
		C-16478	
		REV	
		A	
		MATERIAL	
		Ø 3.00 mm CBI ARRAY	
		DRAWING NUMBER	
		C-16478	
		REV	
		A	
		MATERIAL	
		Ø 3.00 mm CBI ARRAY	
		DRAWING NUMBER	
		C-16478	
		REV	
		A	
		MATERIAL	
		Ø 3.00 mm CBI ARRAY	
		DRAWING NUMBER	
		C-16478	
		REV	
		A	
		MATERIAL	
		Ø 3.00 mm CBI ARRAY	
		DRAWING NUMBER	
		C-16478	
		REV	
		A	
		MATERIAL	
		Ø 3.00 mm CBI ARRAY	
		DRAWING NUMBER	
		C-16478	
		REV	
		A	
		MATERIAL	
		Ø 3.00 mm CBI ARRAY	
		DRAWING NUMBER	
		C-16478	
		REV	
		A	
		MATERIAL	
		Ø 3.00 mm CBI ARRAY	
		DRAWING NUMBER	
		C-16478	
		REV	
		A	
		MATERIAL	
		Ø 3.00 mm CBI ARRAY	
		DRAWING NUMBER	
		C-16478	
		REV	
		A	
		MATERIAL	
		Ø 3.00 mm CBI ARRAY	
		DRAWING NUMBER	
		C-16478	
		REV	
		A	
		MATERIAL	
		Ø 3.00 mm CBI ARRAY	
		DRAWING NUMBER	
		C-16478	
		REV	
		A	
		MATERIAL	
		Ø 3.00 mm CBI ARRAY	
		DRAWING NUMBER	
		C-16478	
		REV	
		A	
		MATERIAL	
		Ø 3.00 mm CBI ARRAY	
		DRAWING NUMBER	
		C-16478	
		REV	
		A	
		MATERIAL	
		Ø 3.00 mm CBI ARRAY	
		DRAWING NUMBER	
		C-16478	
		REV	
		A	
		MATERIAL	
		Ø 3.00 mm CBI ARRAY	
		DRAWING NUMBER	
		C-16478	
		REV	
		A	
		MATERIAL	
		Ø 3.00 mm CBI ARRAY	
		DRAWING NUMBER	
		C-16478	
		REV	
		A	
		MATERIAL	
		Ø 3.00 mm CBI ARRAY	
		DRAWING NUMBER	
		C-16478	
		REV	
		A	
		MATERIAL	
		Ø 3.00 mm CBI ARRAY	
		DRAWING NUMBER	
		C-16478	
		REV	
		A	
		MATERIAL	
		Ø 3.00 mm CBI ARRAY	
		DRAWING NUMBER	
		C-16478	
		REV	
		A	
		MATERIAL	
		Ø 3.00 mm CBI ARRAY	
		DRAWING NUMBER	
		C-16478	
		REV	
		A	
		MATERIAL	
		Ø 3.00 mm CBI ARRAY	
		DRAWING NUMBER	
		C-16478	
		REV	
		A	
		MATERIAL	
		Ø 3.00 mm CBI ARRAY	
		DRAWING NUMBER	
		C-16478	
		REV	
		A	
		MATERIAL	
		Ø 3.00 mm CBI ARRAY	
		DRAWING NUMBER	
		C-16478	
		REV	
		A	
		MATERIAL	
		Ø 3.00 mm CBI ARRAY	
		DRAWING NUMBER	
		C-16478	
		REV	
		A	
		MATERIAL	
		Ø 3.00 mm CBI ARRAY	
		DRAWING NUMBER	
		C-16478	
		REV	
		A	
		MATERIAL	
		Ø 3.00 mm CBI ARRAY	
		DRAWING NUMBER	
		C-16478	
		REV	
		A	
		MATERIAL	
		Ø 3.00 mm CBI ARRAY	
		DRAWING NUMBER	
		C-16478	
		REV	
		A	
		MATERIAL	
		Ø 3.00 mm CBI ARRAY	
		DRAWING NUMBER	
		C-16478	
		REV	
		A	
		MATERIAL	
		Ø 3.00 mm CBI ARRAY	
		DRAWING NUMBER	
		C-16478	
		REV	
		A	
		MATERIAL	
		Ø 3.00 mm CBI ARRAY	
		DRAWING NUMBER	
		C-16478	
		REV	
		A	
		MATERIAL	
		Ø 3.00 mm CBI ARRAY	
		DRAWING NUMBER	
		C-16478	
		REV	
		A	
		MATERIAL	
		Ø 3.00 mm CBI ARRAY	
		DRAWING NUMBER	
		C-16478	
		REV	
		A	
		MATERIAL	
		Ø 3.00 mm CBI ARRAY	
		DRAWING NUMBER	
		C-16478	
		REV	
		A	
		MATERIAL	
		Ø 3.00 mm CBI ARRAY	
		DRAWING NUMBER	
		C-16478	
		REV	
		A	
		MATERIAL	
		Ø 3.00 mm CBI ARRAY	
		DRAWING NUMBER	
		C-16478	
		REV	
		A	
		MATERIAL	
		Ø 3.00 mm CBI ARRAY	
		DRAWING NUMBER	
		C-16478	
		REV	
		A	
		MATERIAL	
		Ø 3.00 mm CBI ARRAY	
		DRAWING NUMBER	
		C-16478	
		REV	
		A	
		MATERIAL	
		Ø 3.00 mm CBI ARRAY	
		DRAWING NUMBER	
		C-16478	
		REV	
		A	
		MATERIAL	
		Ø 3.00 mm CBI ARRAY	
		DRAWING NUMBER	
		C-16478	
		REV	
		A	
		MATERIAL	
		Ø 3.00 mm CBI ARRAY	
		DRAWING NUMBER	
		C-16478	
		REV	
		A	
		MATERIAL	
		Ø 3.00 mm CBI ARRAY	
		DRAWING NUMBER	
		C-16478	
		REV	
		A	
		MATERIAL	
		Ø 3.00 mm CBI ARRAY	
		DRAWING NUMBER	
		C-16478	
		REV	
		A	
		MATERIAL	
		Ø 3.00 mm CBI ARRAY	
		DRAWING NUMBER	
		C-16478	
		REV	
		A	
		MATERIAL	
		Ø 3.00 mm CBI ARRAY	
		DRAWING NUMBER	
		C-16478	
		REV	
		A	
		MATERIAL	
		Ø 3.00 mm CBI ARRAY	
		DRAWING NUMBER	
		C-16478	
		REV	
		A	
		MATERIAL	
		Ø	

Looking for pricing, stock, or lifecycle information?

Click below to explore more details on WIN SOURCE:

[View HLMP1300101F on WIN SOURCE](#)

[Dialight Information](#)

Optimize Your Supply Chain with WIN SOURCE Solutions

- ✓ Global Sourcing Solution
- ✓ Obsolete Management
- ✓ Cost Control Management
- ✓ Shortage Management
- ✓ Alternative Solution
- ✓ Excess Inventory Management