

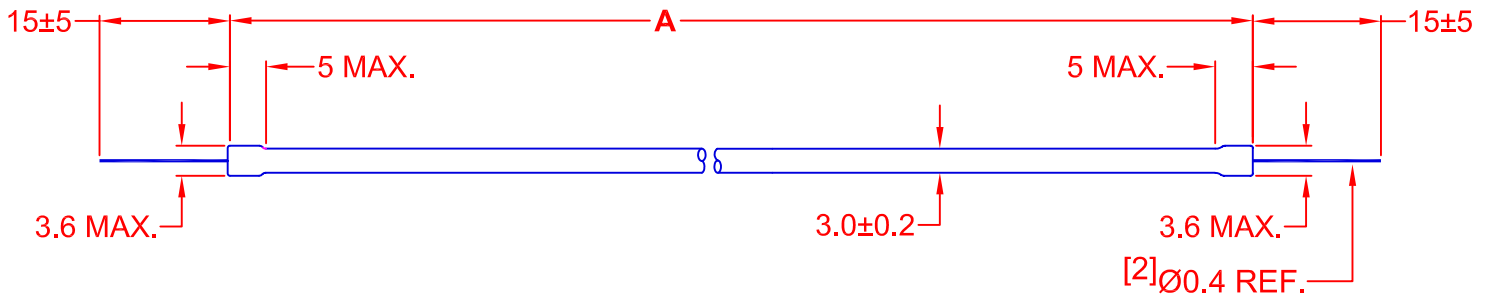

**THE DATASHEET OF
BF3216-20B**







JKL PART NUMBER	- A - LENGTH	COLOR	STARTING CIRCUIT VOLTAGE VS (Vrms) @ 0°C TYP.	OPERATING LAMP VOLTAGE VL (Vrms) TYP.	OPERATING LAMP CURRENT IL (mA rms)	BRIGHTNESS (CANDELA/m ²) TYPICAL	*RATED LIFE (HRS) AVERAGE
BF350-20B	50 +/- 2.0	RGB HIGH OUTPUT WHITE 5400° KELVIN (REF.) x = .340 y = .360	425	170	5 ± 1	31,000	40,000
BF375-20B	75 +/- 2.0		515	205	5 ± 1	31,000	40,000
BF386-20B	86 +/- 2.0		540	215	5 ± 1	31,000	40,000
BF3100-20B	100 +/- 2.0		640	255	5 ± 1	31,000	40,000
BF3115-20B	115 +/- 2.0		725	290	5 ± 1	31,000	40,000
BF3130-20B	130 +/- 2.0		775	310	5 ± 1	31,000	40,000
BF3160-20B	160 +/- 2.0		900	360	5 ± 1	31,000	40,000
BF3180-20B	180 +/- 2.0		950	380	5 ± 1	31,000	40,000
BF3216-20B	216 +/- 2.0		1125	450	5 ± 1	31,000	40,000
BF3240-20B	240 +/- 2.0		1240	495	5 ± 1	31,000	40,000
BF3250-20B	250 +/- 2.0		1300	520	5 ± 1	31,000	40,000
BF3275-20B	275 +/- 2.0		1475	590	5 ± 1	31,000	40,000
BF3300-20B	300 +/- 1.5		1625	650	5 ± 1	31,000	40,000
BF3360-20B	360 +/- 2.0		1850	740	5 ± 1	31,000	40,000
BF3380-20B	380 +/- 2.0		1975	790	5 ± 1	31,000	40,000

*NOTE: RATED LIFE IS DEFINED AS THE POINT AT WHICH THE INTENSITY BECOMES 50% OF THE INITIAL RATING.

J	CHNG LEAD LTH & BRIGHTNESS TO 31,000 TYP	12/30/09	METRIC THIRD ANGLE PROJECTION	DIMENSIONS ARE IN MILLIMETERS TOLERANCE UNLESS OTHERWISE SPECIFIED 1 PL +/- 0.2 2 PL +/- 0.20 ANGLE +/- 0	 JKL COMPONENTS CORPORATION	TITLE MINIATURE COLD CATHODE FLUORESCENT LAMP						
I	CHANGE LEAD LENGTH TOLERANCE	3/24/08										
H	CHANGE BF3300-20B LENGTH TOLERANCE	2/3/06										
G	ELECTRICAL MODIFICATIONS	8/5/04										
F	ADD PART NUMBER BF3115-20B	12/19/02										
E	ADD PART NUMBER BF3180-20B & BF3380-20B	11/30/01										
D	ADD PART NUMBER BF3240-20B	4/26/01										
C	ADD PART NUMBER BF3130-20B	9/11/00										
B	ADD PART NUMBER BF375-20B	4/21/00										
A	LENGTH ±5 TO ±2	2/25/00										
RELEASED - CANCEL BF-3mm DIA DRAWING			2/21/00	DRAWN BY L. WENGSTROM	APPVD BY L.R.	DATE 12/30/09						
REV. NO.	DESCRIPTION/ECO NUMBER	APPVD DATE	- CAD DRAWING - MANUAL REVISIONS NOT PERMITTED		SIZE A	FSCM NO. 55335	DRAWING NO. BF 3-20B	SCALE NONE	RELEASED DATE 2/21/00	REVISION DATE 12/30/09	REV. NO. J	SHEET 1 OF 1

Looking for pricing, stock, or lifecycle information?

Click below to explore more details on WIN SOURCE:

-  [View BF3216-20B on WIN SOURCE](#)
-  [JKL Components Corp. Information](#)

Optimize Your Supply Chain with WIN SOURCE Solutions

-  Global Sourcing Solution
-  Obsolete Management
-  Cost Control Management
-  Shortage Management
-  Alternative Solution
-  Excess Inventory Management