



# THE DATASHEET OF BMK80000



## MODEL BMK8 - BASE MOUNT KIT FOR CUB7



### DESCRIPTION

The BMK8 base mount is designed for use with the CUB7 series products. Wire feed to the CUB7 unit may be through the existing panel/frame or through the hole in the BMK8 itself.

The base mount is constructed of steel with a textured black finish and includes four mounting bolts and nuts.

### DIMENSIONS In inches (mm)

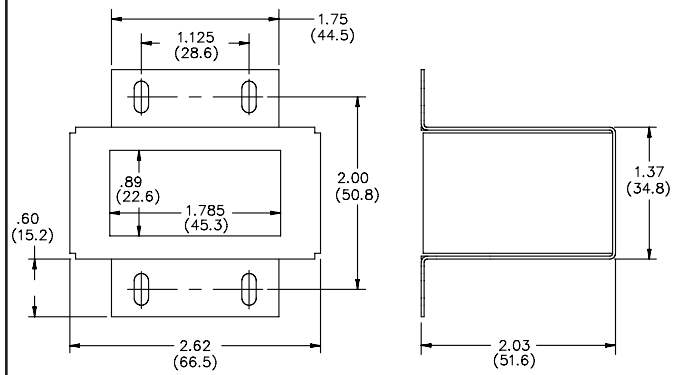

### ORDERING INFORMATION

MODEL NO.	DESCRIPTION	PART NUMBER
BMK8	CUB7 BASE MOUNT KIT	BMK80000

For More information on Pricing, Enclosures & Panel Mount Kits refer to the RLC Catalog or contact your local RLC Distributor.

### INSTALLATION

1. Mark and drill holes (5/32") in existing panel using the BMK8 as a template. An addition hole may be cut in the existing panel for wire feed.
2. Remove the panel latch (mounting clip) from the CUB7 unit and insert the mounting screws (supplied with the CUB7) on both sides of panel latch. The tip of the screw should not project from the hole in the panel latch (mounting clip).
3. Slide the CUB7 through the cut out in the BMK8 until the bezel flange contacts the base mount. The CUB7 panel gasket is optional.
4. Slide the panel latch (mounting clip) over the rear of the unit and towards the front of the unit until it latches firmly against the inside of the base mount. Note: It is necessary to hold the CUB7 in place when sliding the mounting clip into position.
5. Alternately tighten mounting screws.
6. Route wires through existing panel wire hole or through wire hole on base mount and connect to the appropriate terminals on the CUB7.
7. Mount the CUB7/base mount assembly to the existing panel or frame utilizing the four bolts and nuts provided with the base mount.

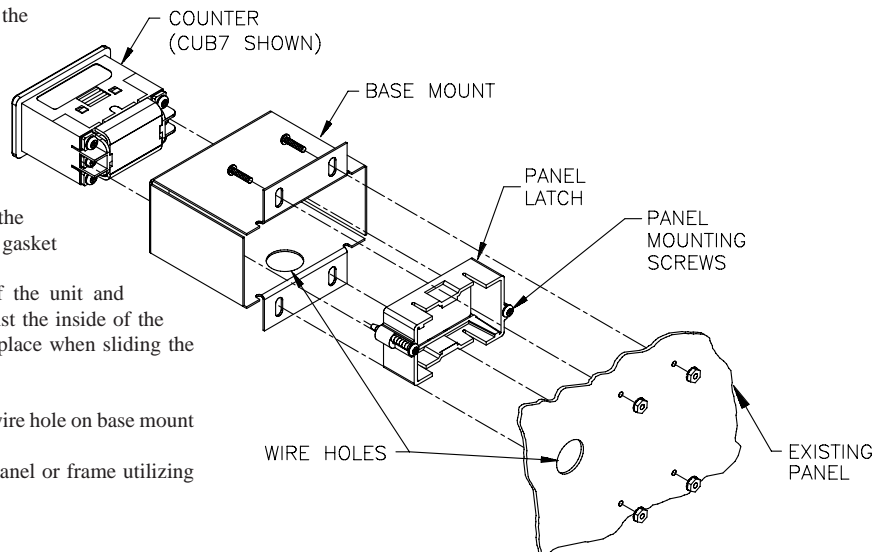

## Looking for pricing, stock, or lifecycle information?

Click below to explore more details on WIN SOURCE:

 [View BMK80000 on WIN SOURCE](#)

 [Red Lion Controls Information](#)

## Optimize Your Supply Chain with WIN SOURCE Solutions

-  Global Sourcing Solution
-  Obsolete Management
-  Cost Control Management
-  Shortage Management
-  Alternative Solution
-  Excess Inventory Management