



**THE DATASHEET OF
CDRH127/LD-151MC**



NEW

CDRH127

OUTLINE

Thinner core diameter and thicker wire diameter enables CDRH127/LD to be lower D.C.R than CDRH127.

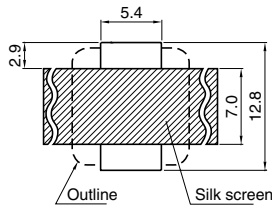
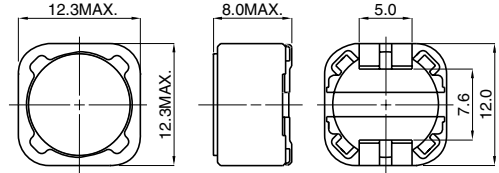
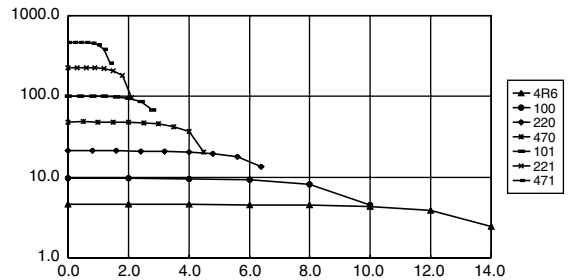
LAND PATTERNS (mm)

DIMENSIONS (mm)

SATURATION CURRENT

SPECIFICATIONS

Parts No.	Stamp	Inductance <WITHIN>*1 (at 100kHz)	D.C.R.(mΩ)<MAX.> (at 20°C)*2	Rated Current (A) *3
CDRH127/LD-1R0NC	1R0	1.0μH±20%	6.5m(5.0m)	14.0
CDRH127/LD-2R4NC	2R4	2.4μH±20%	10.5m(8.1m)	10.3
CDRH127/LD-3R5NC	3R5	3.5μH±20%	12.4m(9.5m)	9.30
CDRH127/LD-4R6NC	4R6	4.6μH±20%	13.8m(10.6m)	9.10
CDRH127/LD-5R8NC	5R8	5.8μH±20%	16.2m(12.4m)	8.60
CDRH127/LD-7R4NC	7R4	7.4μH±20%	17.7m(13.6m)	7.40
CDRH127/LD-100NC	100	10.0μH±20%	19.5m(15.0m)	6.70
CDRH127/LD-120NC	120	12.0μH±20%	21.3m(16.4m)	6.45
CDRH127/LD-150NC	150	15.0μH±20%	26.4m(20.3m)	5.65
CDRH127/LD-180NC	180	18.0μH±20%	28.0m(21.5m)	5.10
CDRH127/LD-220NC	220	22.0μH±20%	36.4m(28.0m)	4.70
CDRH127/LD-270NC	270	27.0μH±20%	41.6m(32.0m)	4.20
CDRH127/LD-330NC	330	33.0μH±20%	53.3m(41.0m)	3.90
CDRH127/LD-390NC	390	39.0μH±20%	60.5m(46.5m)	3.50
CDRH127/LD-470NC	470	47.0μH±20%	78.0m(60.0m)	3.25
CDRH127/LD-560NC	560	56.0μH±20%	90.0m(69.0m)	2.90
CDRH127/LD-680NC	680	68.0μH±20%	120.0m(92.0m)	2.60
CDRH127/LD-820NC	820	82.0μH±20%	119.0m(91.0m)	2.40
CDRH127/LD-101NC	101	100.0μH±20%	151.0m (119m)	2.10
CDRH127/LD-121NC	121	120.0μH±20%	169.0m (130m)	1.90
CDRH127/LD-151NC	151	150.0μH±20%	227.0m (174m)	1.80
CDRH127/LD-181NC	181	180.0μH±20%	299.0m (230m)	1.55
CDRH127/LD-221NC	221	220.0μH±20%	338.0m (260m)	1.45
CDRH127/LD-271NC	271	270.0μH±20%	419.0m (322m)	1.30
CDRH127/LD-331NC	331	330.0μH±20%	471.0m (362m)	1.20
CDRH127/LD-391NC	391	390.0μH±20%	572.0m (440m)	1.10
CDRH127/LD-471NC	471	470.0μH±20%	741.0m (570m)	1.00
CDRH127/LD-561NC	561	560.0μH±20%	852.0m (655m)	0.95
CDRH127/LD-681NC	681	680.0μH±20%	1.13 (870m)	0.85
CDRH127/LD-821NC	821	820.0μH±20%	1.24 (950m)	0.75
CDRH127/LD-102NC	102	1.0mH±20%	1.50 (1.15)	0.70

*1: Measurement frequency of inductance : 1.0μH - 7.4μH at 100kHz, 10μH - 1mH at 1kHz

*2: () is typical value.

*3: Rated Current : It indicates the D.C. current value when inductance value become more than 75% of the nominal one, or D.C. current when temperature rise is Δt=40°C (Ta=20°C), whichever is lower.

Sales Contact
North America
 1701 Golf Road, Tower 3
 Suite 400, Rolling
 Meadows, IL 60008, USA
 Tel: (1) 847 545-6700
 Fax: (1) 847 545-6720

Japan
 Nihonbashi- ingyocho
 2-Chome, Chuo-ku,
 Tokyo, Japan
 Tel: (81) 03 3667-3301
 Fax: (81) 03 3667-3456

Hong Kong
 14/F, Eastern Centre,
 1065 King's Road, Quarry
 Road, Hong Kong
 Tel: (852) 2880-6688
 Fax: (852) 2880-9596

Taiwan
 No. 171, Futech Street,
 Hsin-I, Taipei, Taiwan,
 ROC
 Tel: (886) 2 2726-2177
 Fax: (886) 2 2728-2726

Singapore
 996 Bendemeer
 Road #04-05 to 06
 Singapore 339944
 Tel: (65) 2963-388
 Fax: (65) 2963-390

Europe
 Chaussee de Tervuren113A,
 1160 Brussels
 Belgium
 Email:
 europe.sales@hk.sumida.com

Looking for pricing, stock, or lifecycle information?

Click below to explore more details on WIN SOURCE:

- ⊖ [View CDRH127/LD-151MC on WIN SOURCE](#)
- ⊖ [Sumida America Components Inc. Information](#)

Optimize Your Supply Chain with WIN SOURCE Solutions

- ✓ Global Sourcing Solution
- ✓ Obsolete Management
- ✓ Cost Control Management
- ✓ Shortage Management
- ✓ Alternative Solution
- ✓ Excess Inventory Management